

TECH TIP

CENTRAL DRIVE SHAFT

In rare situations it may happen under extreme chassis flex, especially when not using rear chassis brace, that a central drive shaft may disconnect from the shaft adapter. Always use the rear chassis brace to minimize chance that the central drive shaft will disconnect under extreme chassis flex and you may add #962050 Washer 5x10x1mm under the shaft adapter.

1



#353089 Composite Rear Brace - V2

2

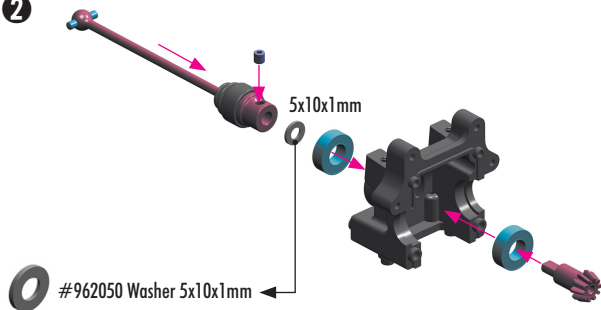

If you have any questions, please do not hesitate to contact XRAY at info@teamxray.com or visit our website at www.teamxray.com for news and updates.