

# XRAY XB2

## #325000 Adjustable Ball Differential - Set - HUDY Spring Steel™

The adjustable ball differential is factory pre-assembled. However, before using it, it must be broken in properly. For more information, see the last step on the last page of the Instruction Manual.

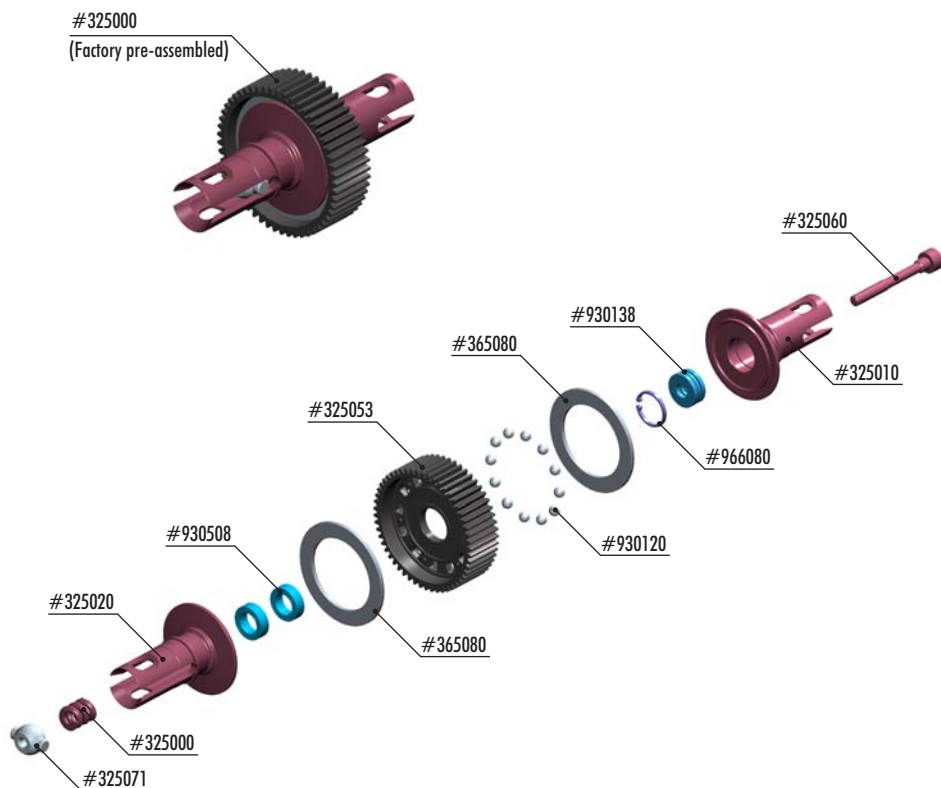

32 5010	BALL DIFF SHORT OUTPUT SHAFT - HUDY SPRING STEEL™
32 5020	BALL DIFF LONG OUTPUT SHAFT - HUDY SPRING STEEL™
32 5053	COMPOSITE BALL DIFFERENTIAL GEAR 53T
32 5060	SCREW FOR BALL DIFF ADJUSTMENT - SPRING STEEL™
32 5071	ALU BALL DIFFERENTIAL NUT
36 5080	DIFF WASHER 17 x 24.5 x 1 (2)

93 0120	CARBIDE BALL 2.4MM FOR BALL DIFF (12)
93 0138	CARBIDE BALL-BEARING AXIAL F3-8 3x8x3.5 - V2
93 0508	BALL-BEARING 5x8x2.5 (2)
96 6080	CH-CLIP 8 (10)



930138  
BA 3x8x3.5

**!** NOTE ORIENTATION

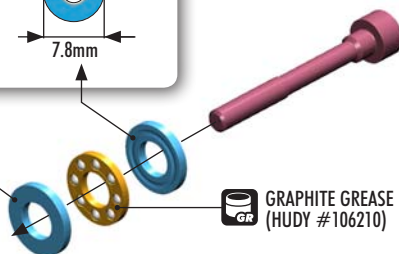
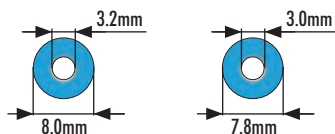

 GRAPHITE GREASE  
(HUDY #106210)

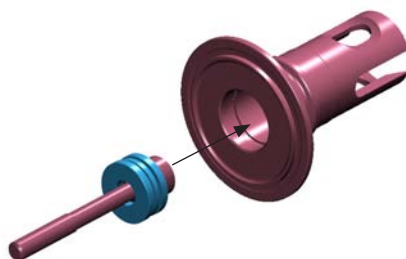

966080  
C 8

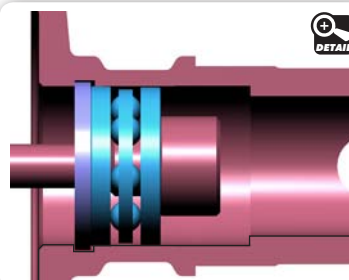
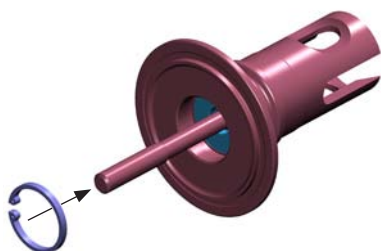

**+**  
DETAIL

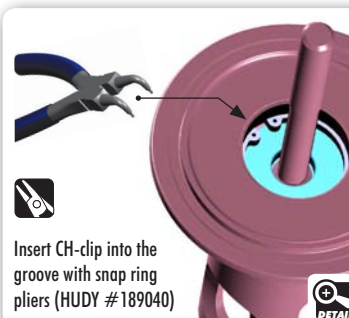

Insert CH-clip into the  
groove with snap ring  
pliers (HUDY #189040)

**+**  
DETAIL



930508  
BB 5x8x2.5

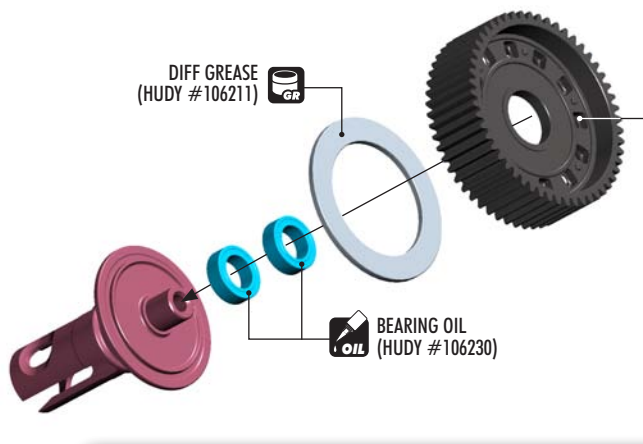

NOTE ORIENTATION



Square shape orientation  
on TOP side.



Round shape orientation  
on BOTTOM side.

CUTAWAY VIEW

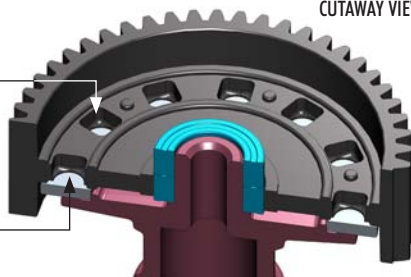

930120  
B 2.4

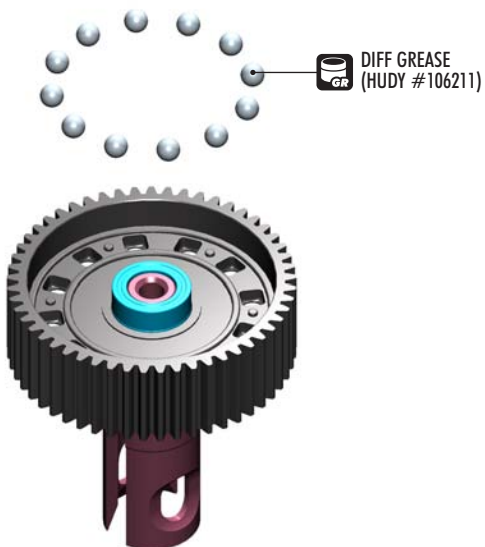

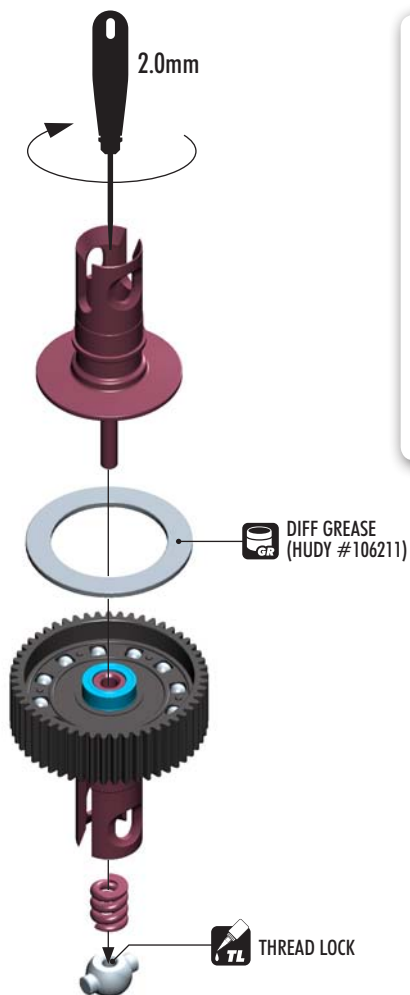

**! IMPORTANT:** When you build the differential, do not tighten it fully initially; the differential needs to be broken in properly. When you build the diff tighten it very gently. When you put the diff in the car and complete the assembly, run the car for a few minutes, tighten the diff a little bit, and then recheck the diff. Repeat this process several times until you have the diff tightened to the point you want it. Final adjustments should ALWAYS be made with the diff in the car and on the track.

To access the diff when it is installed in the car, you need to remove the camber linkage on the side from which the diff screw is installed. This will detach the suspension. Then use a 2mm hex wrench to adjust the diff.

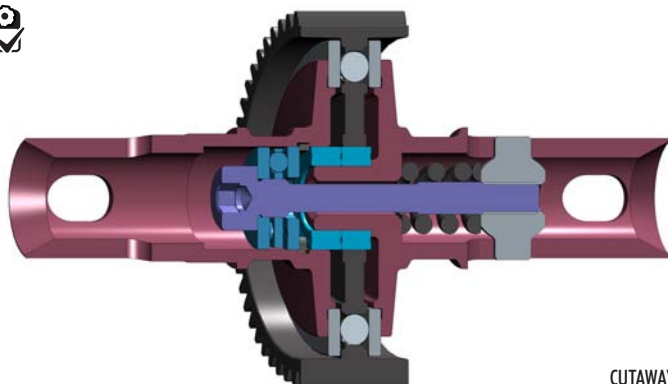

CUTAWAY VIEW