

# XRAY XB2

## #320901 XRAY XB2 Team Update for Carpet

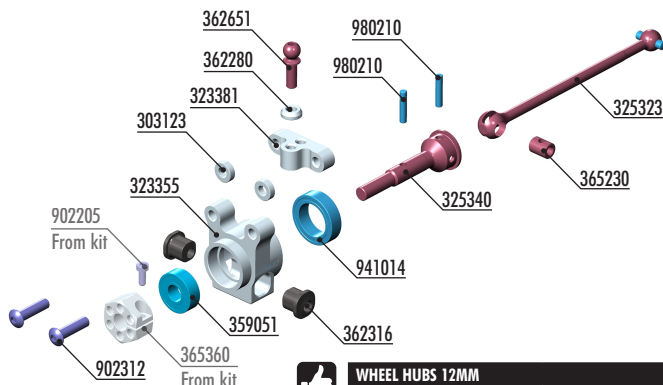

### WHEEL HUBS 12MM

#	Size	Slots	Option
#365360	+4.5mm	- 6 slots	INCLUDED in XB2C'18
#365359	+3.75mm	- 5 slots	OPTION
#365358	+3.0mm	- 4 slots	OPTION
#365357	+2.25mm	- 3 slots	OPTION
#365356	+1.5mm	- 2 slots	OPTION
#365355	+0.75mm	- 1 slot	OPTION
#365353	0mm	- 0 slots	OPTION
#365354	-0.75mm	- Lightw.	OPTION

30 3123	ALU SHIM 3X6X2.0MM (10)
32 3355	ALU MULTI ADJUSTABLE REAR UPRIGHT - SWISS 7075 T6
32 3381	ALU REAR HUB PLATE - SWISS 7075 T6
32 5323	REAR DRIVE SHAFT 71MM WITH 2.5MM PIN - HUDY SPRING STEEL™
32 5340	REAR DRIVE AXLE - HUDY SPRING STEEL™
36 2280	ALU CONICAL SHIM 3X6X2.0MM (10)
36 2316	ECCENTRIC BUSHING SET - OPEN (2)
36 2651	BALL END 4.9MM WITH THREAD 8MM (2)
36 5230	DRIVE SHAFT COUPLING - HUDY SPRING STEEL™
35 9051	BALL-BEARING 5X12X4 (2)
90 2312	HEX SCREW SH M3X12 (10)
94 1014	HIGH-SPEED BALL-BEARING 10X15X4 RUBBER SEALED (2)
98 0210	PIN 2X9.8 (10)