

#374901 XRAY Gear Differential 1/10 Formula - Set

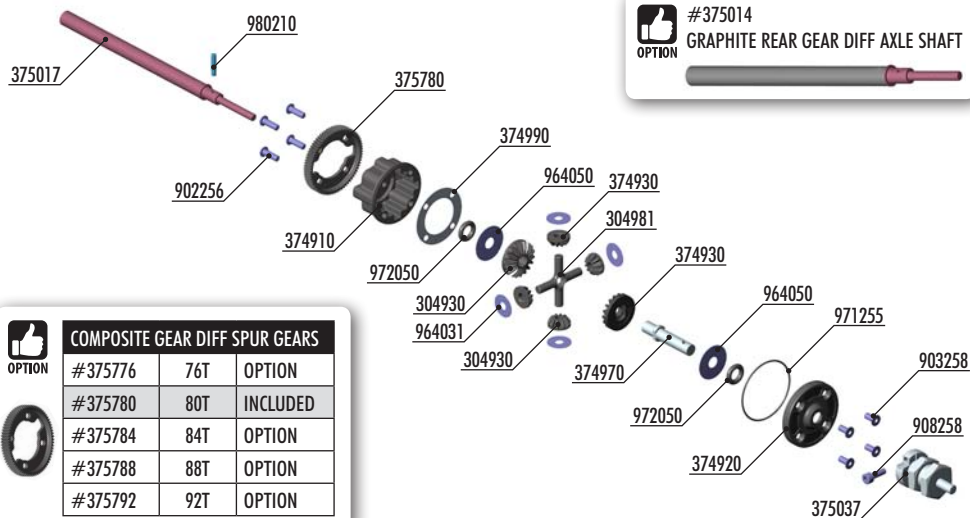

#375014

GRAPHITE REAR GEAR DIFF AXLE SHAFT



OPTION

COMPOSITE GEAR DIFF SPUR GEARS

#375776	76T	OPTION
#375780	80T	INCLUDED
#375784	84T	OPTION
#375788	88T	OPTION
#375792	92T	OPTION



30 4930	COMPOSITE GEAR DIFF BEVEL & SATELLITE GEARS (2+4)
30 4981	COMPOSITE GEAR DIFF CROSS PIN WITH HOLE
37 4901	XRAY GEAR DIFFERENTIAL 1/10 FORMULA - SET
37 4910	COMPOSITE GEAR DIFFERENTIAL CASE - GRAPHITE
37 4920	COMPOSITE GEAR DIFFERENTIAL COVER - GRAPHITE
37 4930	COMPOSITE GEAR DIFF BEVEL & SATELLITE GEARS (2+4)
37 4970	ALU GEAR DIFF SHAFT - SWISS 7075 T6
37 4990	DIFF GASKET (4)
37 5017	REAR GEAR DIFF AXLE SHAFT - HUDY SPRING STEEL™
37 5037	X1 ALU GEAR DIFF REAR WHEEL HUB - SWISS 7075 T6

37 5780 COMPOSITE GEAR DIFF SPUR GEAR - 80T / 64P

90 2256	HEX SCREW SH M2.5x6 (10)
90 3258	HEX SCREW SFH M2.5x8 (10)
90 8258	HEX SCREW SOCKET HEAD CAP M2.5x8 (10)
96 4031	WASHER S 3.5x10x0.2 (10)
96 4050	WASHER S 5x15x0.3 (10)
97 1255	SILICONE O-RING 25.5x0.7 (10)
97 2050	SILICONE O-RING 5x2 (10)
98 0210	PIN 2x9.8 (10)



964050
S 5x15x0.3



972050
0.5x2

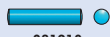

981210
P 2x10

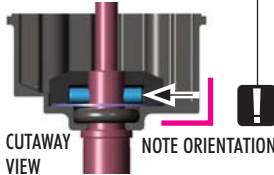
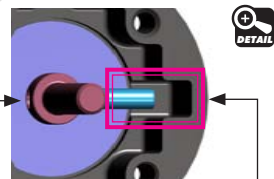
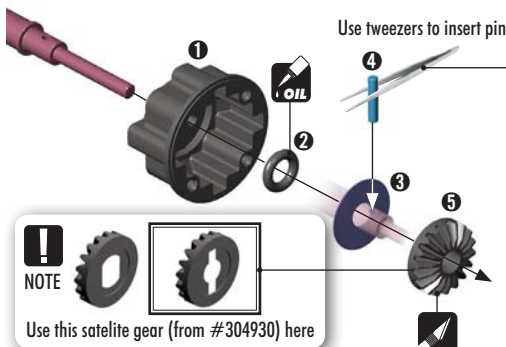



964031
S 3.5x10x0.2

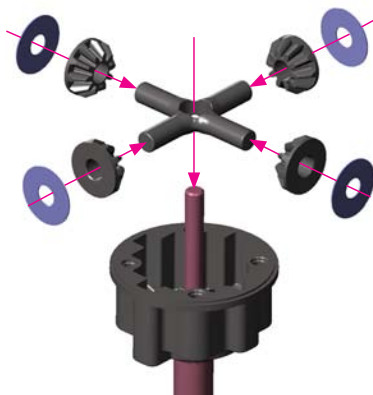

It is important that the diff cross enters the differential case freely.



If not, use the hobby knife to remove the remaining material.



Silicone oil

Fill just above the cross-pins.

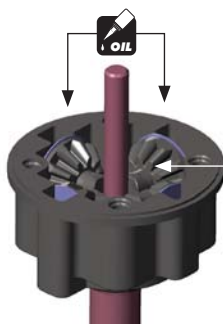

Fill differential up to the top of the diff cross-pins. DO NOT fill the diff to the top of the housing.

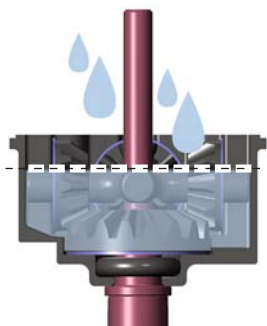

HUDDY Premium Silicone Oil

LOW TRACTION	
500 cSt	#106350
550 cSt	#106355
600 cSt	#106360
650 cSt	#106365
700 cSt	#106370
750 cSt	#106375
800 cSt	#106380
900 cSt	#106390
1000 cSt	#106410

MEDIUM-HIGH TRACTION	
2000 cSt	#106420
3000 cSt	#106430
4000 cSt	#106440
5000 cSt	#106450

SUPER-HIGH TRACTION	
6000 cSt	#106460
7000 cSt	#106470
8000 cSt	#106480
10000 cSt	#106510

NOTE: Softer oil increases steering and traction, harder oil increases stability and cornering speed of the car.



964050
5x15x0.3



972050
0x5x2

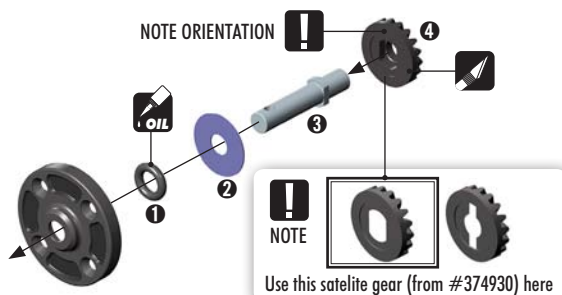

NOTE ORIENTATION

NOTE

Use this satellite gear (from #374930) here



CUTAWAY VIEW

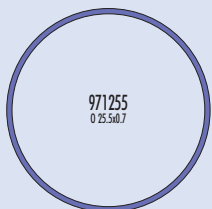

971255
0x25.5x0.7



After disassembling the gear diff the large O-ring may have an increased size and may be more difficult to re-install. We recommend either inserting the old O-ring carefully in the diff cover, or replacing the old O-ring with a new O-ring if the old one cannot be made to fit properly.



903258
SFH M2.5x8

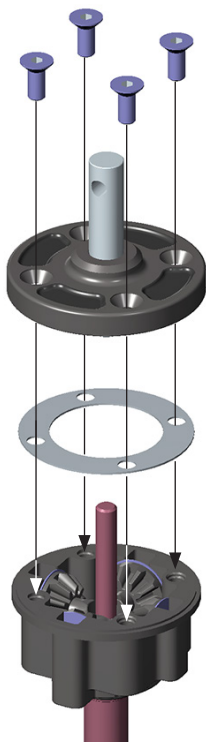

Tighten the screws equally but do NOT tighten them completely.

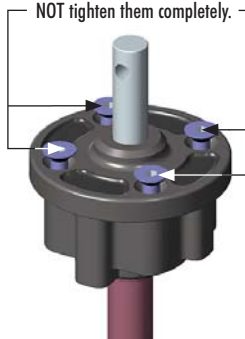

Finish tightening in this order.

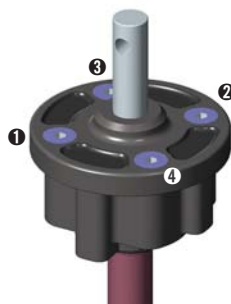



908258
SCH M2.5x8

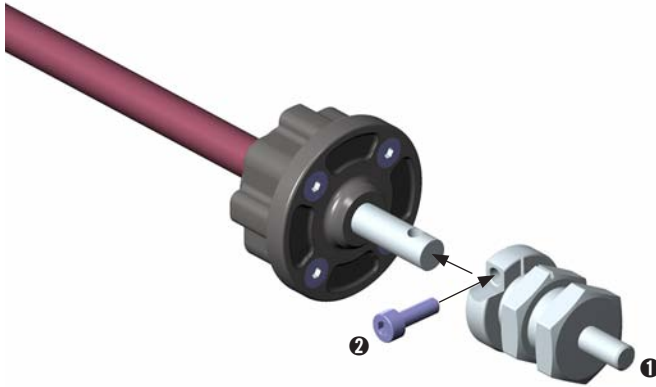

902256
SCH M2.5x8

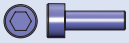
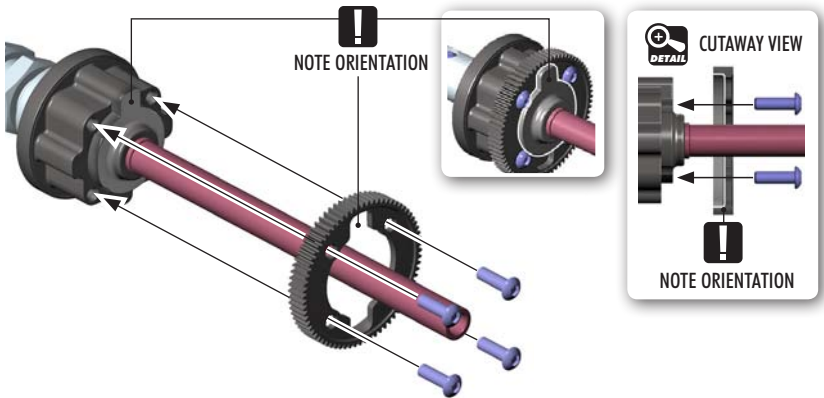

908258
SCH M2.5x8

