

## #374902 - XRAY Gear Differential 1/10 Pan Cars - Set

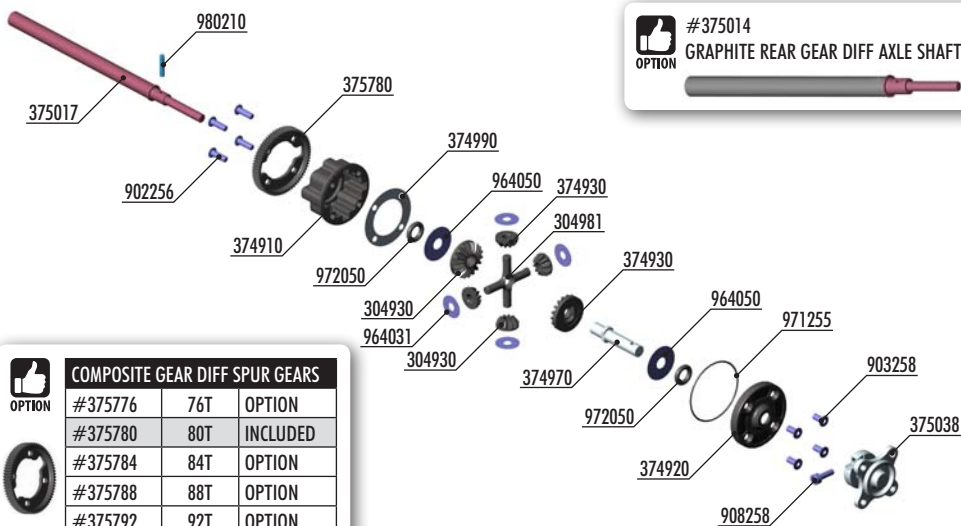

30 3141-0 ALU SHIM 3x5x1.0MM - ORANGE (10)  
 30 3142-0 ALU SHIM 3x5x0.5MM - ORANGE (10)  
 30 4930 COMPOSITE GEAR DIFF BEVEL & SATELLITE GEARS (2+4)  
 30 4981 COMPOSITE GEAR DIFF CROSS PIN WITH HOLE  
 37 4900 XRAY GEAR DIFFERENTIAL 1/12 PAN CARS - SET  
 37 4910 COMPOSITE GEAR DIFFERENTIAL CASE - GRAPHITE  
 37 4920 COMPOSITE GEAR DIFFERENTIAL COVER - GRAPHITE  
 37 4930 COMPOSITE GEAR DIFF BEVEL & SATELLITE GEARS (2+4)  
 37 4970 ALU GEAR DIFF SHAFT - SWISS 7075 T6  
 37 4990 DIFF GASKET (4)  
 37 5017 REAR GEAR DIFF AXLE SHAFT - HUDY SPRING STEEL™

37 5038 X10 ALU GEAR DIFF REAR WHEEL HUB - SWISS 7075 T6  
 37 5780 COMPOSITE GEAR DIFF SPUR GEAR - 80T / 64P  
 90 2256 HEX SCREW SH M2.5x6 (10)  
 90 3258 HEX SCREW SFH M2.5x8 (10)  
 90 8258 HEX SCREW SOCKET HEAD CAP M2.5x8 (10)  
 96 4031 WASHER S 3.5x10x0.2 (10)  
 96 4050 WASHER S 5x15x0.3 (10)  
 97 1255 SILICONE O-RING 25.5x0.7 (10)  
 97 2050 SILICONE O-RING 5x2 (10)  
 98 0210 PIN 2x9.8 (10)



964050  
5x15x0.3



972050  
0.5x2

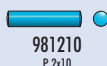

981210  
2x10

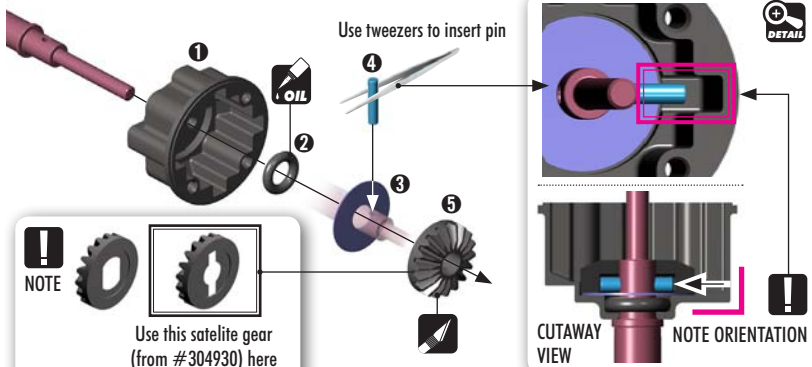

964031  
S 3.5x10x0.2

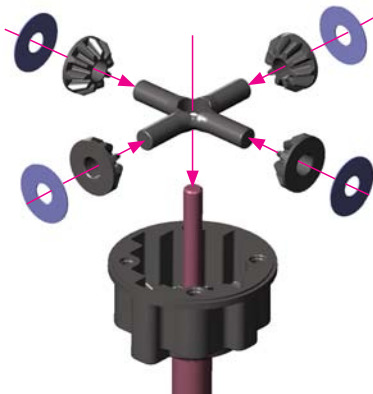

**!** It is important that the diff cross enters the differential case freely. If not, use the hobby knife to remove the remaining material.



Silicone oil

Fill just above the cross-pins.

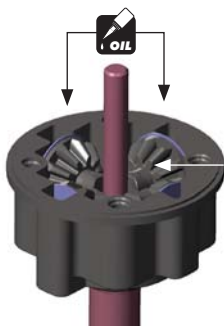

Fill differential up to the top of the diff cross-pins. DO NOT fill the diff to the top of the housing.

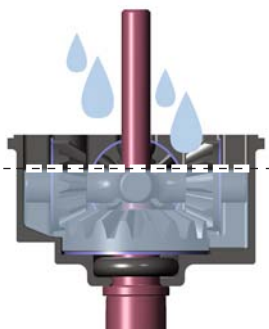

**TIP**

LOW TRACTION

MEDIUM-HIGH TRACTION

SUPER-HIGH TRACTION

1 000cSt (HUDY #106410)

5 000cSt (HUDY #106450)

10 000cSt (HUDY #106510)

**NOTE:** Softer oil increases steering and traction, harder oil increases stability and cornering speed of the car.



964050  
5.5x15x0.3



972050  
0.5x2

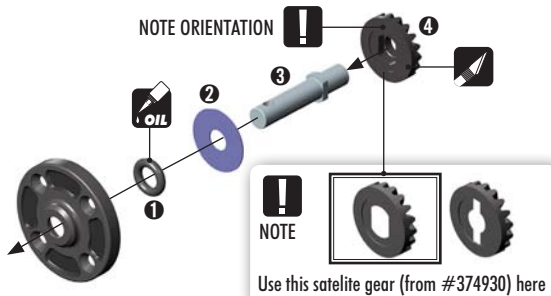

CUTAWAY VIEW

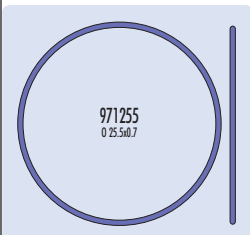

971255  
0.25.5x0.7



After disassembling the gear diff the large O-ring may have an increased size and may be more difficult to re-install. We recommend either inserting the old O-ring carefully in the diff cover, or replacing the old O-ring with a new O-ring if the old one cannot be made to fit properly.



903258  
SFH M2.5x8

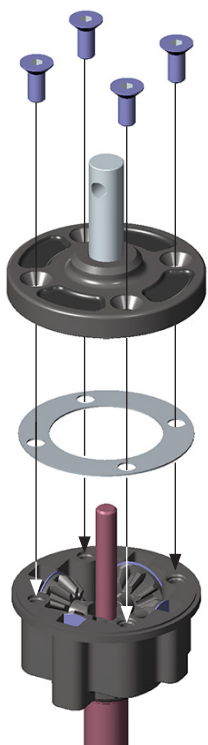

Tighten the screws equally but do NOT tighten them completely.

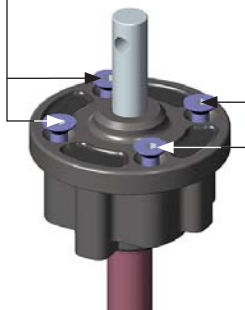

Finish tightening in this order.

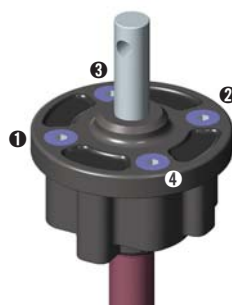

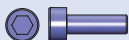

908258  
SCH M2.5x8

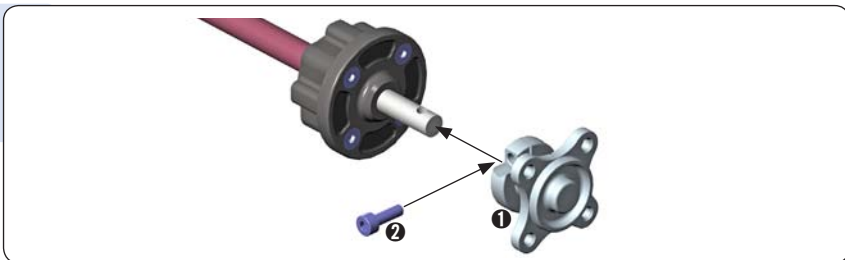

902256  
SH M2.5x6

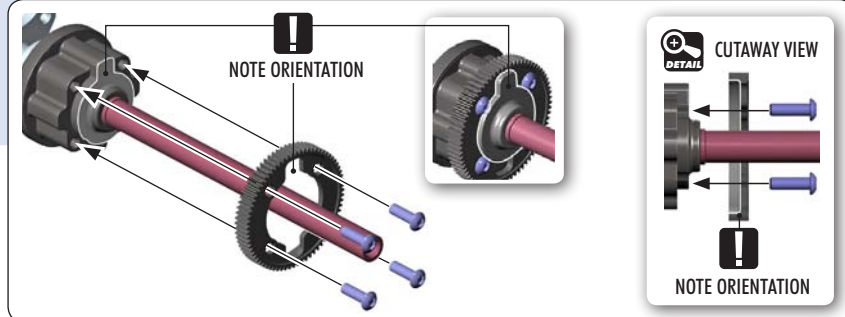

375090-0  
6.4x8.4x1.0



375090-0  
6.4x8.4x0.5



908258  
SCH M2.5x8



951438  
BB 1/4"x3/8"x1/8"

