

#324000 SHORT 2-PAD SLIPPER CLUTCH SET - SHOCKS IN FRONT

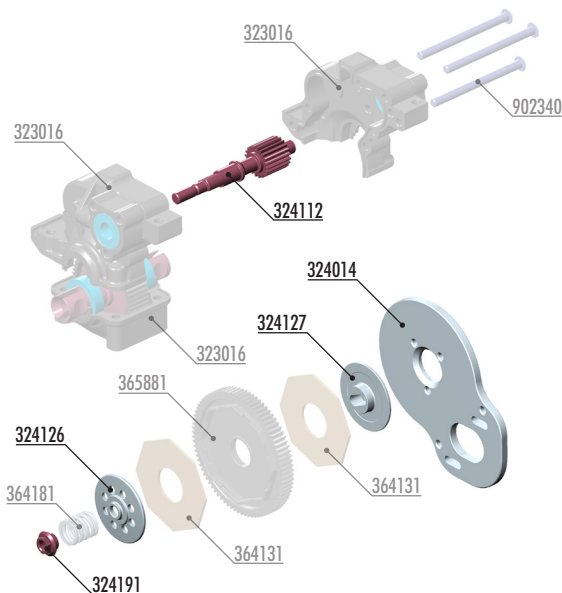

NOTE

Shorter slipper fit only for mid motor gearbox. For assembly follow XB2D'19 instructions on page 13.



- #324014 ALU MID & REAR MOTOR PLATE - SHORT ROD - SWISS 7075 T6 (3mm)
- #324112 ALU TOP SHAFT 20T - SHORT - SWISS 7075 T6 - HARD COATED
- #324126 ALU 2-PAD SLIPPER CLUTCH PLATE - SHORT - SWISS 7075 T6
- #324127 ALU 2-PAD SLIPPER CLUTCH PLATE WITH ADAPTER - SHORT - SWISS 7075 T6
- #324191 STEEL SLIPPER CLUTCH NUT - HUDY SPRING STEEL™