

# **XRAY M18T**

**4WD SHAFT-DRIVE 1/18 MICRO TRUCK**



## **INSTRUCTION MANUAL**

IT'S FUN, IT'S MICRO TRUCK, IT'S



## CUSTOMER SUPPORT

We have made every effort to make these instructions as easy to understand as possible. However, if you have any difficulties, problems, or questions, please do not hesitate to contact the XRAY support team at [info@teamxray.com](mailto:info@teamxray.com). Also, please visit our web site at [www.teamxray.com](http://www.teamxray.com) to find the latest updates, set-up information, option parts, and many other goodies. We pride ourselves on taking excellent care of our customers.

### **XRAY EUROPE**

Pred Polom 762  
91101 Trenčín  
Slovakia, EUROPE

Phone: 421-32-7440180  
Fax: 421-32-7440179

Email: [info@teamxray.com](mailto:info@teamxray.com)

### **XRAY USA**

167 Turtle Creek Boulevard Suite C  
Dallas, Texas 75207  
USA

Phone: (800) 519-7221 \* (214) 744-2400  
Fax: (214) 744-2401

Email: [xray@rcamerica.com](mailto:xray@rcamerica.com)

---

## R/C TIPS

- Read and fully understand the instruction manual before building.
- Always keep this instruction manual ready at hand for quick reference, even after completing the assembly.
- Clear a work area for assembling the kit.
- Work on a light-colored towel so any dropped parts are easy to find.
- Only open bags of parts for the assembly section you are building; do not open parts bags before required.
- Make sure all screws are tight, and check them periodically. Make sure the chassis screws do not protrude below the chassis.
- For best performance, it is very important to ensure the free movement of all parts.
- Tap or pre-thread composite parts when threading screws.
- Self-tapping screws cut threads into the parts when tightened. Do not use excessive force when tightening self-tapping screws, or you may strip out the thread in the plastic. We recommend you stop tightening a screw when you feel some resistance.

Please support your local hobby shop, and ask them for advice. We at XRAY Model Racing Cars support all local hobby dealers. We ask you to purchase XRAY products at your hobby dealer whenever possible, and give them your support as we do. If you have difficulty finding XRAY products, please visit us at [www.teamxray.com](http://www.teamxray.com) for advice, or contact us via e-mail at [support@teamxray.com](mailto:support@teamxray.com), or contact the XRAY distributor in your country.

---

In line with our policy of continuous product development, the exact specifications of the kit may vary. In the unlikely event of any problems with your new kit, you should contact the model shop where you purchased it, quoting the part number. We reserve all rights to change any specification without prior notice. All rights reserved.

## SYMBOLS USED

Part bags used	Assemble left and right sides the same way	Assemble in the specified order	Pay attention here	Pivot ball type used	Apply instant glue	Apply instant grease	Ensure smooth non-binding movement	Cut off shaded portion	True-to-scale diagram	Assemble as many times as specified (here twice)
Truck orientation	Cut off remaining material	Cut off remaining material from all plastic parts.	Tighten screw gently	Self-tapping screws cut threads into the parts when being tightened. Excessive force may permanently damage parts when tightening screws. It is recommended to stop tightening when the part is attached or when some resistance is felt after the threaded portion enters the plastic.						
				<div> <div>CORRECT </div> <div> </div> <div> <div>WRONG </div> <div> </div> <div> Overtightened </div> <div> The threads are stripped. </div> </div> </div>						

## TOOLS INCLUDED

Pin Assembly Tool	Universal Tool	Phillips Screwdriver	1.5mm Allen Wrench

## TOOLS REQUIRED

Hobby Knife	Side Cutters	Needlenose Pliers	Curved Scissors	Hole Reamer

## EQUIPMENT REQUIRED

Transmitter	Micro Motor	Micro Servo	Receiver	Micro Speed Controller	Lexan Paint	CA Glue	6-Cell Micro Battery Pack	Battery Charger	Transmitter Batteries

## 1. FRONT DIFFERENTIAL

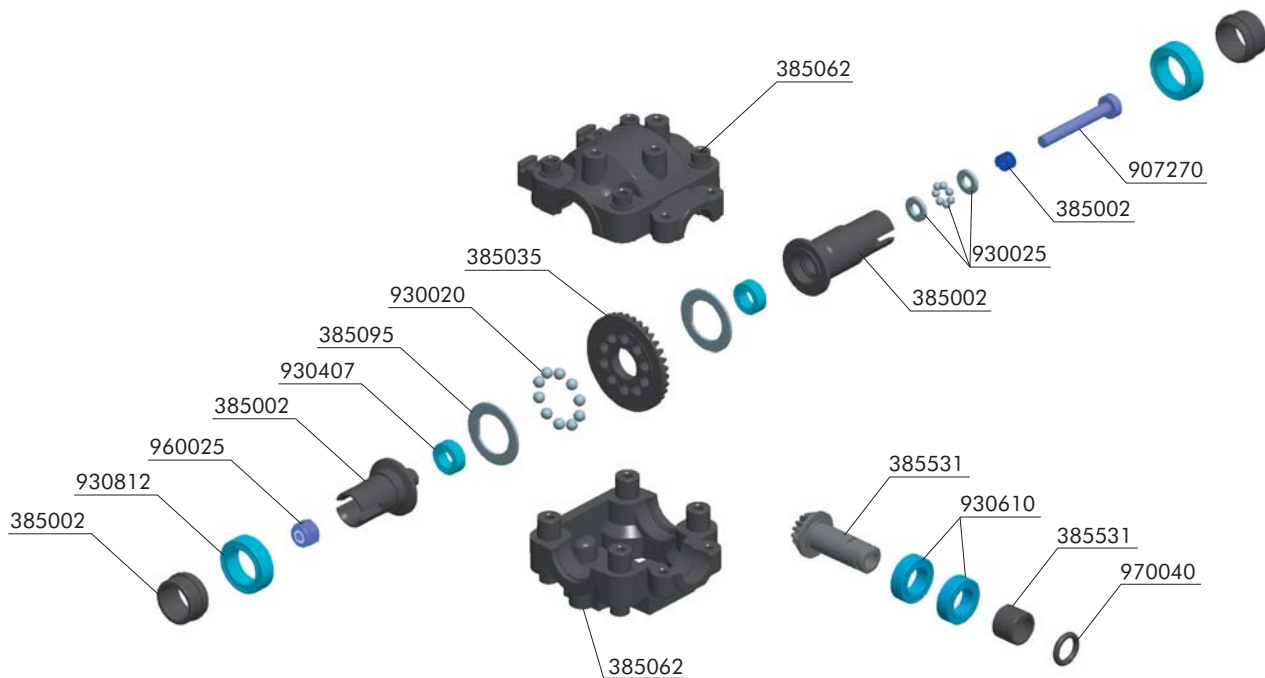

385002 COMPOSITE ADJUSTABLE BALL DIFFERENTIAL  
 385035 BEVELED DIFF. GEAR FOR BALL DIFF.  
 385062 GEARBOX CASE M18T  
 385095 BALL DIFF D - WASHER (2)  
 385531 MAIN DRIVESHAFT PINION GEAR & HUB M18T

930020 BALL STEEL 2.4MM (24)  
 930025 BALL-BEARING AXIAL 2.5x5.4x0.8  
 930407 BALL-BEARING MR74ZZ 4x7x2.5 (2)  
 930610 BALL-BEARING MR106ZZ 6x10x3 (2)  
 930812 BALL-BEARING MR128ZZ 8x12x3.5 (2)  
 970040 O-RING 4x1 (10)  
 960025 NUT M2.5 (10)

907270 SCREW PHILLIPS 2.5x20 (10)



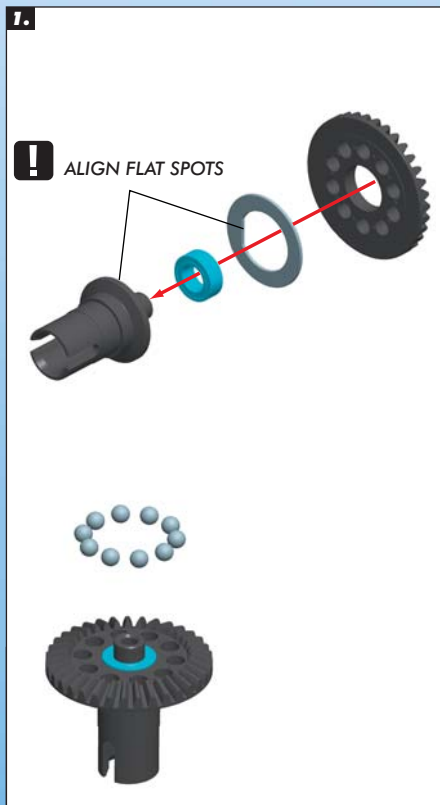

930020  
B 2.4

930407  
BB 4x7x2.5

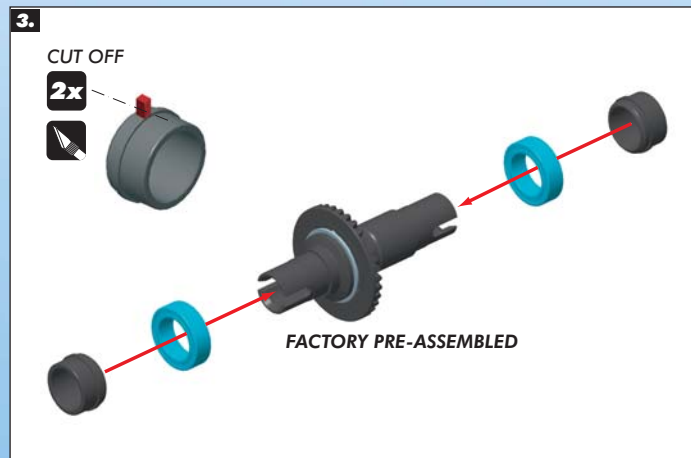
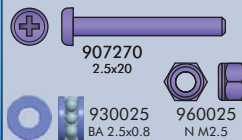
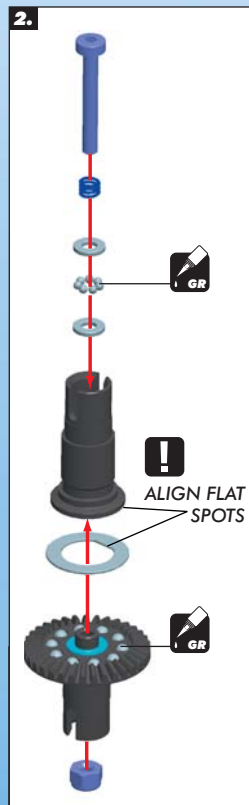

ASSEMBLED VIEW



930812  
BB 8x12x3.5

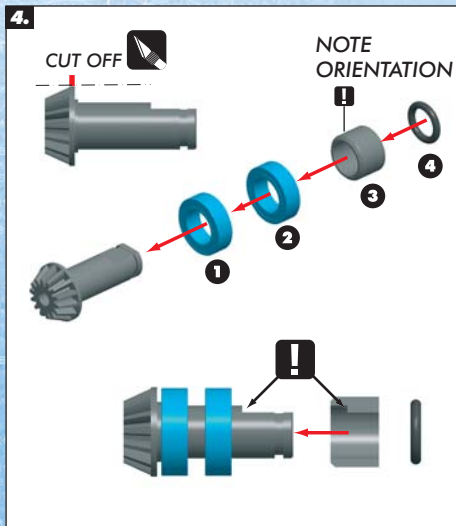

**ASSEMBLED VIEW**



**ORIENTATION**



930610  
BB 6x10x3



970040  
O 4x1

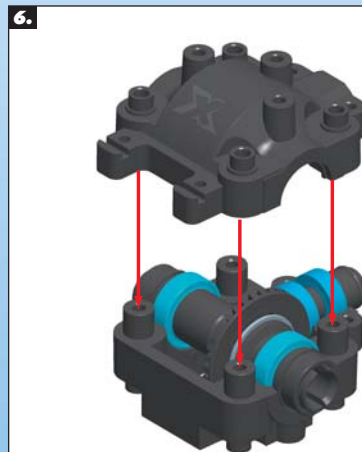
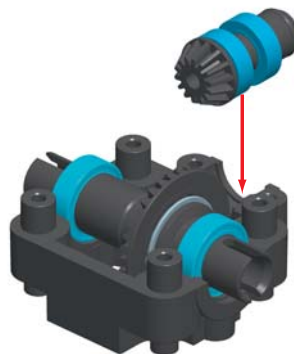
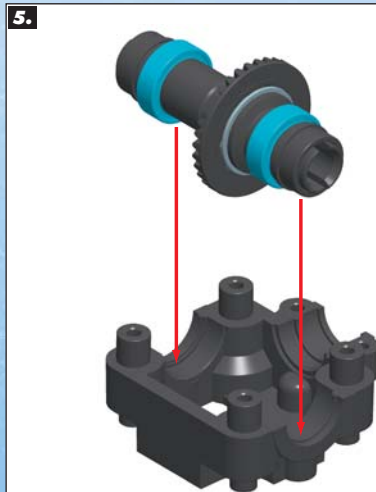

**ASSEMBLED VIEW**



## 2. REAR DIFFERENTIAL

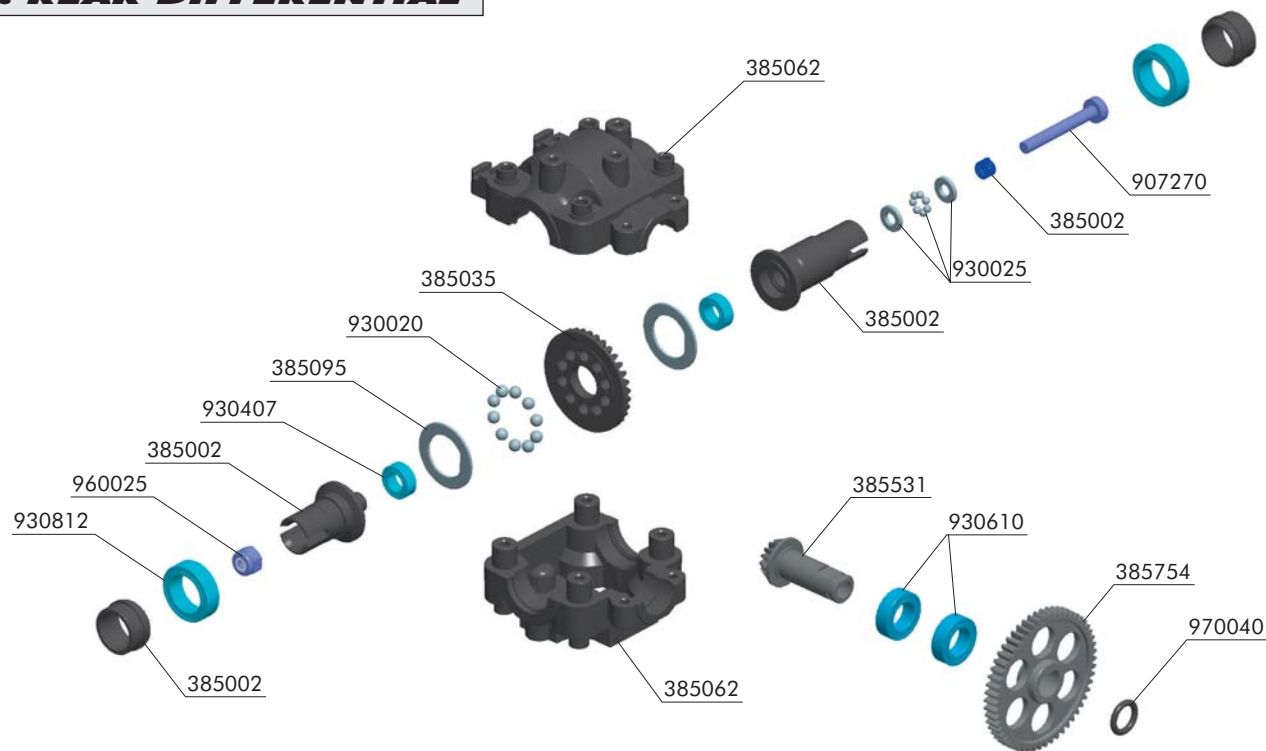

385002	COMPOSITE ADJUSTABLE BALL DIFFERENTIAL
385035	BEVELED DIFF. GEAR FOR BALL DIFF.
385062	GEARBOX CASE M18T
385095	BALL DIFF D - WASHER (2)
385531	MAIN DRIVESHAFT PINION GEAR & HUB M18T
385754	SPUR GEAR 54T / 48
907270	SCREW PHILLIPS 2.5x20 (10)

930020	BALL STEEL 2.4MM (24)
930025	BALL-BEARING AXIAL 2.5x5.4x0.8
930407	BALL-BEARING MR74ZZ 4x7x2.5 (2)
930610	BALL-BEARING MR106ZZ 6x10x3 (2)
930812	BALL-BEARING MR128ZZ 8x12x3.5 (2)
970040	O-RING 4x1 (10)
960025	NUT M2.5 (10)

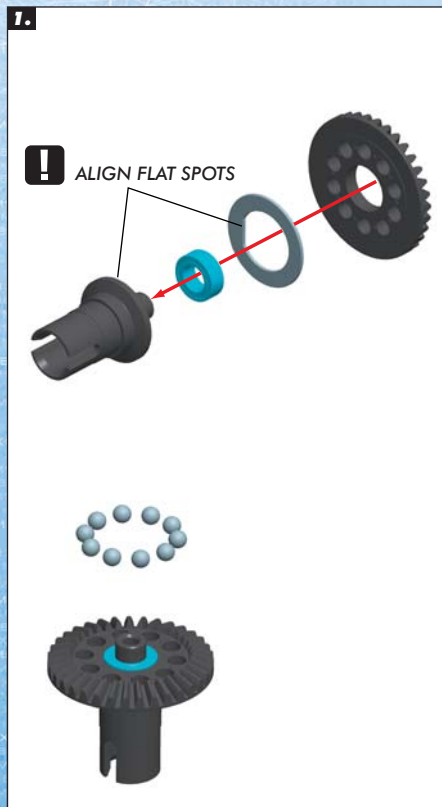

930020  
B 2.4



930407  
BB 4x7x2.5

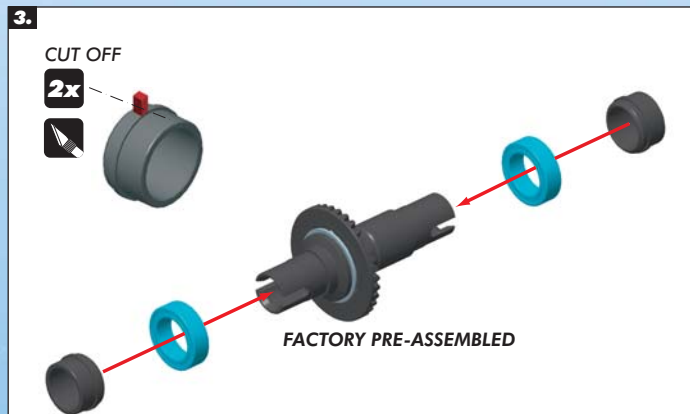
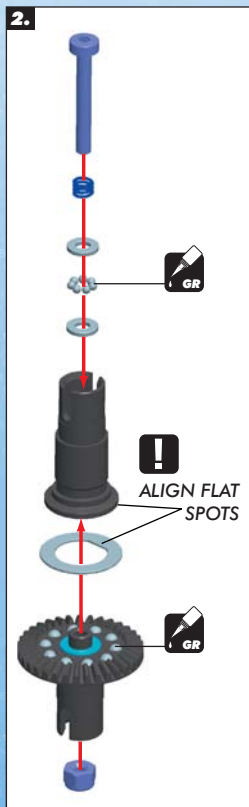

**ASSEMBLED VIEW**



930812  
BB 8x12x3.5



4.

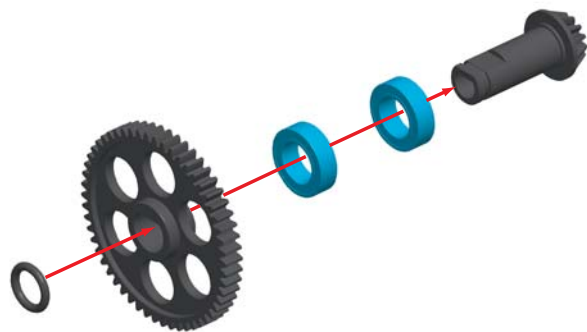
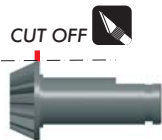

930610  
BB 6x10x3



970040  
O 4x1

5.

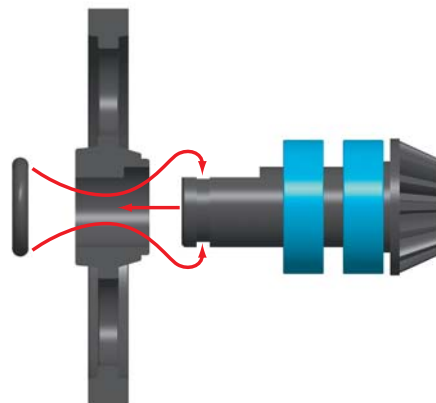

ASSEMBLED VIEW



6.



7.



8.

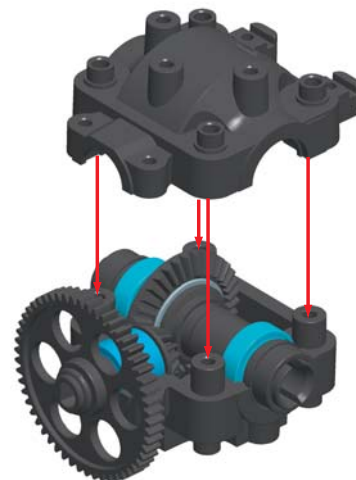

ASSEMBLED VIEW



### 3. REAR SUSPENSION

USE REMAINING PIVOT BALLS  
IN OTHER SECTIONS !!!



387410

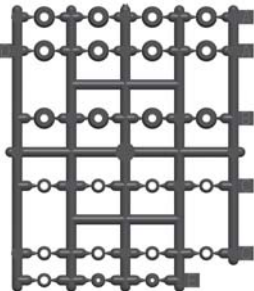

381210



381160

906258

905264

981208

385300

901325

385300

382650

383240

387410

905210

905212

905260

383150

905208

387410

382200

930610

387410

383120

905208



381160 COMPOSITE MICRO CHASSIS M18T  
381210 LOWER FRONT & REAR BUMPER M18T  
382200 COMPOSITE SUSPENSION BLOCK, L+R (2)  
382650 SET OF STEERING PARTS  
383120 SET OF REAR LOWER SUSPENSION ARMS M18T  
383150 SET OF REAR UPPER SUSPENSION ARMS M18T  
383240 LINKAGE REAR M18T (2)

385300 COMPOSITE DRIVE SHAFT SET M18T (2)  
387410 SET OF COMPOSITE PIVOT BALLS M18T  
901325 HEX SCREW SB M3x25 (10)  
905208 SCREW PHILLIPS 2.2x8 (10)  
905210 SCREW PHILLIPS 2.2x10 (10)  
905212 SCREW PHILLIPS 2.2x12 (10)

905260 SCREW PHILLIPS 2.5x10 (10)  
905264 SCREW PHILLIPS 2.5x14 (10)  
906258 SCREW PHILLIPS FH 2.5x8 (10)  
930610 BALL-BEARING MR106ZZ 6x10x3 (2)  
981208 PIN 2x8 (10)

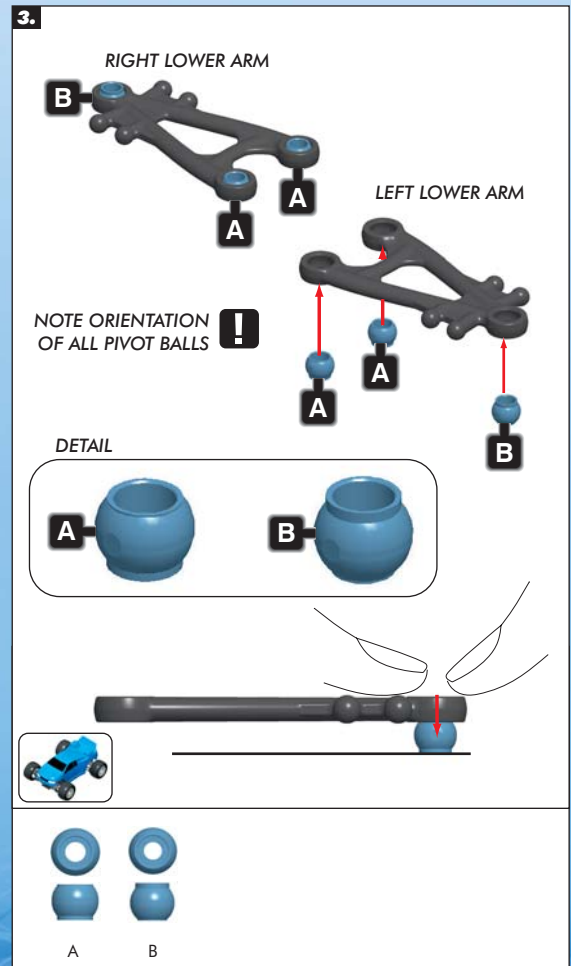
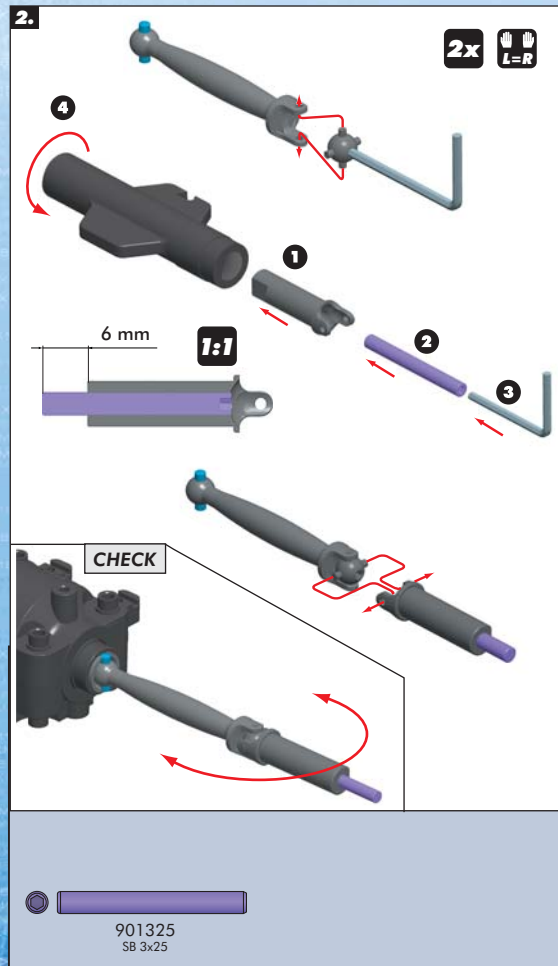
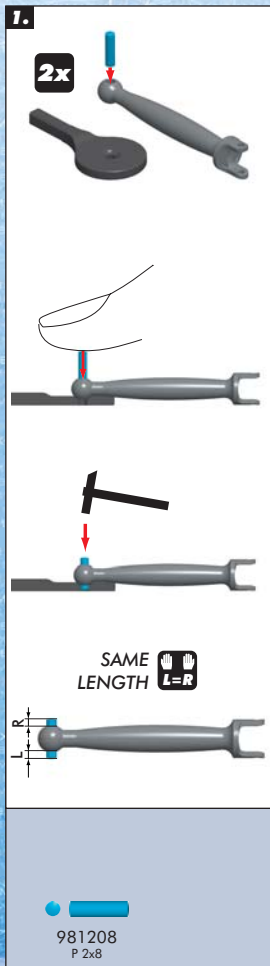



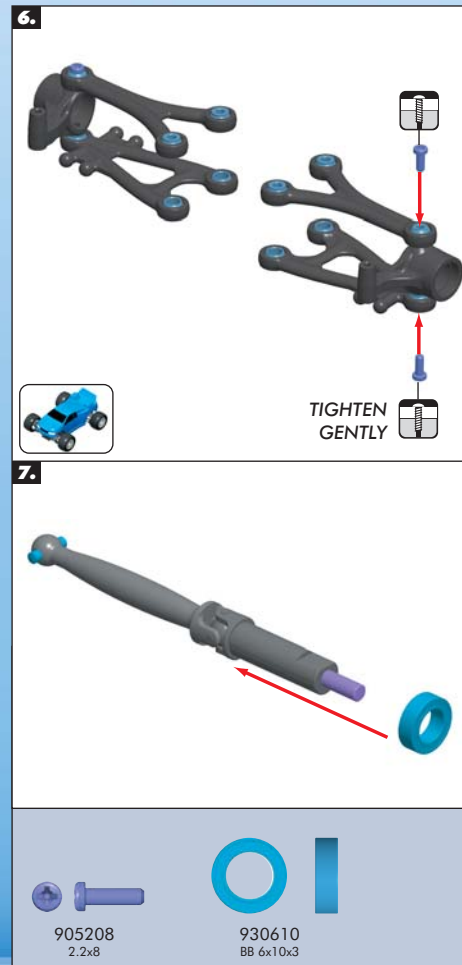
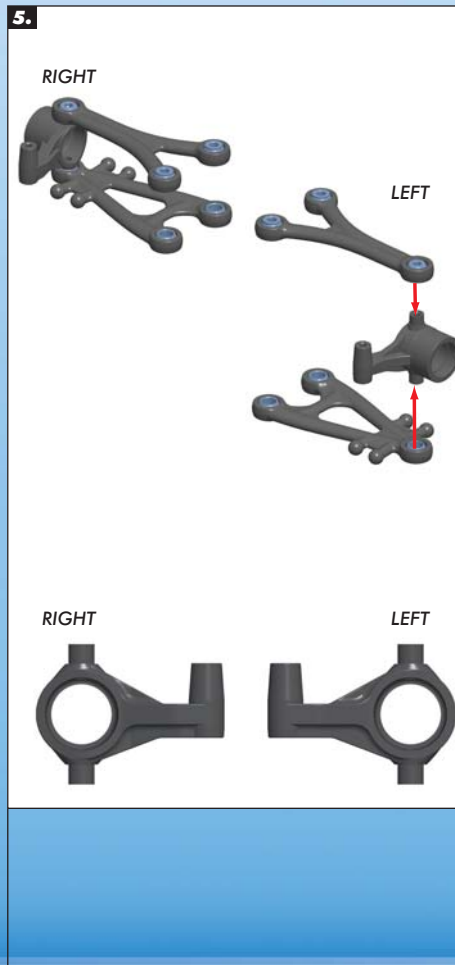
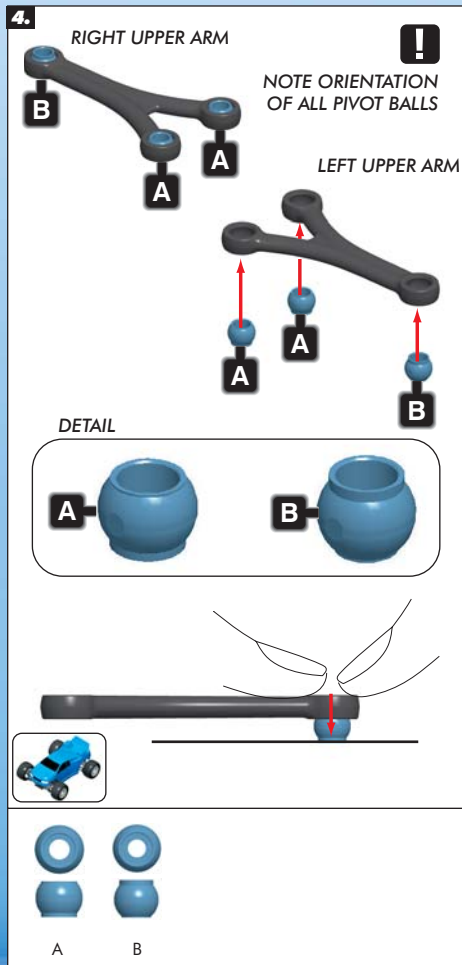

8.

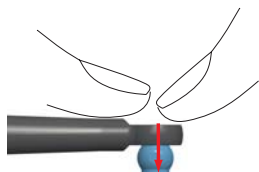
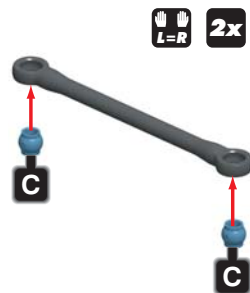

C

9.

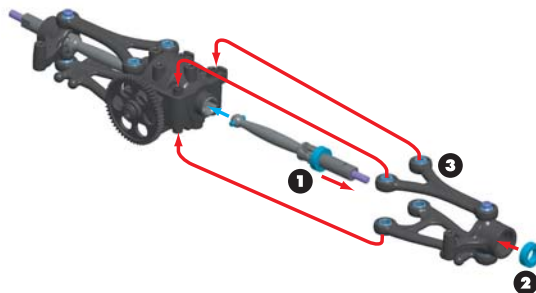

930610  
BB 6x10x3

10.

**TIGHTEN  
GENTLY**

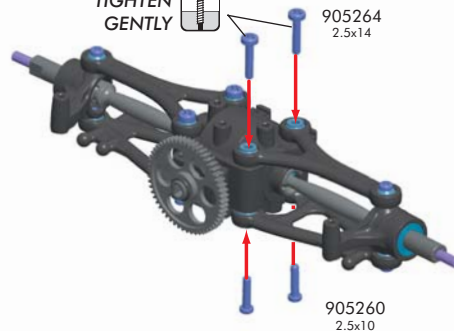

11.

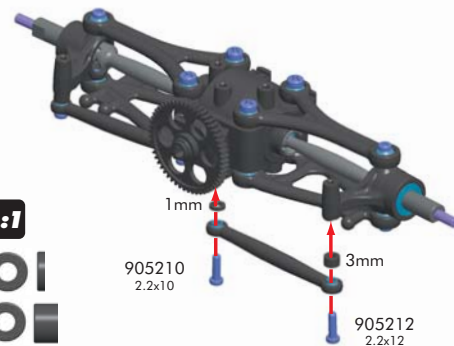

12.

DETAIL

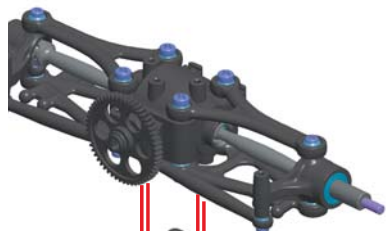
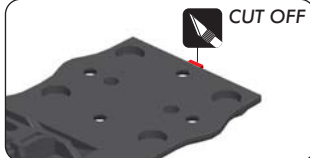

DETAIL



NOTE ORIENTATION

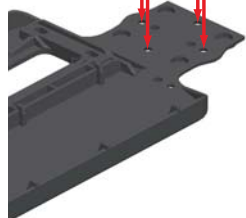

13.

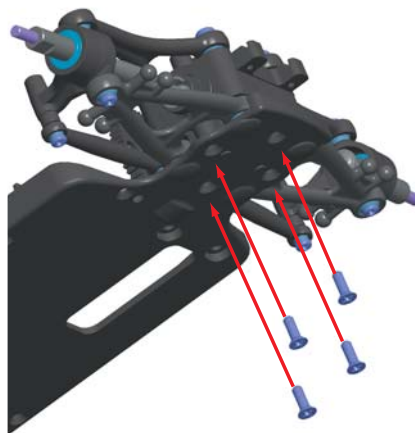

906258  
2.5x8

ASSEMBLED VIEW

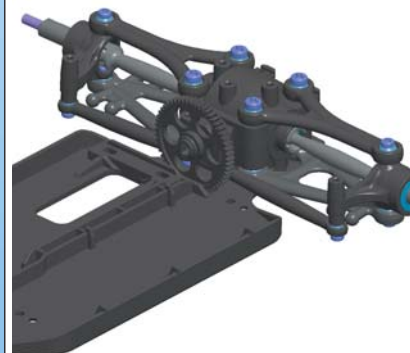

## 4. FRONT SUSPENSION

USE REMAINING PIVOT BALLS.

**BAG**



387410

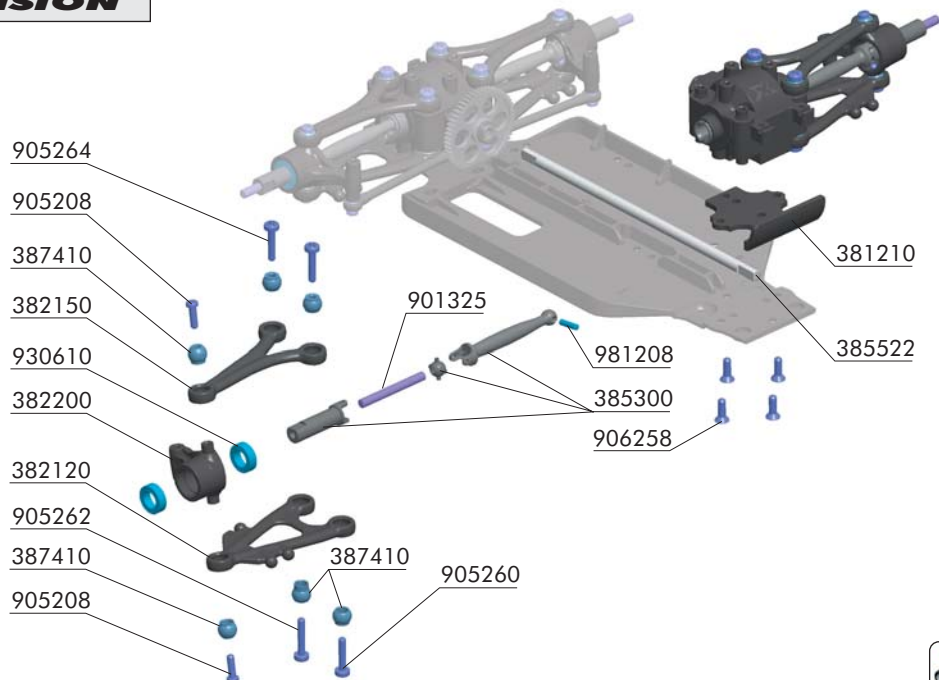

**BAG**



381210 LOWER FRONT & REAR BUMPER M18T  
382120 SET OF FRONT LOWER SUSPENSION ARMS M18T  
382150 SET OF FRONT UPPER SUSPENSION ARMS M18T  
382200 COMPOSITE SUSPENSION BLOCK, L+R (2)  
385300 COMPOSITE DRIVE SHAFT SET M18T (2)  
385522 ALU MAIN DRIVESHAFT M18T  
387410 SET OF COMPOSITE PIVOT BALLS M18T

901325 HEX SCREW SB M3x25 (10)  
905208 SCREW PHILLIPS 2.2x8 (10)  
905260 SCREW PHILLIPS 2.5x10 (10)  
905262 SCREW PHILLIPS 2.5x12 (10)  
905264 SCREW PHILLIPS 2.5x14 (10)  
906258 SCREW PHILLIPS FH 2.5x8 (10)  
930610 BALL-BEARING MR106ZZ 6x10x3 (2)  
981208 PIN 2x8 (10)



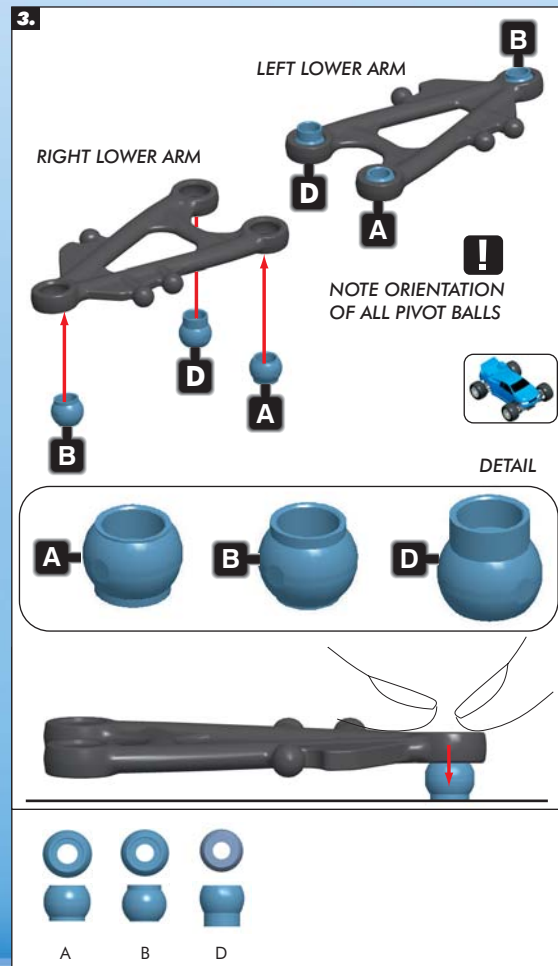
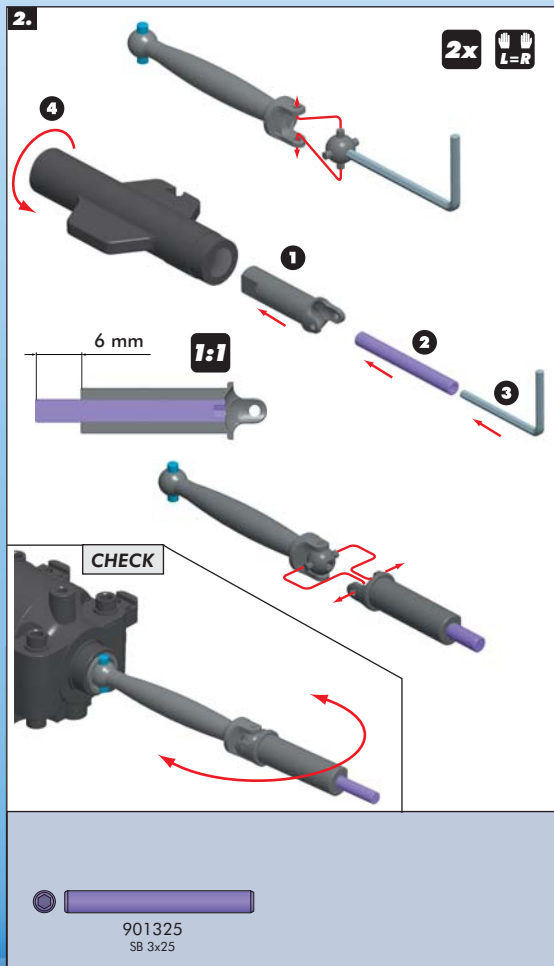
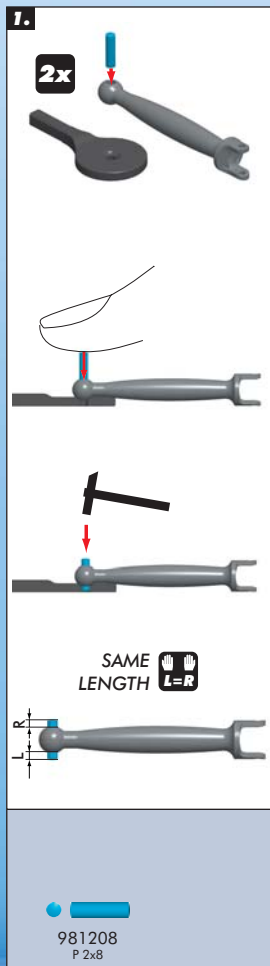

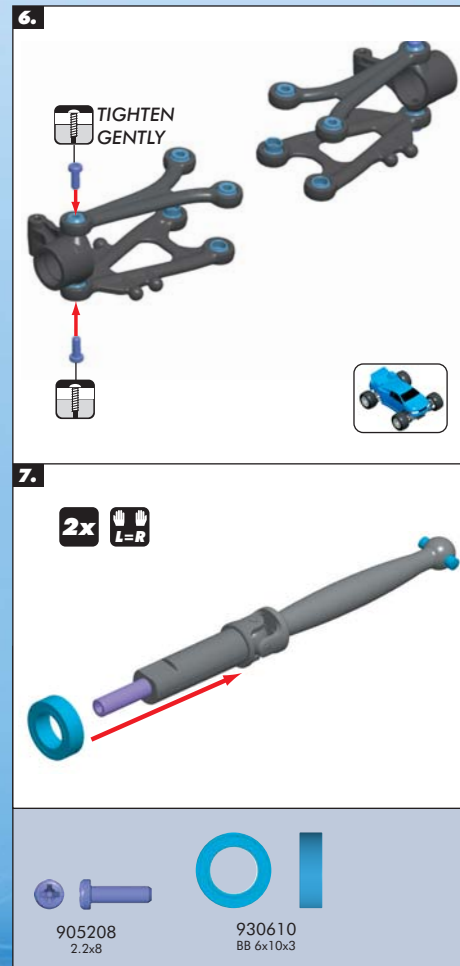
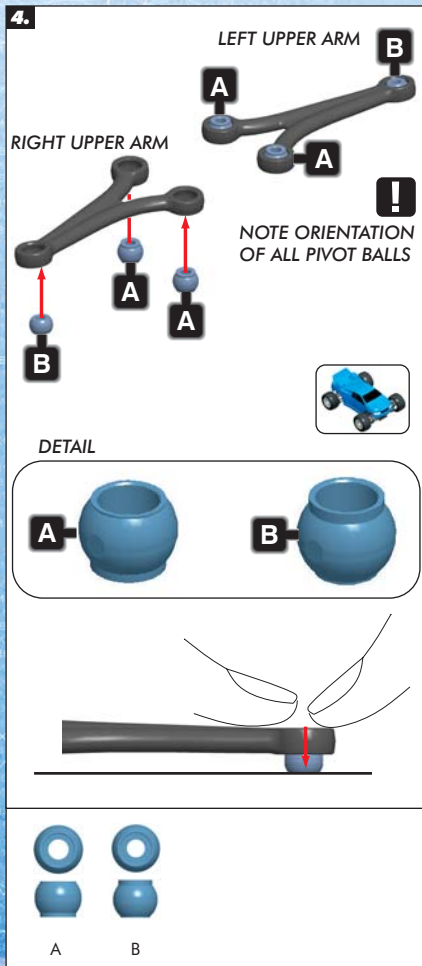

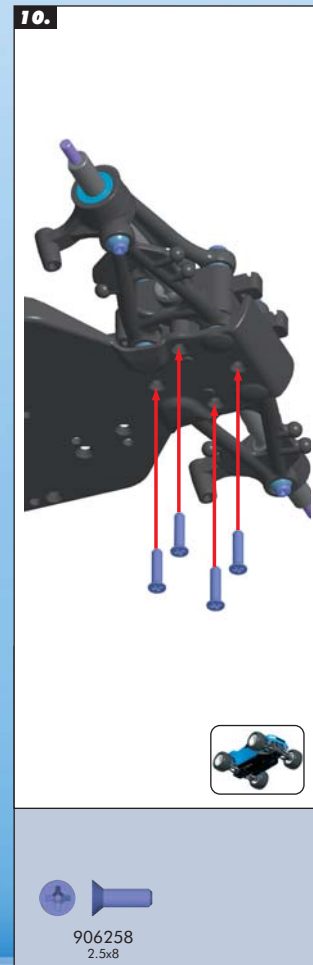
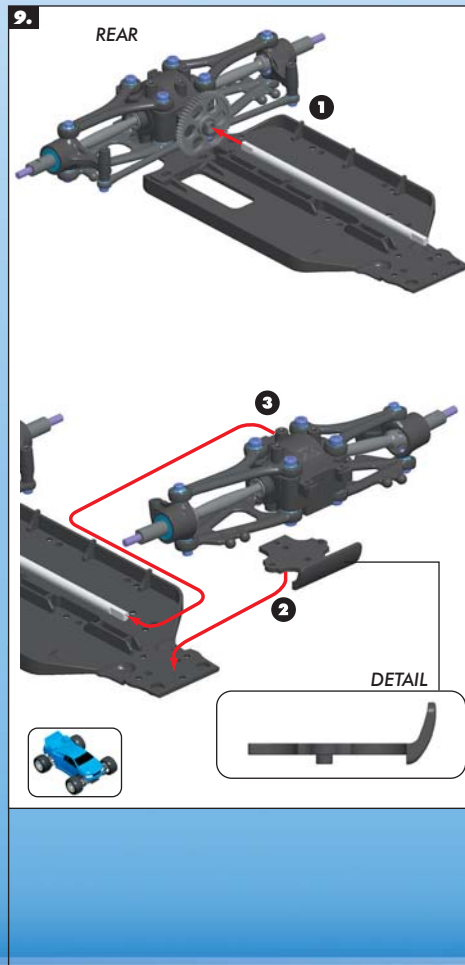
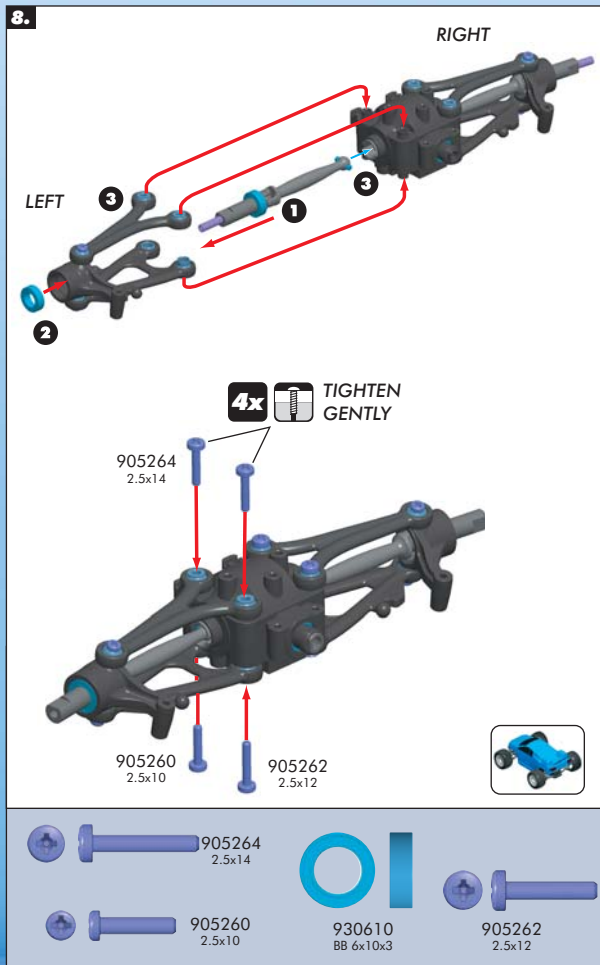

## 5. STEERING SYSTEM

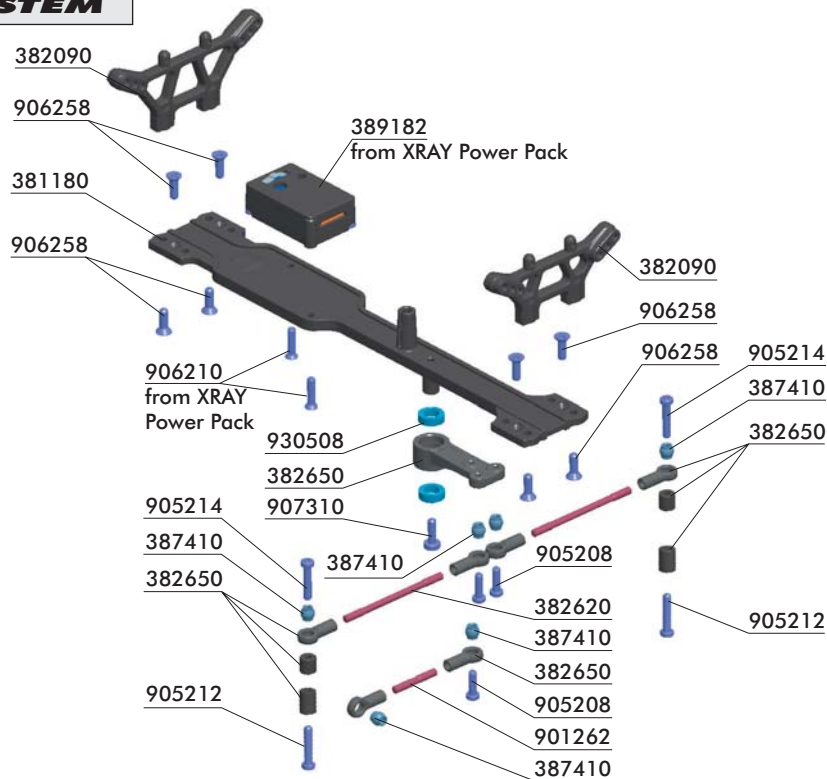

USE REMAINING PIVOT BALLS.

**BAG**



387410



**BAG**



381180	COMPOSITE TOP DECK M18T
382090	SHOCK TOWER FRONT & REAR M18T
382620	ADJUSTABLE TURNBUCKLE 40MM
382650	SET OF STEERING PARTS
387410	SET OF COMPOSITE PIVOT BALLS M18T
389182	XRAY MICRO SPEED CONTROLLER 300R WITH REVERSE
901262	HEX SCREW SB M2.5x12 (10)

905208	SCREW PHILLIPS 2.2x8 (10)
905212	SCREW PHILLIPS 2.2x12 (10)
905214	SCREW PHILLIPS 2.2x14 (10)
906210	SCREW PHILLIPS FH 2.2x10 (10)
906258	SCREW PHILLIPS FH 2.5x8 (10)
907310	SCREW PHILLIPS M3x10 (10)
930508	BALL-BEARING MR85ZZ 5x8x2.5 (2)



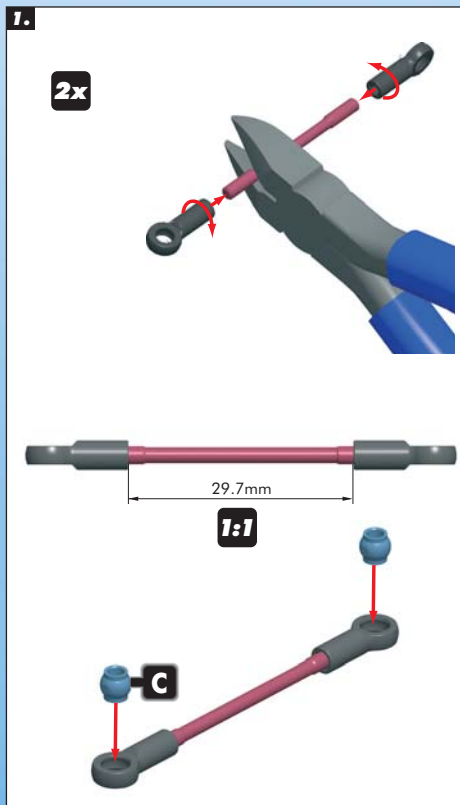

C

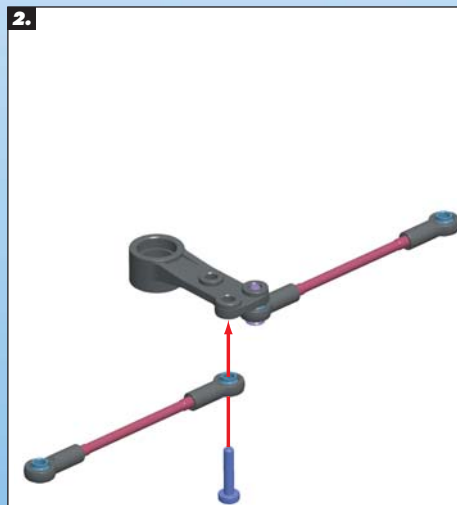

905208  
2.2x8

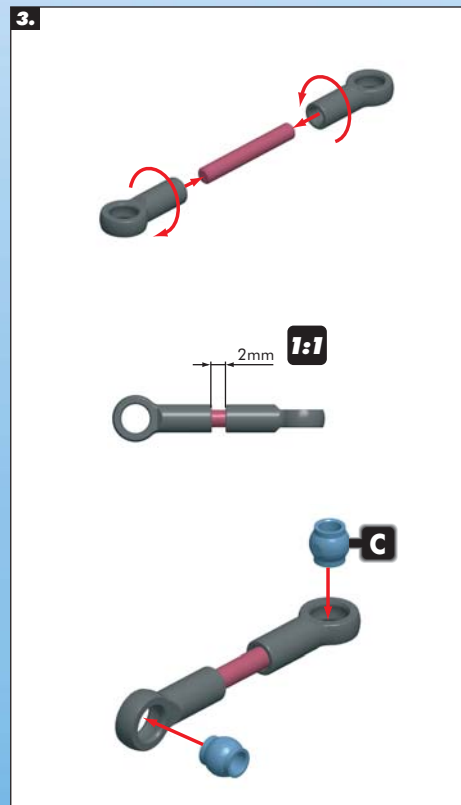

C



901262  
SB 2.5x12

4.

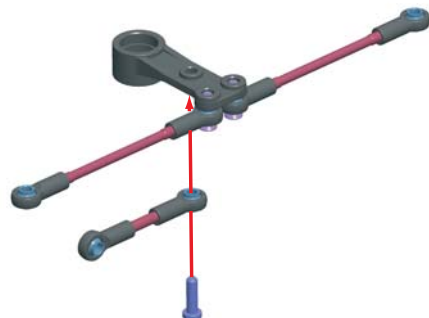

905208  
2.2x8

5.

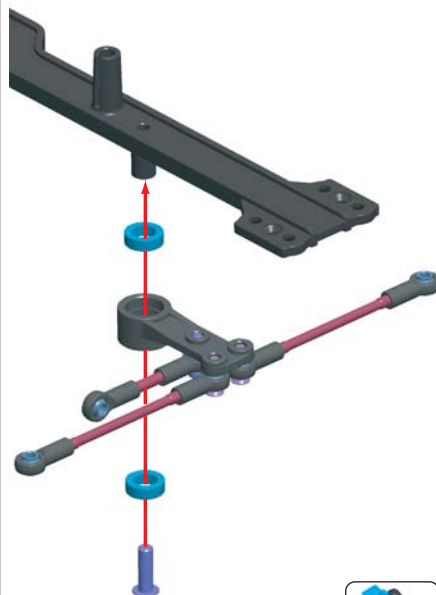

907310  
3x10

6.

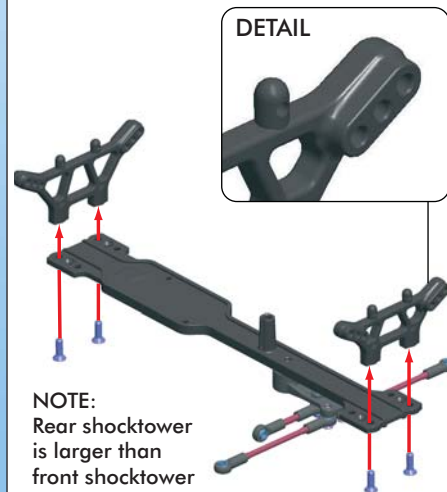

NOTE:  
Rear shocktower  
is larger than  
front shocktower



906258  
2.5x8

7.

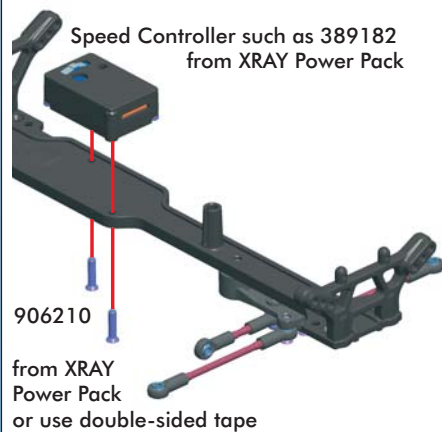

906210  
2.2x10

8.

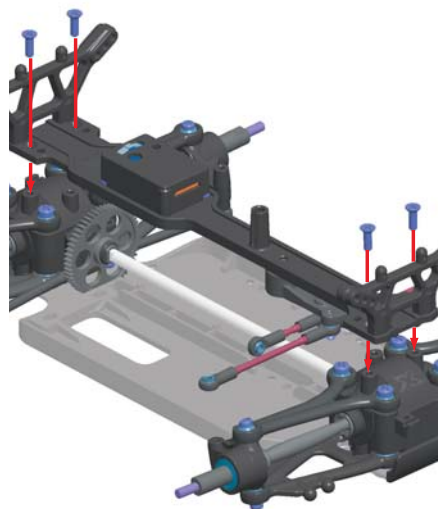

906258  
2.5x8

9.

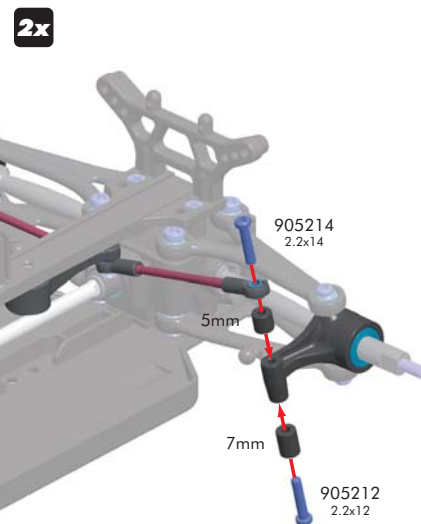

1:1



905212  
2.2x12



905214  
2.2x14

## 6. SHOCK ABSORBERS

USE REMAINING PIVOT BALLS.

**BAG**

**3.1**

387410

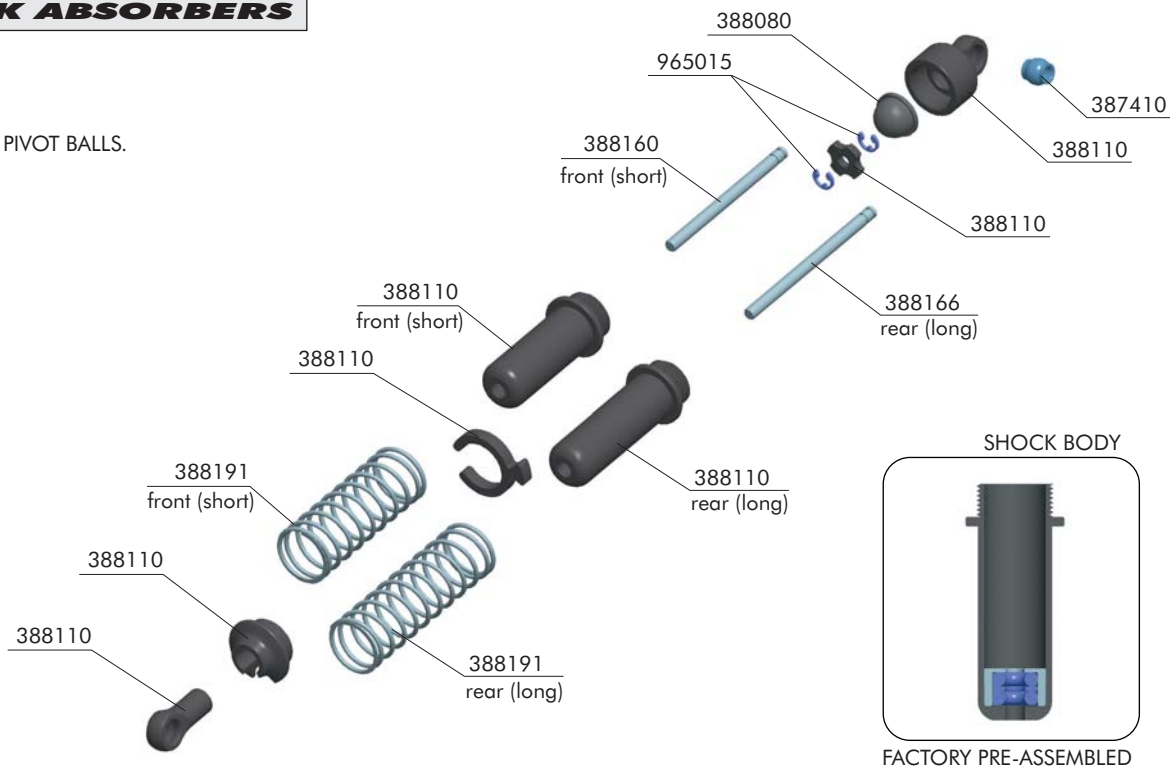

**BAG**

**6**

387410 SET OF COMPOSITE PIVOT BALLS M18T  
388080 MICRO SHOCKABSORBER MEMBRANES (4)  
388100 SHOCK ABSORBER-SET M18T (4)  
388110 COMPOSITE FRAME SHOCK PARTS (2)  
388160 FRONT MICRO SHOCK SHAFT M18T (2)

388166 REAR MICRO SHOCK SHAFT M18T (2)  
388191 XRAY SPRING-SET M18T  
965015 E-CLIP 1.5 (10)



965015  
C1.5

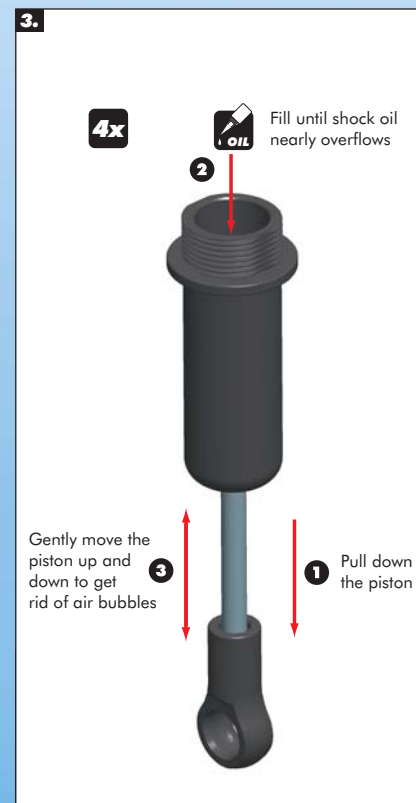
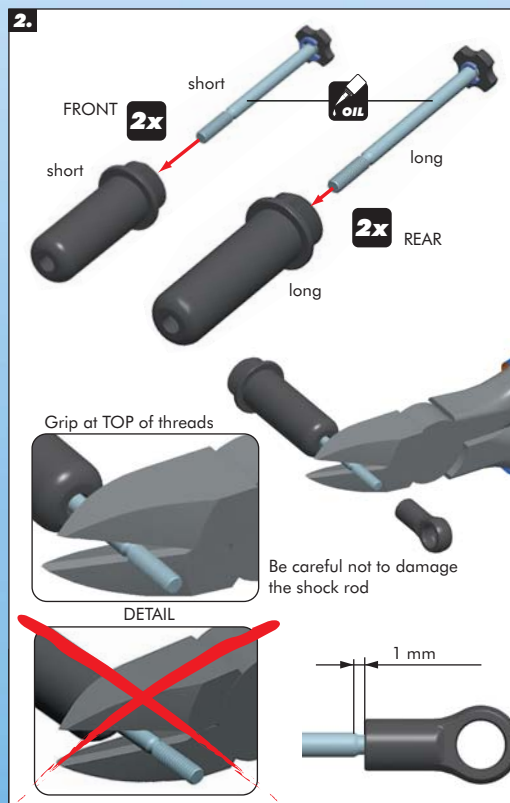



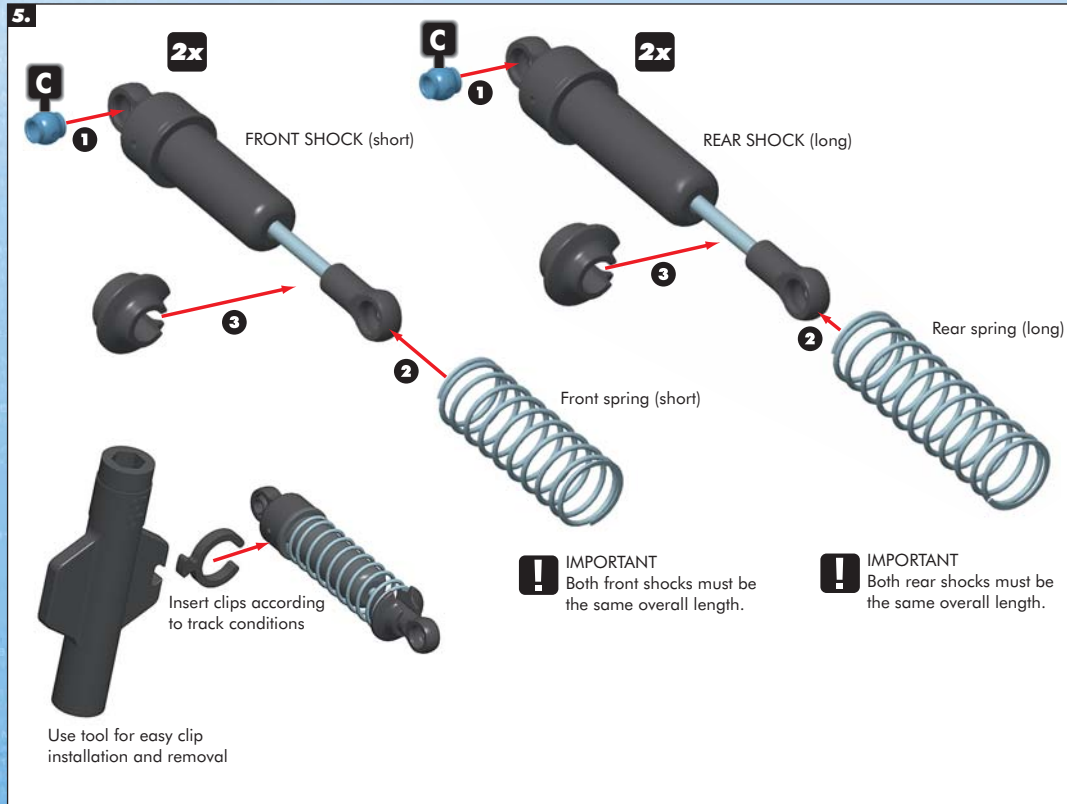
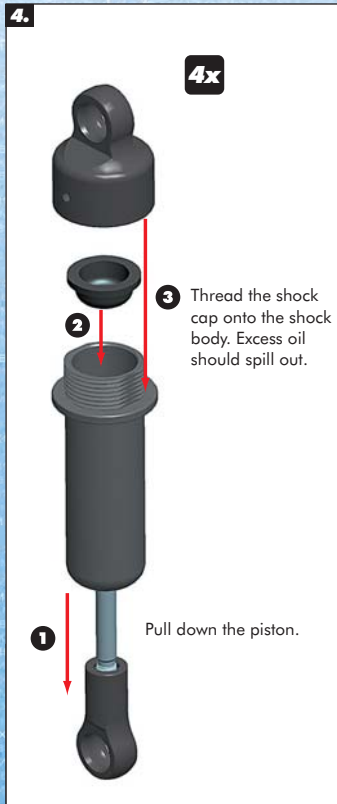

C

USE REMAINING PIVOT BALLS.

3.1

387410

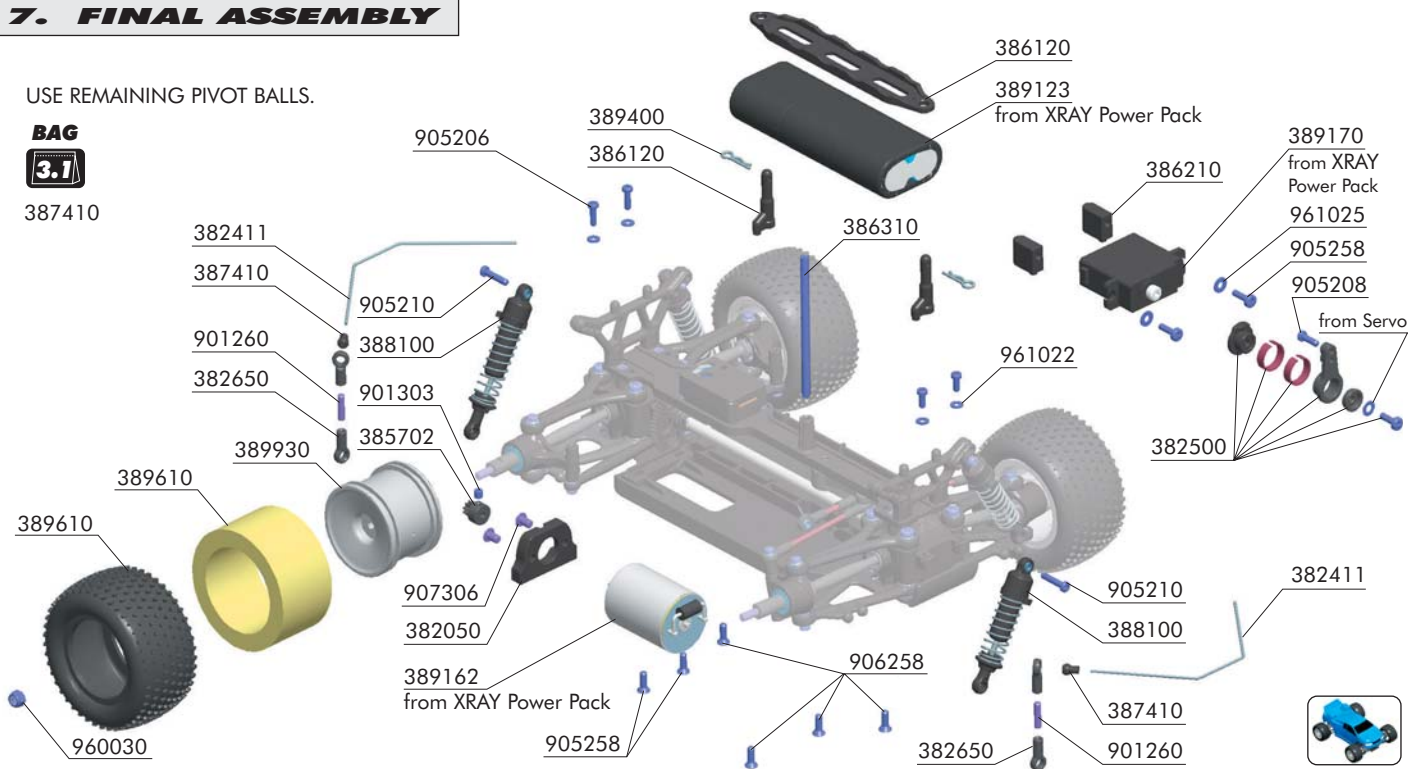

382050	COMPOSITE MOTOR HOLDER M18T	388100	SHOCK ABSORBER-SET M18T (4)	905206	SCREW PHILLIPS 2.2x6 (10)
382411	ANTI-ROLL BAR FRONT & REAR 1 MM	389123	XRAY BATTERY 6-CELL - 1100mAh NiMH - 7.2V	905208	SCREW PHILLIPS 2.2x8 (10)
382500	MICRO SERVO SAVER	389162	XRAY MICRO MOTOR 300 SUPER SIZE WITH PLUG	905210	SCREW PHILLIPS 2.2x10 (10)
382650	SET OF STEERING PARTS	389170	XRAY XMS01MG MICRO SERVO - METAL GEAR	905258	SCREW PHILLIPS 2.5x8 (10)
385702	COMPOSITE PINION SET (9,10,11,12)	389400	MICRO BODY CLIP (10)	906258	SCREW PHILLIPS FH 2.5x8 (10)
386120	COMPOSITE BATTERY HOLDER SET M18T	389610	MICRO M18T SLICK TIRE & INSERT (4+4)	907306	SCREW PHILLIPS M3x6 (10)
386210	COMPOSITE SERVO MOUNT M18T (2)	389930	WHEEL STARBURST AERODISK - M18T (4)	960030	NUT M3 (10)
386310	ANTENNA	901260	HEX SCREW SB M2.5x10 (10)	961022	WASHER S 2.2 (10)
387410	SET OF COMPOSITE PIVOT BALLS M18T	901303	HEX SCREW SB M3x3 (10)	961025	WASHER S 2.5 (10)

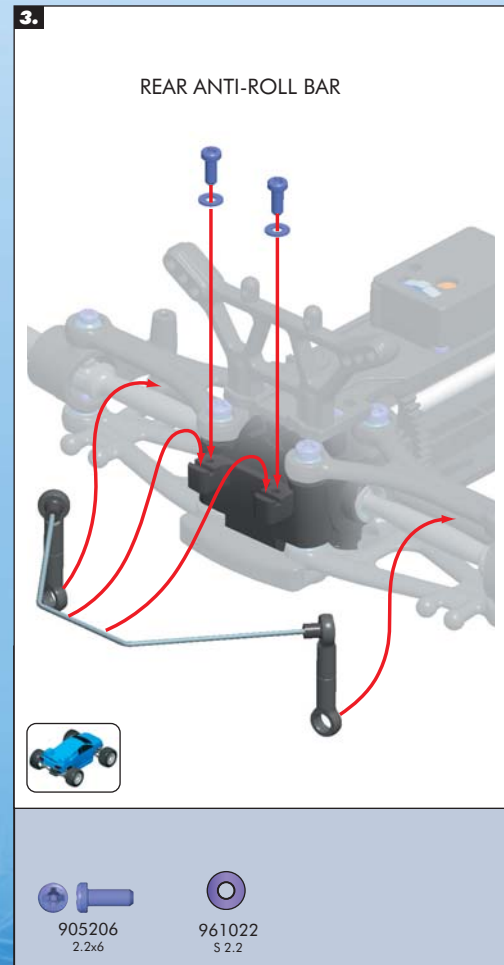
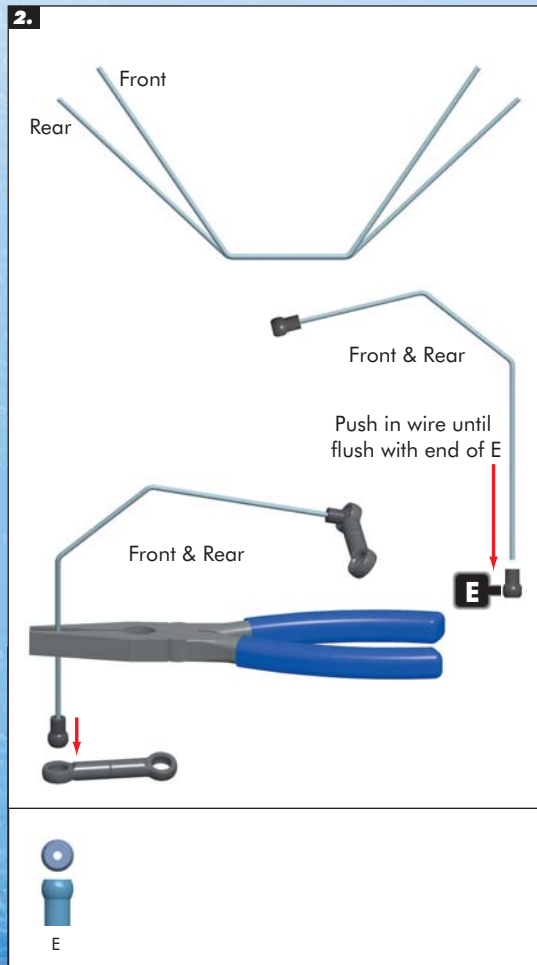
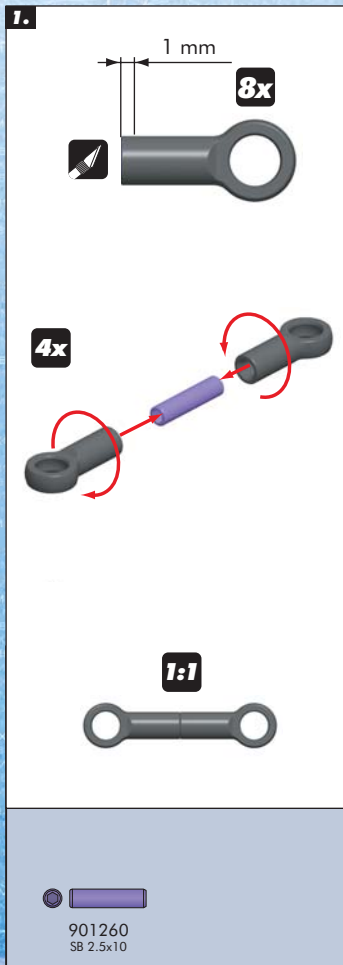

4.

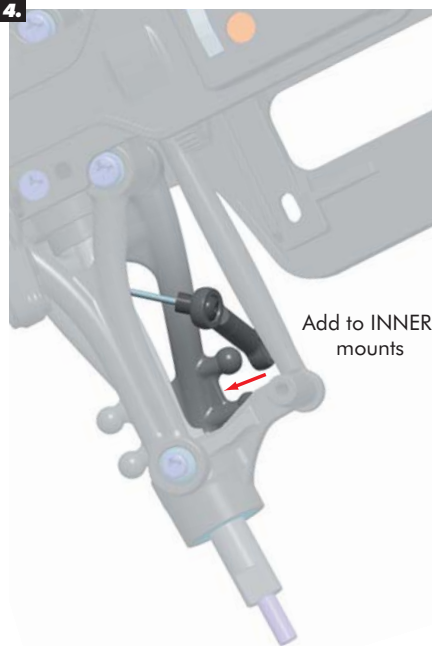

Add to INNER  
mounts

REAR ANTI-ROLL BAR  
FINAL ASSEMBLY



5.

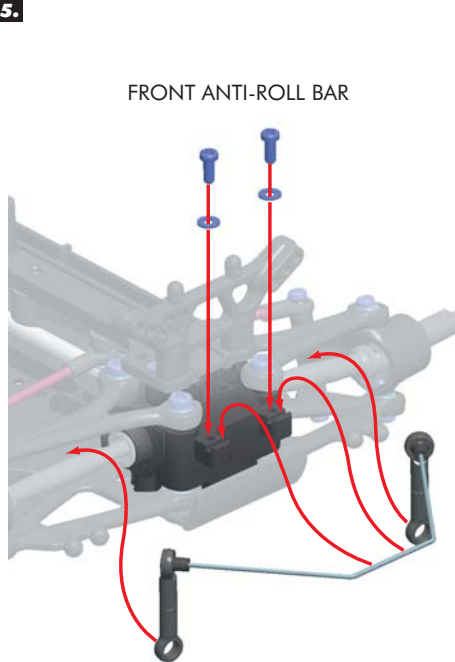

FRONT ANTI-ROLL BAR



905206  
2.2x6



961022  
S 2.2



6.

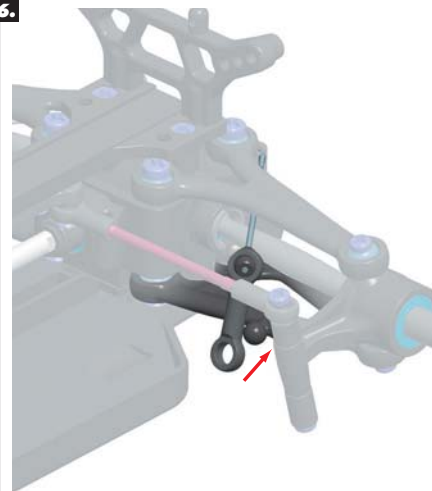

FRONT ANTI-ROLL BAR  
FINAL ASSEMBLY



7.

INITIAL POSITIONS

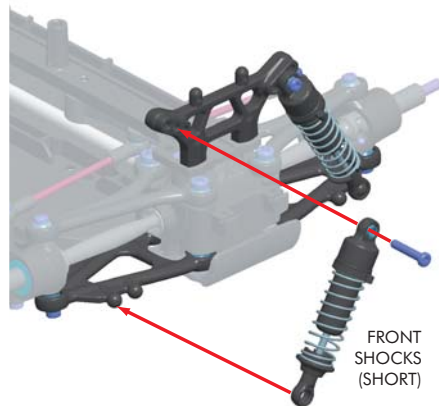

FRONT  
SHOCKS  
(SHORT)



905210  
2.2x10

8.

INITIAL POSITIONS

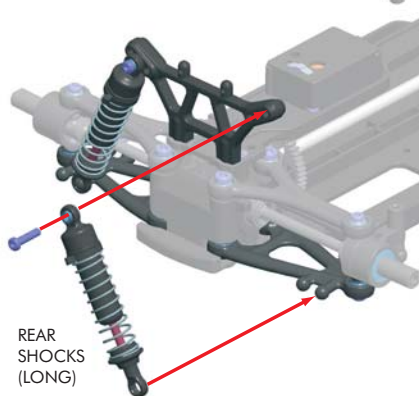

REAR  
SHOCKS  
(LONG)



905210  
2.2x10

9.



Use servo horn  
for your servo.

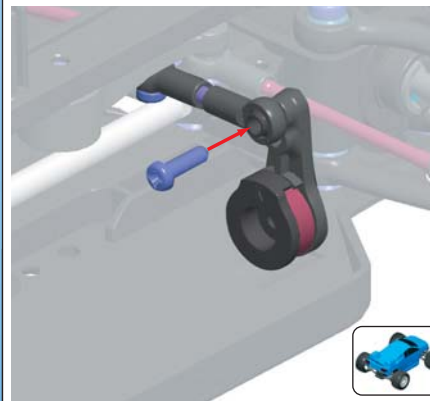

905208  
2.2x8



10.

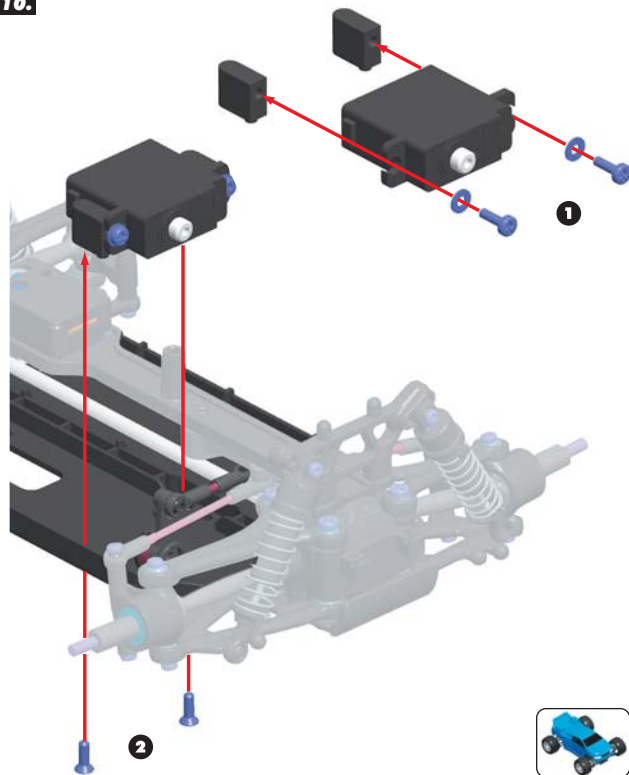

905258  
2.5x8



961025  
S 2.5

11.

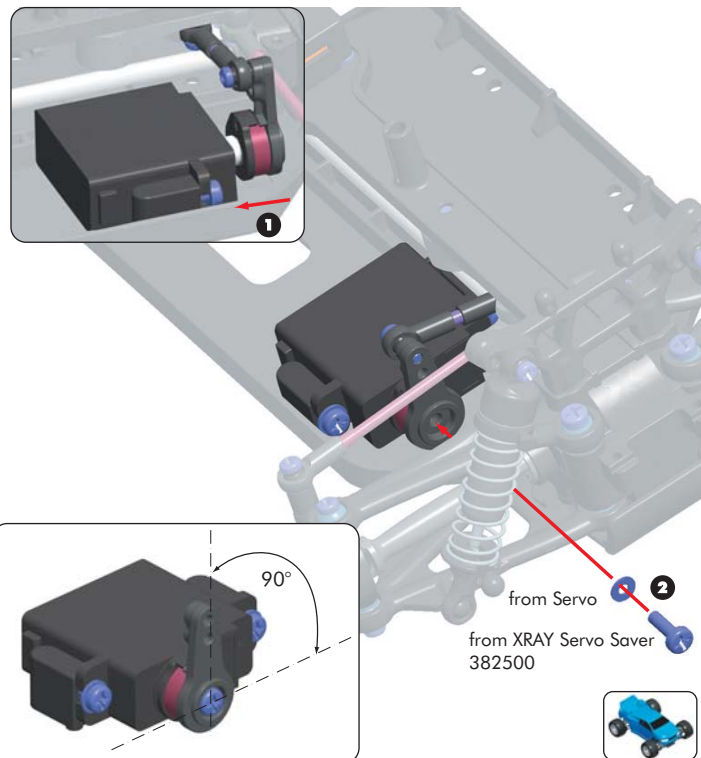

12.

USE 300 MICRO MOTOR

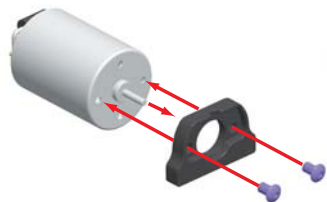

TIGHTEN  
GENTLY

11 T

**TIP**

USE XRAY 300 MICRO  
MOTOR INCLUDED  
IN XRAY M18T POWER  
PACK #389102

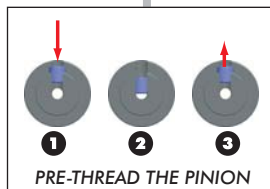

PRE-THREAD THE PINION



ASSEMBLED VIEW



907306  
3x6



901303  
SB M3x3

13.

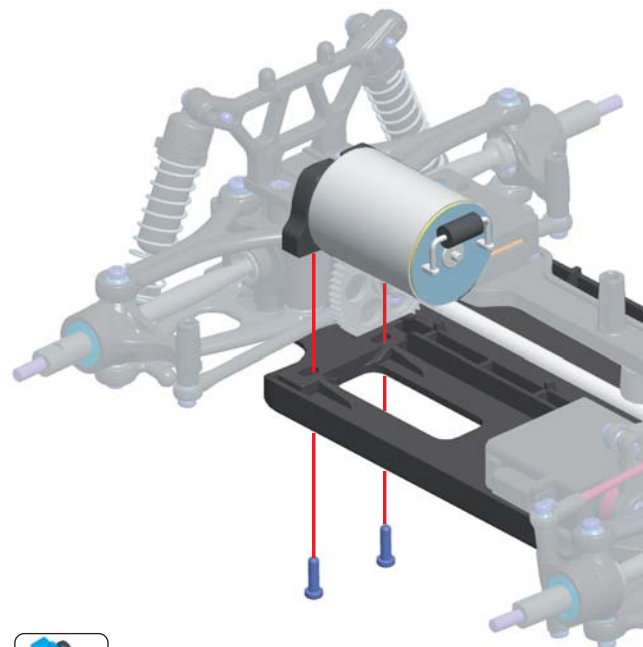

905258  
2.5x8

# TECH TIP

THE MOTOR STAND IS ADJUSTABLE:

1. RELEASE SCREWS FROM THE BOTTOM OF CHASSIS
2. MOVE THE MOTOR STAND AS NEEDED
3. TIGHTEN THE SCREWS

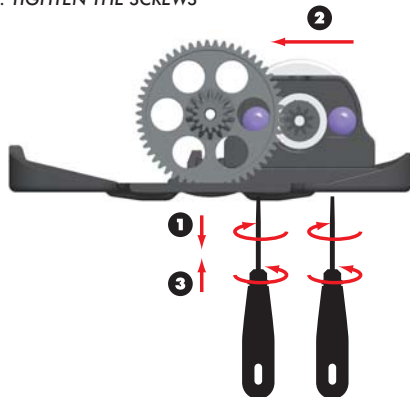

ADJUST MOTOR STAND SO GEARS MESH SMOOTHLY



INTERNAL RATIO 1:2.5

SPUR GEAR		PINION GEAR	FINAL RATIO
54	x	09	15.00
	x	10	13.50
	x	11	12.27
	x	12	11.25
	o	13	10.38
	o	14	09.64

x - INCLUDED WITH KIT  
o - AVAILABLE OPTION



To change pinion gears, first remove your motor along with the old pinion gear. Install the new pinion gear and re-install your motor. When installing the two 2x8mm button head screws to secure the motor mount to the chassis, do not fully tighten them. Leave them just loose enough so you can slide the motor in and out towards the spur gear. Make sure there is sufficient space between spur gear and pinion to allow for a small amount of backlash so the gears do not bind, see the diagram. When you have the motor in this position, you may then fully tighten the motor mount screws. Always check the gear mesh one more time to confirm that the motor did not move when tightening the screws.

14.

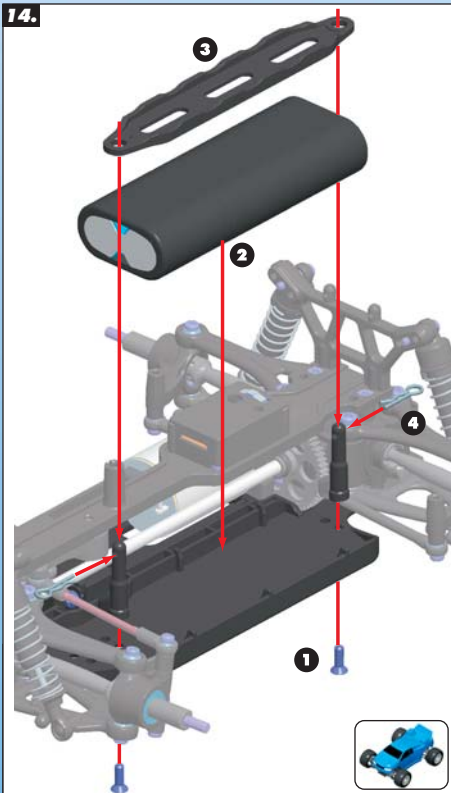

905258  
2.5x8

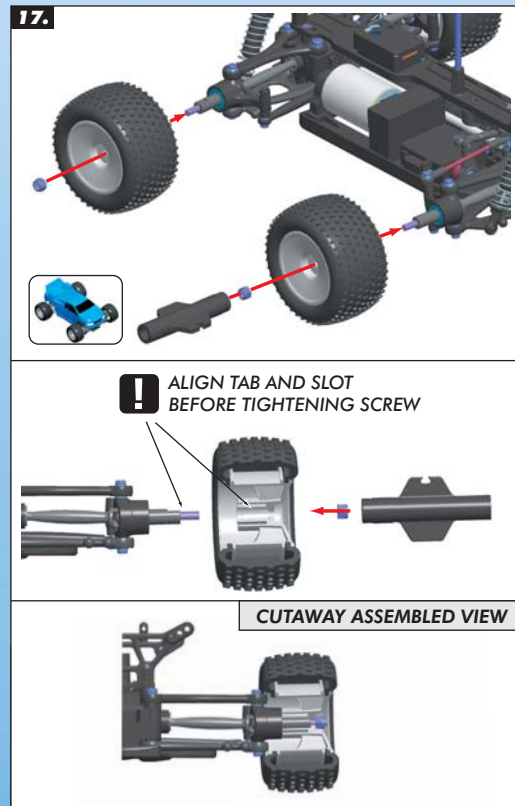
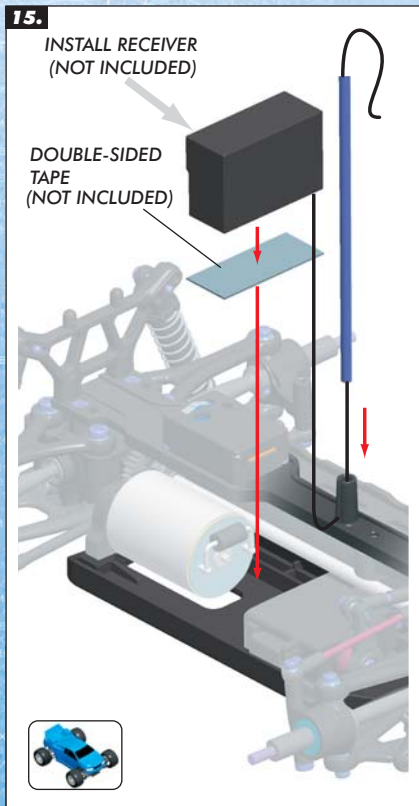

960030  
M3

## ELECTRONICS ASSEMBLY

M18T POWER PACK ASSEMBLY SHOWN

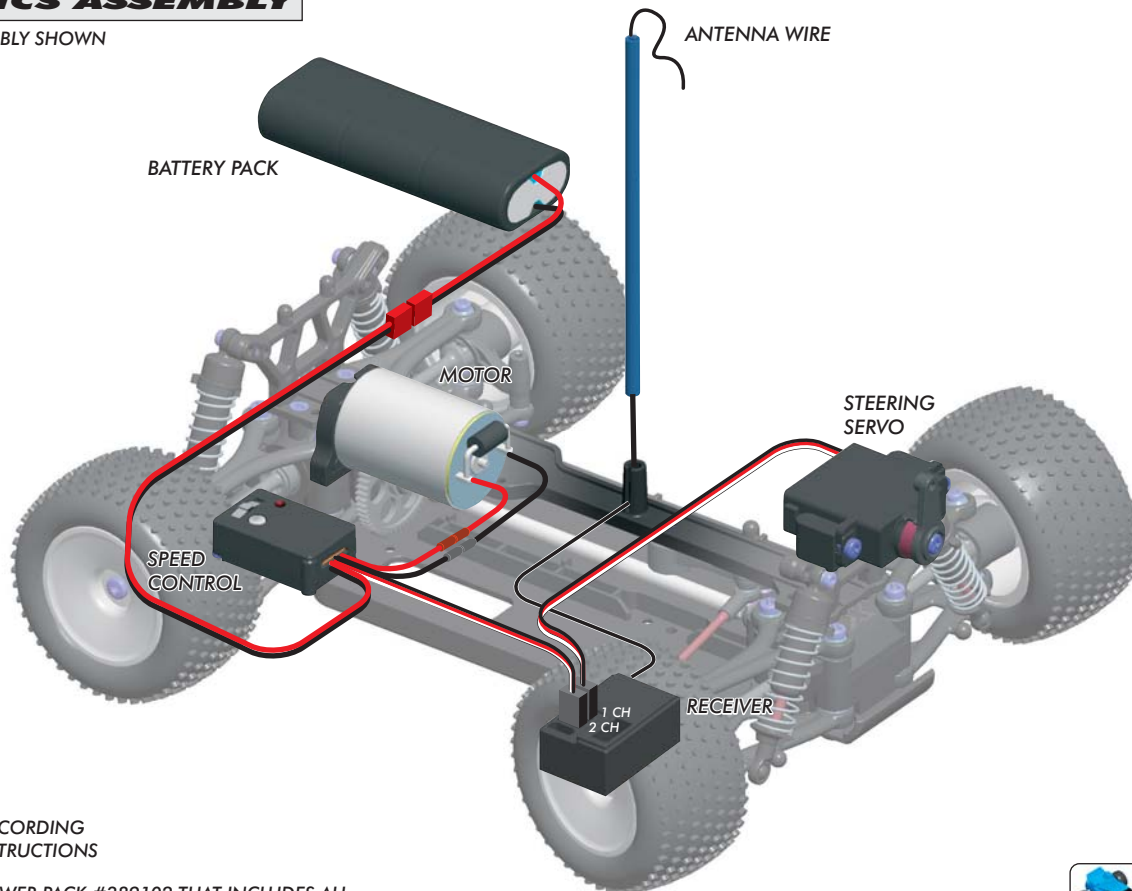

INSTALL ELECTRONICS ACCORDING  
TO MANUFACTURER'S INSTRUCTIONS



USE XRAY M18T POWER PACK #389102 THAT INCLUDES ALL  
ELECTRONICS REQUIRED FOR OPERATION. (RECEIVER & TRANSMITTER ARE NOT INCLUDED)





## BODY MOUNTING

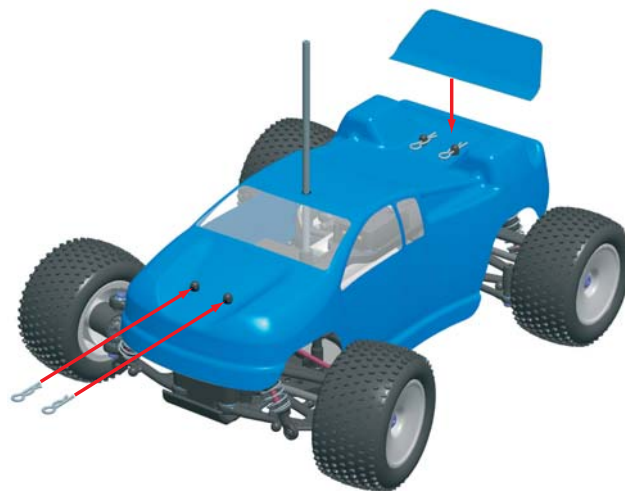
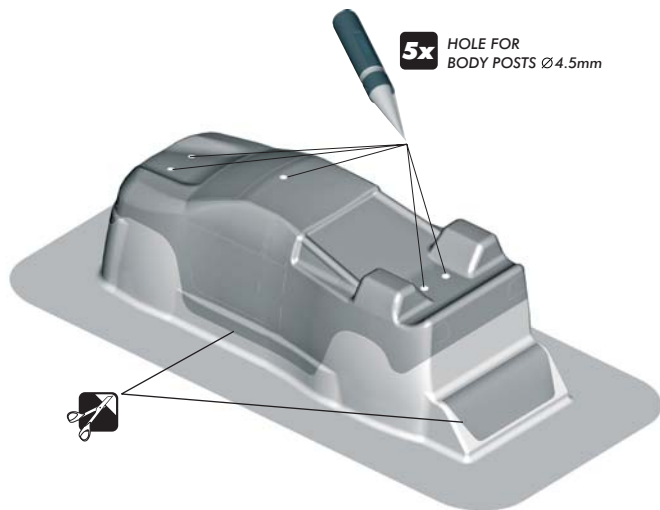

- 1** Before cutting and making holes on the body, put the unpainted body on the chassis to confirm the mounting position and location for holes and cutouts.
- 2** Carefully cut out the body using appropriate scissors or cutting tools.
- 3** Before painting, wash the inside of the body with mild detergent, and then rinse and dry thoroughly.
- 4** Mask all windows.
- 5** Apply paint masks as appropriate.
- 6** Paint the body using paints formulated for polycarbonate bodies.
- 7** When the paint is dry, remove the masking.
- 8** When you have finished painting, peel off the external protective films.



## IMPORTANT NOTES – GENERAL

- This product is not suitable for children except under the direct supervision of an adult.
- Carefully read all manufacturers warnings and cautions for any parts used in the construction and use of your model.
- Assemble this kit only in places away from the reach of very small children.
- First-time builders should seek advice from people who have building experience in order to assemble the model correctly and to allow the model to reach its performance potential.
- Exercise care when using tools and sharp instruments.
- Take care when building, as some parts may have sharp edges.
- Keep small parts out of reach of small children.
- Immediately after using your model, do NOT touch equipment on the model such as the engine and muffler, because they generate high temperatures. You may burn yourself seriously touching them.
- Follow the operating instructions for the radio equipment at all times.
- Do not put fingers or any objects inside rotating and moving parts, as this may cause damage or serious injury.
- Be sure that your operating frequency is clear before turning on or running your model, and never share the same frequency with somebody else at the same time. Ensure that others are aware of the operating frequency you are using and when you are using it.
- Always turn on your transmitter before you turn on the receiver in the car. Always turn off the receiver before turning your transmitter off.
- Keep the wheels of the model off the ground when checking the operation of the radio equipment.
- Disconnect the battery pack before storing your model.
- When learning to operate your model, go to an area that has no obstacles that can damage your model if your model suffers a collision.
- Remove any sand, mud, dirt, grass or water before putting your model away.
- If the model behaves strangely, immediately stop the model, check and clear the problem.

- To prevent any serious personal injury and/or damage to property, please be responsible when operating all remote controlled models.
- Do not use your model:
  - Near real cars, animals, or people that are unaware that an R/C car is being driven.
  - In places where children and people gather
  - In residential districts and parks
  - In limited indoor spaces
  - In wet conditions
  - In the street
  - In areas where where loud noises can disturb others, such as hospitals and residential areas.



## IMPORTANT NOTES – ELECTRICAL

- Insulate any exposed electrical wiring (using heat shrink tubing or electrical tape) to prevent dangerous short circuits.
- Use a recommended charger for the receiver and transmitter batteries and follow the instructions correctly. Over-charging, incorrect charging, or using inferior chargers can cause the batteries to become dangerously hot.
- Regularly check the charger for potential hazards such as damage to the cable, plug, casing or other defects. Ensure that any damage is rectified before using the charger again.
- Do not allow the transmitter batteries to become low on charge, otherwise you risk losing control of the model.
- Do not allow any metal part to short circuit the receiver batteries or other electrical/electronic device on the model.

## SAFETY PRECAUTIONS

The M18T is a high competition, high quality, 1/18-scale micro truck for persons age 16 and older. This is not a toy, it is a precision racing model. This model racing car is not intended for use by children without direct supervision of a responsible, knowledgeable adult. Contents of box may differ from pictures. In line with our policy of continuous product development, the exact specifications of the kit may vary without prior notice. This product contains a chemical known to the State of California to cause cancer and birth defects or other reproductive harm

Take enough safety precautions prior to operating this model. You are responsible for this model's assembly and safe operation! Please read the instruction manual before building and operating this model and follow all safety precautions. This product contains a chemical known to the State of California to cause cancer and birth defects or other reproductive harm. Always keep the instruction manual at hand for quick reference, even after completing the assembly. Use only genuine and original authentic Xray parts for maximum performance. Using any third party parts on this model will void warranty immediately.

## WARRANTY:

XRAY guarantees this model kit to be free from defects in both material and workmanship within 30 days of purchase. The total monetary value under warranty will in no case exceed the cost of the original kit purchased. This warranty does not cover any components damaged by use or modification or as a result of wear. Part or parts missing from this kit must be reported within 30 days of purchase. No part or parts will be sent under warranty without proof of purchase. Should you find a defective or missing part, contact the local distributor. Service and customer support will be provided through local hobby store where you have purchased the kit, therefore make sure to purchase any XRAY products at your local hobby store.

This model racing car is considered to be a high performance off-road racing vehicle. As such this vehicle will be used in an extreme range of conditions and situations, all which may cause premature wear or failure of any component.

XRAY has no control over usage of vehicles once they leave the dealer, therefore XRAY can only offer warranty against all manufacturer's defects in materials, workmanship, and assembly at point of sale and before use. No warranties are expressed or implied that cover damage caused by what is considered normal use, or cover or imply how long any model cars' components or electronic components will last before requiring replacement.

Due to the high performance level of this model car you will need to periodically maintain and replace consumable components.

Improper operations may cause personal and/or property damage. XRAY and its distributors have no control over damage resulting from shipping, improper construction, or improper usage. XRAY assumes and accepts no responsibility for personal and/or property damages resulting from the use of improper building materials, equipment and operations. By purchasing any item produced by XRAY, the buyer expressly warrants that he/she is in compliance with all applicable federal, state and local laws and regulation regarding the purchase, ownership and use of the item. The buyer expressly agrees to indemnify and hold harmless XRAY for all claims resulting directly or indirectly from the purchase, ownership or use of the product. By the act of assembling or operating this product, the user accepts all resulting liability. If the buyer is not prepared to accept this liability, then he/she should return this kit in new, unassembled, and unused condition to the place of purchase.

Any and all warranty coverage will not cover replacement of any part or component damaged by neglect, abuse or improper or unreasonable use. This includes but is not limited to damage from crashing, chemical and/or water damage, excessive moisture, improper or no maintenance, or user modifications which compromise the integrity of components. Warranty will not cover components that are considered consumable on RC vehicles.

XRAY does not pay nor refund shipping on any component sent to XRAY or its distributors for warranty.

XRAY reserves the right to make the final determination of the warranty status of any component or part.

## Limitations of Liability:

XRAY makes no other warranties expressed or implied.

XRAY shall not be liable for any loss, injury or damages, whether direct, indirect, special, incidental, or consequential, arising from the use, misuse, or abuse of this product and/or any product or accessory required to operate this product. In no case shall XRAY's liability exceed the monetary value of this product.

### #38 0595 MICRO MONSTER TRUCK CONVERSION SET

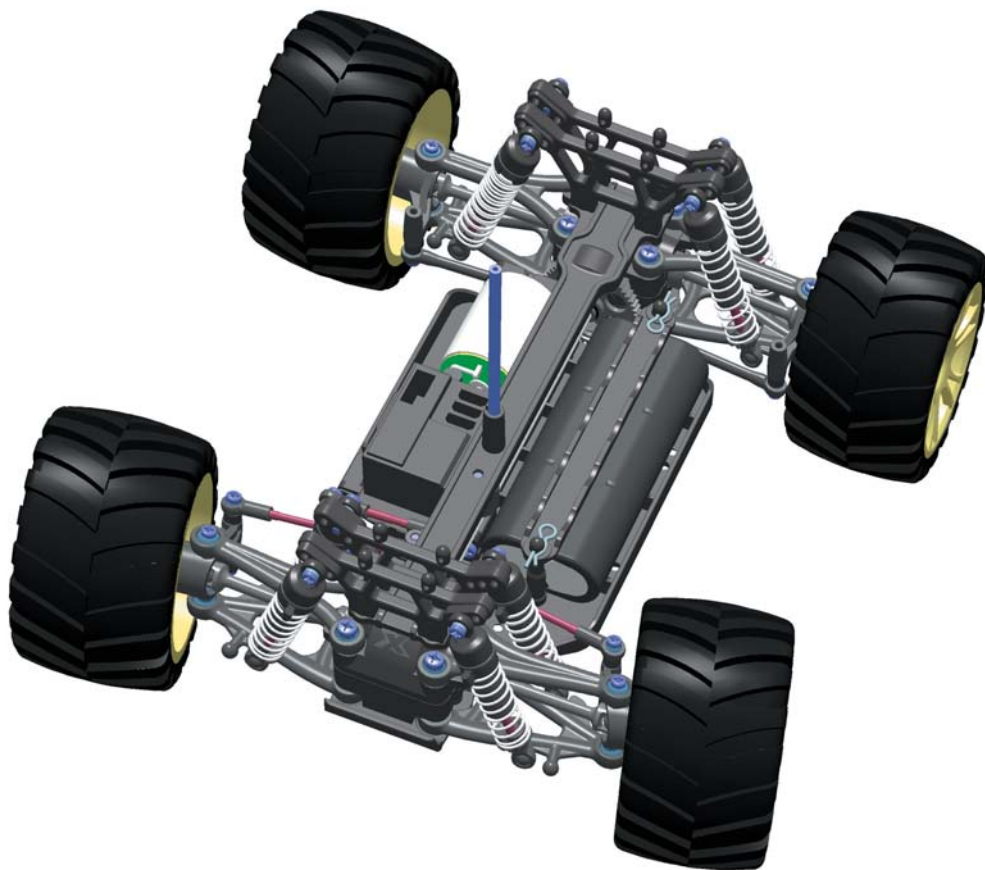



[www.teamxray.com](http://www.teamxray.com)



**XRAY MODEL RACING CARS**  
P.O.BOX 103, 911 50 TRENČÍN, SLOVAKIA, EUROPE

