

#382252 & #382262 ALU SUSPENSION BLOCK LEFT & RIGHT

XRAY M18

To install the aluminum suspension blocks on the M18 follow these steps and use the appropriate screws as indicated. Please note that the front left suspension block will be mounted on the right in rear. The front right suspension block will be mounted on the left in rear.

FRONT SUSPENSION

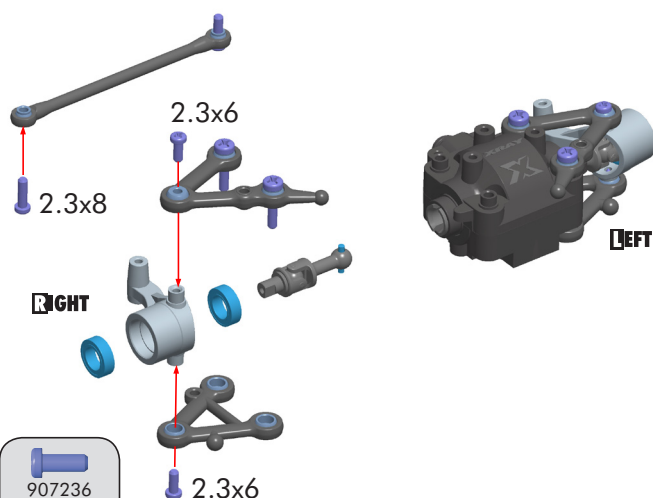

907236
2.3x6
907238
2.3x8



REAR SUSPENSION

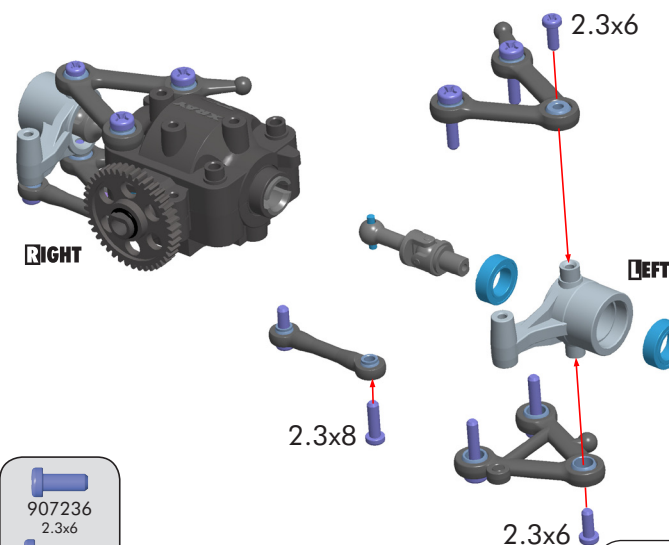

907236
2.3x6
907238
2.3x8



XRAY M18T

To install the aluminum suspension blocks on the M18T follow these steps and use the appropriate screws as indicated. Please note that the front left suspension block will be mounted on the right in rear. The front right suspension block will be mounted on the left in rear.

FRONT SUSPENSION

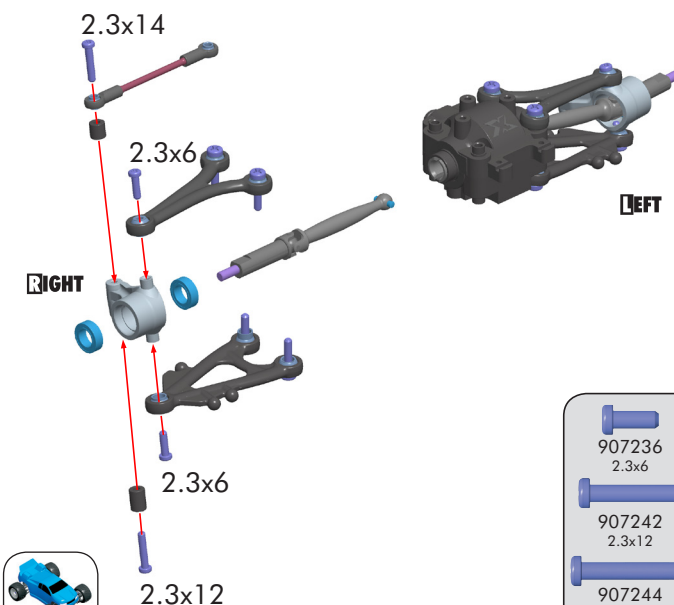

907236
2.3x6
907242
2.3x12
907244
2.3x14

REAR SUSPENSION

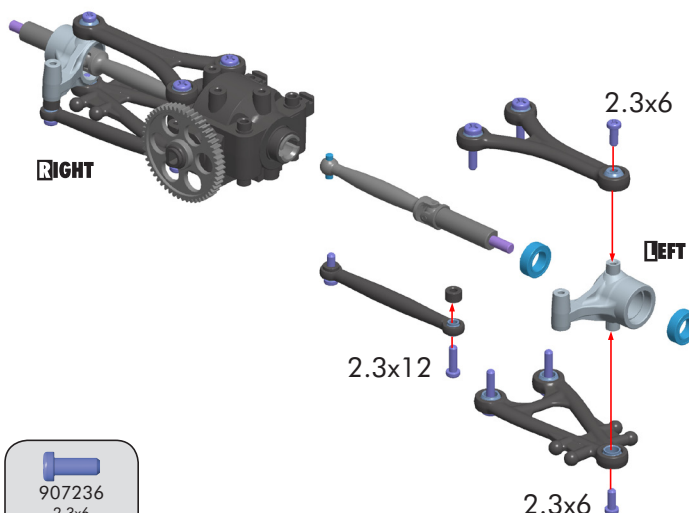

907236
2.3x6
907242
2.3x12

