

! NOTE
ORIENTATION

INSTALLATION DETAIL

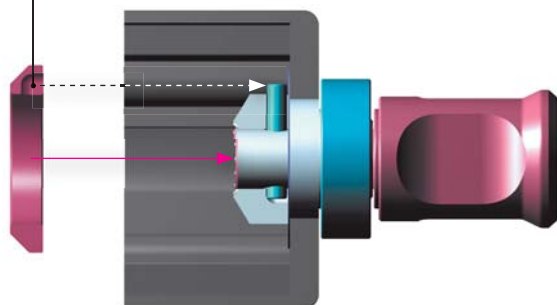

INSTALLED

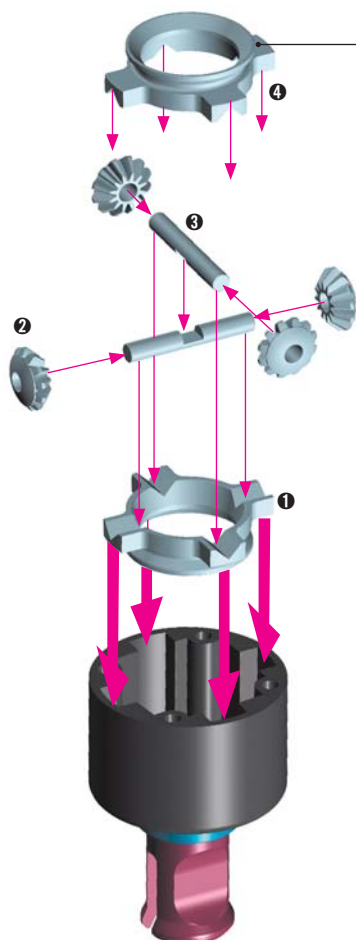
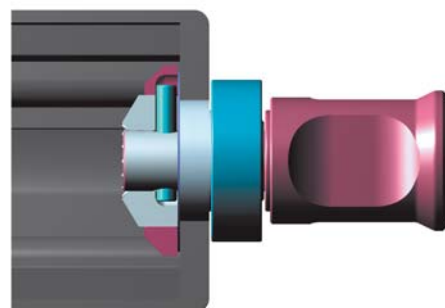

SEGMENT	DESCRIPTION	WHEN TO USE
90°	The standard 90° segment provides a very good balance of performance between on- and off-power. On-power the diff becomes hard after a brief delay. Off-power the diff becomes free after a brief delay.	Suggested to use for high grip and/or bumpy track.
120°	The optional 120° segment gives more immediate response both on- and off-power. On-power the diff becomes very hard immediately (no delay). Off-power the diff becomes free immediately (no delay).	Suggested to use for slippery and/or flat track.

XRAY PREMIUM SILICONE OILS

FOR SLIPPERY TRACK	FOR NORMAL GRIP	FOR HIGH GRIP TRACK
3.000 to 5.000	7.000	10.000 to 30.000
#359301 - 1.000 cSt	#359307 - 7.000 cSt	#359310 - 10.000 cSt
#359302 - 2.000 cSt		#359320 - 20.000 cSt
#359303 - 3.000 cSt		#359330 - 30.000 cSt
#359305 - 5.000 cSt		

ASSEMBLED



OIL FILLING

Fill in the XRAY Premium Silicone Oil to the top of the segment





903310
SFH M3x10

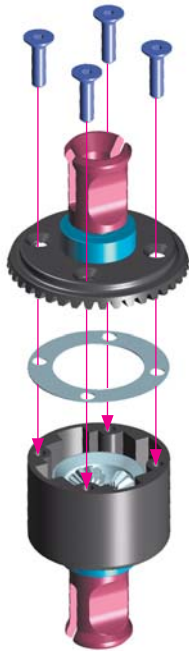

Tight the screws equally



Finish tightening in this order

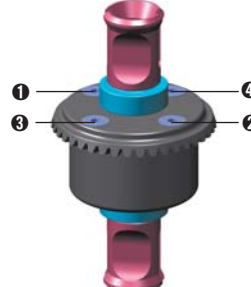

After assembly the differential should have a length of 32.15~32.30mm measured from the ends of the installed ball-bearings. If differentials are longer, retighten the 4 screws holding the crown gear.

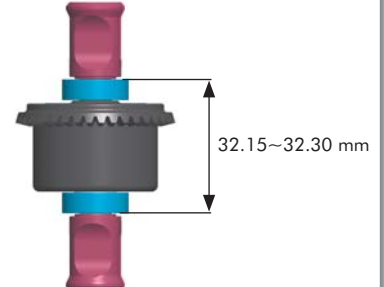

GEAR MESH ADJUSTMENT

In the event that the diff has too tight or too loose gear mesh between the diff spur gear and the pinion drive gear, this is easily resolved by inserting 1 or 2 thin shims behind a diff outdrive ball-bearing, depending on how much play there is.

THE LOCATION OF THE SHIM(S) DEPENDS ON WHETHER YOU ARE TRYING TO CLOSE OR OPEN THE GAP.

Note that to install the shim(s) you must disassemble the diff, install the shim(s), reassemble the diff, and check the gear mesh again.

TO CLOSE A WIDE GAP

insert shim(s) here

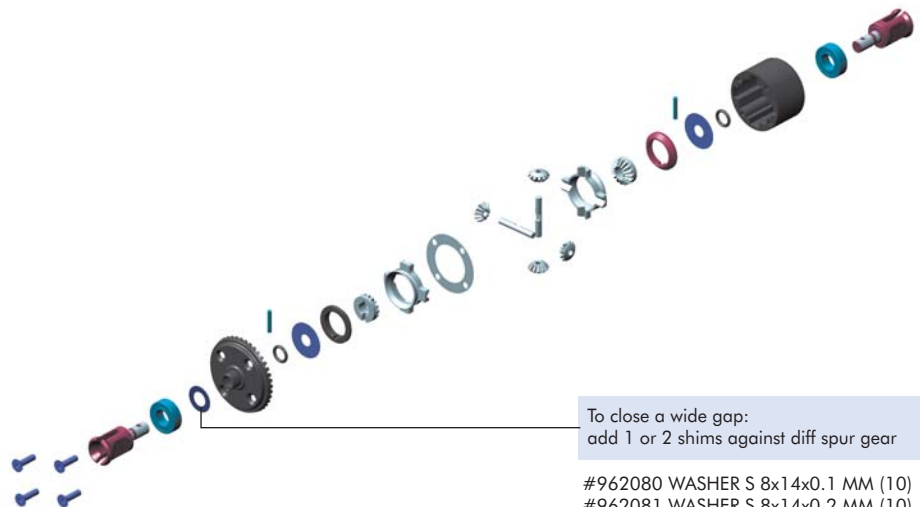
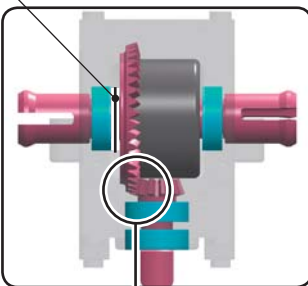

To close a wide gap:
add 1 or 2 shims against diff spur gear

#962080 WASHER S 8x14x0.1 MM (10)
#962081 WASHER S 8x14x0.2 MM (10)

TO OPEN A NARROW GAP

insert shim(s) here

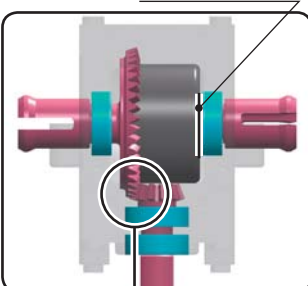

To open a narrow gap:
add 1 or 2 shims on the other side of the diff,
away from spur gear

#962080 WASHER S 8x14x0.1 MM (10)
#962081 WASHER S 8x14x0.2 MM (10)