

This Supplementary Sheet highlights and explains correct building information and you should refer to them while building your XB808 kit.

## 2. FRONT & REAR TRANSMISSION

PAGE 10,11

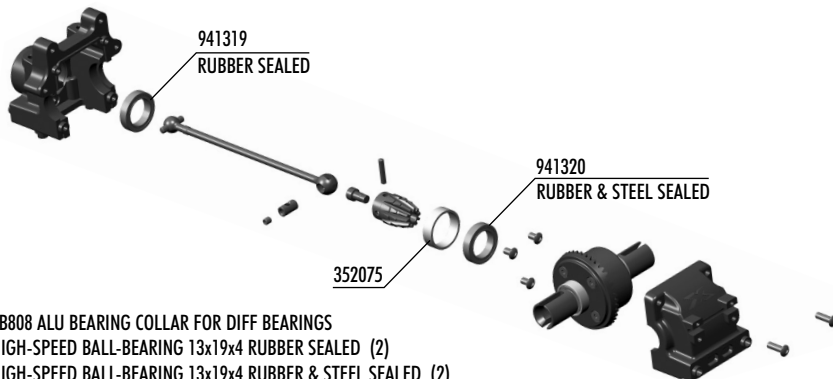

- 352075 XB808 ALU BEARING COLLAR FOR DIFF BEARINGS  
 941319 HIGH-SPEED BALL-BEARING 13x19x4 RUBBER SEALED (2)  
 941320 HIGH-SPEED BALL-BEARING 13x19x4 RUBBER & STEEL SEALED (2)

## 2. FRONT & REAR TRANSMISSION

PAGE 10,11 STEP 1,2

### 1 step

**TIP** Use HUDY Ball-Bearing Grease for servicing:

- #106220 - Standard
- #106221 - Extra
- #106222 - Premium



**TIP** Follow the TECH TIP on page 5 for drive shaft pin servicing

#### STEP 1 DETAIL



Use 1.5mm Allen wrench

#### STEP 1 DETAIL

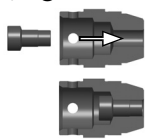

Graphite Grease (HUDY #106210)

**TIP** Replace this pin when wear is present

**NOTE ORIENTATION**  
 Install the ball-bearing with the STEEL seal facing inside the housing as shown.

### 2 step

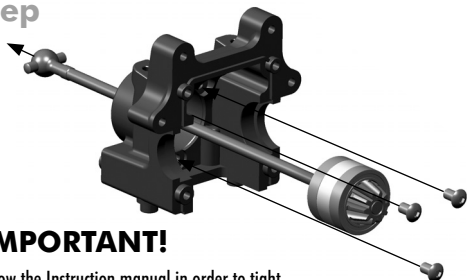

**IMPORTANT!**

Please follow the Instruction manual in order to tight the screws correctly.

**NOTE ORIENTATION**  
 Steel seal



CUTAWAY VIEW