

### PINION GEAR ASSEMBLY FOR 3 BEARINGS

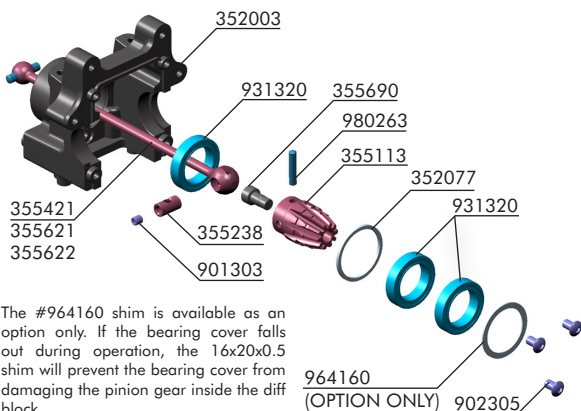

The #964160 shim is available as an option only. If the bearing cover falls out during operation, the 16x20x0.5 shim will prevent the bearing cover from damaging the pinion gear inside the diff block.

964160  
(OPTION ONLY)

902305

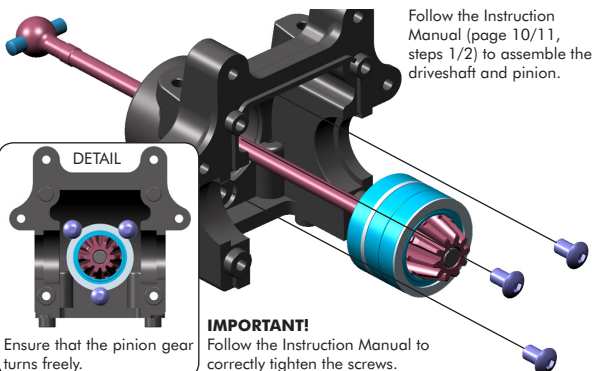

Follow the Instruction Manual (page 10/11, steps 1/2) to assemble the driveshaft and pinion.