

XB8

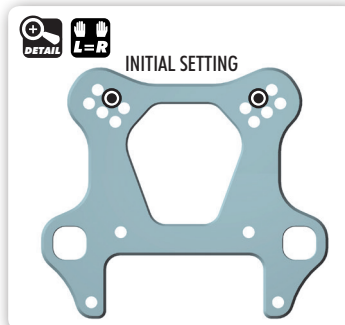
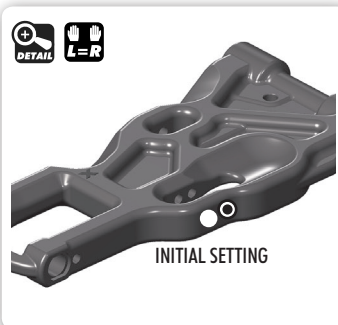
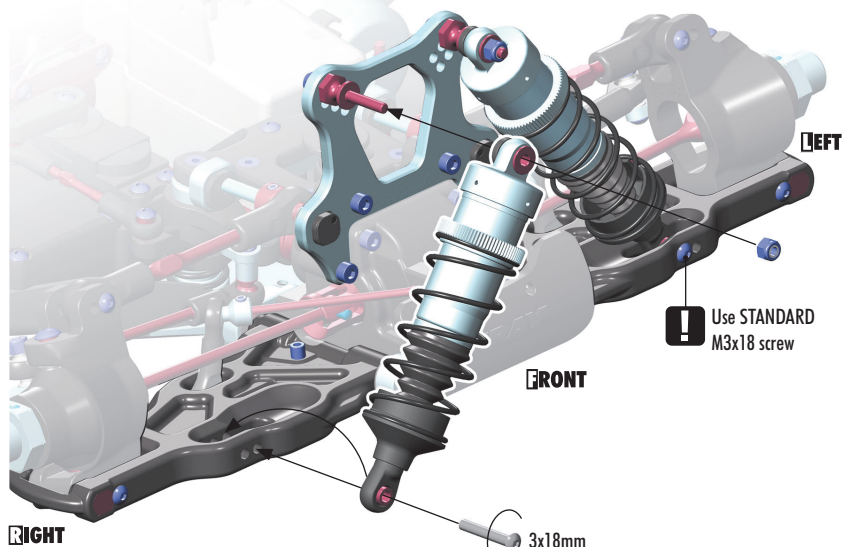

CUSTOMER SUPPORT

We have made every effort to make these instructions as easy to understand as possible. However, if you have any difficulties, problems, or questions, please do not hesitate to contact the XRAY support team at info@teamxray.com. Also, please visit our Web site at www.teamxray.com to find the latest updates, set-up information, option parts, and many other goodies. We pride ourselves on taking excellent care of our customers.

You can join thousands of XRAY fans and enthusiasts in our online community at: www.teamxray.com

XRAY Europe
K Výstavisku 6992
91101 Trenčín
Slovakia, EUROPE
Phone: +421-32-7401100
Fax: +421-32-7401109
Email: info@teamxray.com

XRAY USA
RC America, 2030 Century Center Blvd #15 Irving,
TX 75062
USA
Phone: (800) 519-7221 * (214) 744-2400
Fax: (214) 744-2401
Email: xray@rcamerica.com

XRAY XB8/GTX8

#350907 C-hub Front Suspension Conversion Set

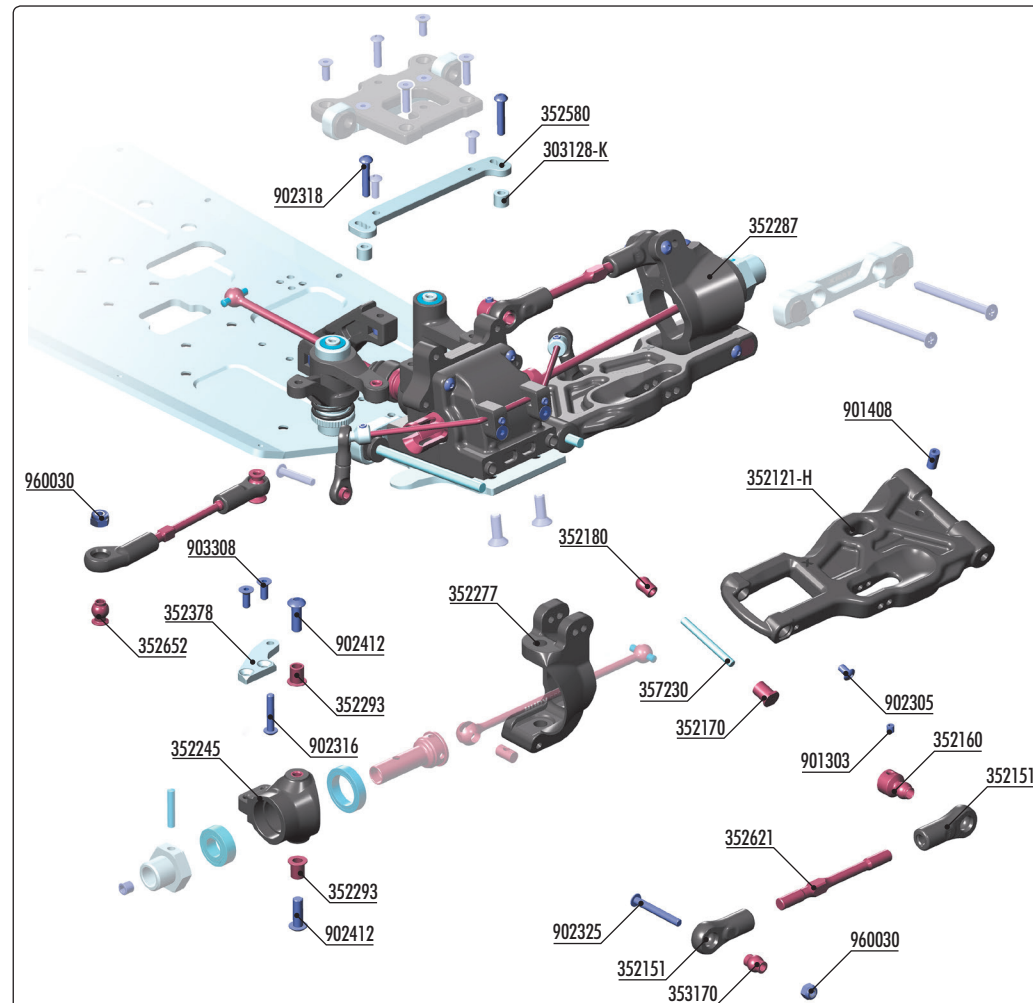

303128-K ALU SHIM 3x6x6MM (10)
352121-H COMPOSITE FRONT LOWER SUSPENSION ARM - HARD
352151 FRONT UPPER ARM BALL JOINT (2) - V2
352160 STEEL MOUNTING BALL 6.8MM (2)
352170 STEEL ECCENTRIC BUSHING 0° (2)
352180 BALL MOUNT (2)
352245 STEERING BLOCK
352277 COMPOSITE CASTER BLOCK 16° RIGHT
352287 COMPOSITE CASTER BLOCK 16° LEFT
352293 STEEL BUSHING FOR CASTER BLOCK (2)
352378 ALU STEERING PLATE - SWISS 7075 T6 (L+R)
352580 HEX SCREW SFH M3x8 (10)
352621 ADJ. TURNBUCKLE M5 L/R 58mm 2)

352652 BALL STUD 6.8MM (4)
353170 PIVOT BALL 6.8 (4)
357230 FRONT LOWER OUTER PIVOT PIN (2)
901303 HEX SCREW SB M3x3 (10)
901408 HEX SCREW SB M4x8 (10)
902305 HEX SCREW SH M3x5 (10)
902316 HEX SCREW SH M3x16 (10)
902318 HEX SCREW SH M3x18- (10)
902325 HEX SCREW SH M3x25 (10)
902412 HEX SCREW SH M4x12 (10)
903308 HEX SCREW SFH M3x8 (10)
960030 NUT M3 (10)



902308
SH M3x8

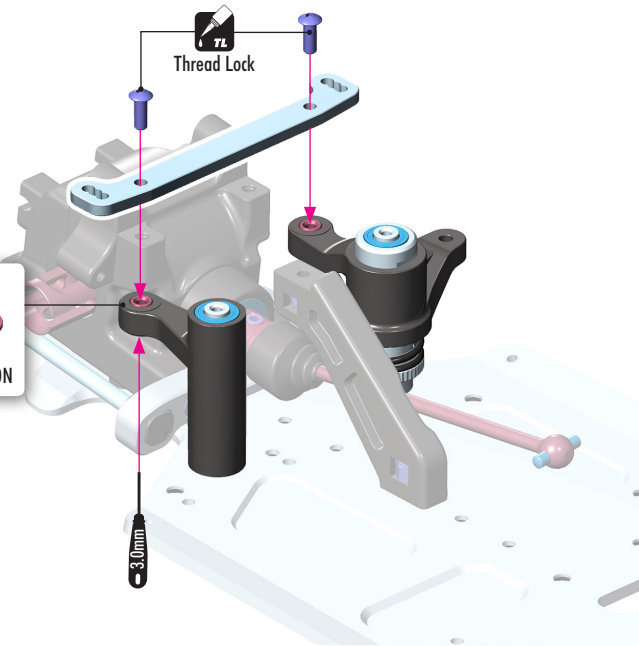
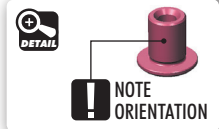

901504
SB M5x4



903308
SFH M3x8

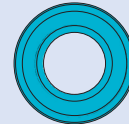

940816
BB 8x16x5



980317
P 3x17

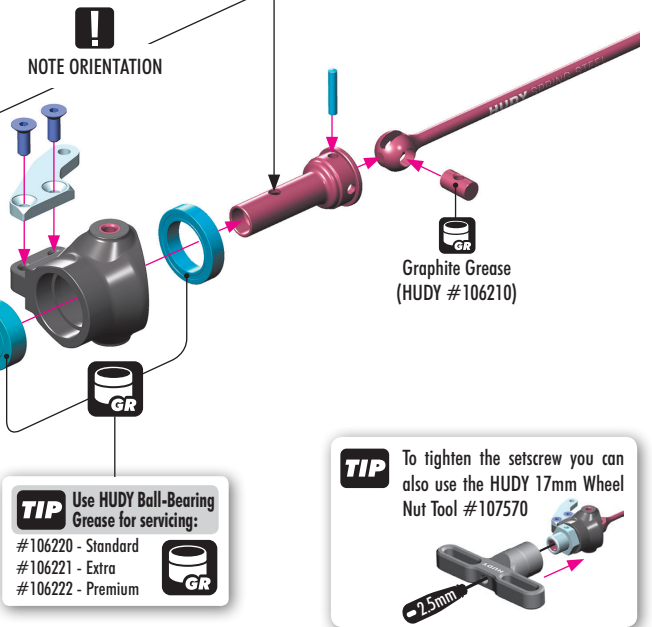

902312
SH M3x12



903312
SFH M3x12



903310
SFH M3x10

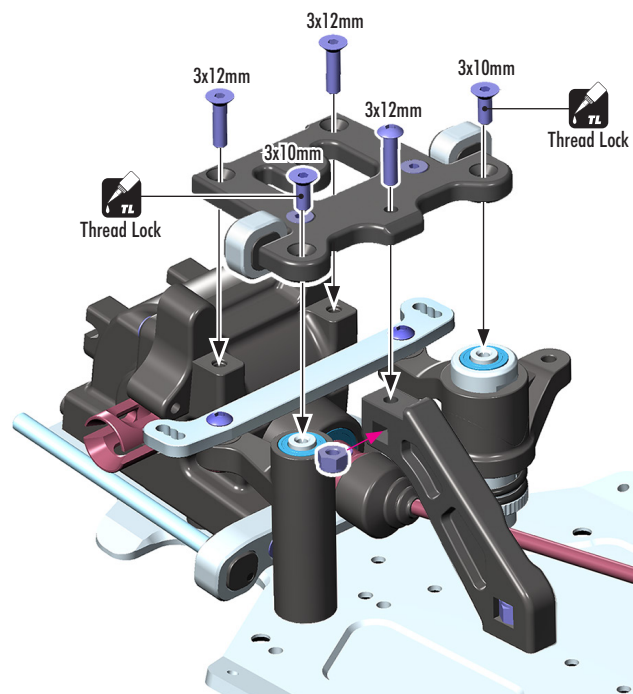

902412
SH M4x12

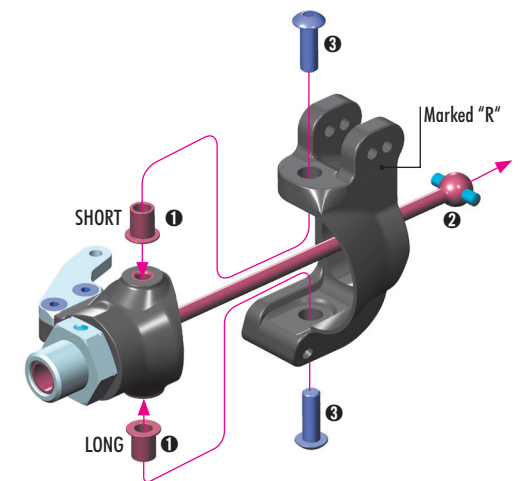

2x  L=R

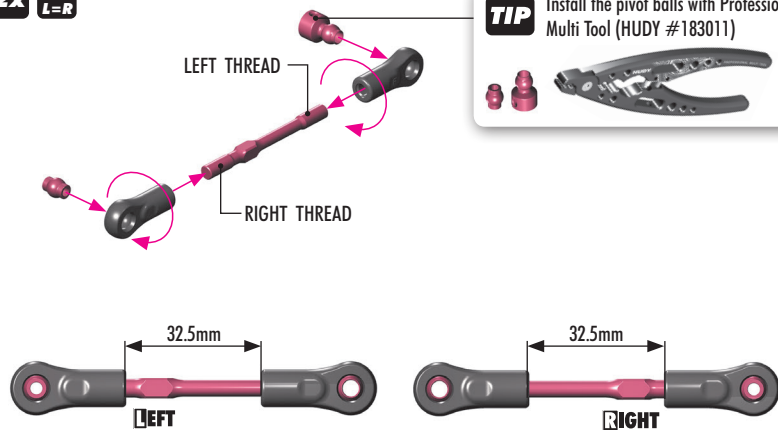

TIP Install the pivot balls with Professional Multi Tool (HUDY #183011)



901408
SB M4x8



902305
SH M3x5



902325
SH M3x25



960030
N M3

2x  L=R

  L=R

TOP DOWNSTOP SETTING

STEP 7 DETAIL **BOTTOM**

0.0mm

NOTE
ORIENTATION

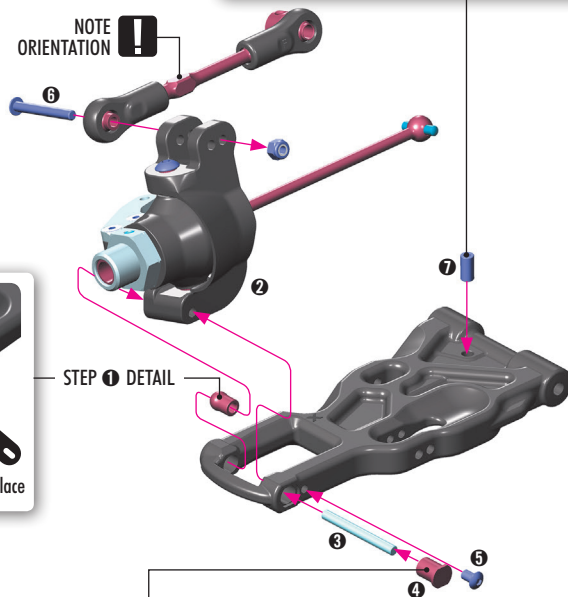



 



TIP Press pivot ball into arm until it snaps into place

 **OPTION**

ECCENTRIC BUSHINGS

#352170	0° - STEEL		INCLUDED
#352174	1° - STEEL		OPTION
#352175	2° - STEEL		OPTION



901303
SB M3x3



909395
SS 3.5x45

  L=R

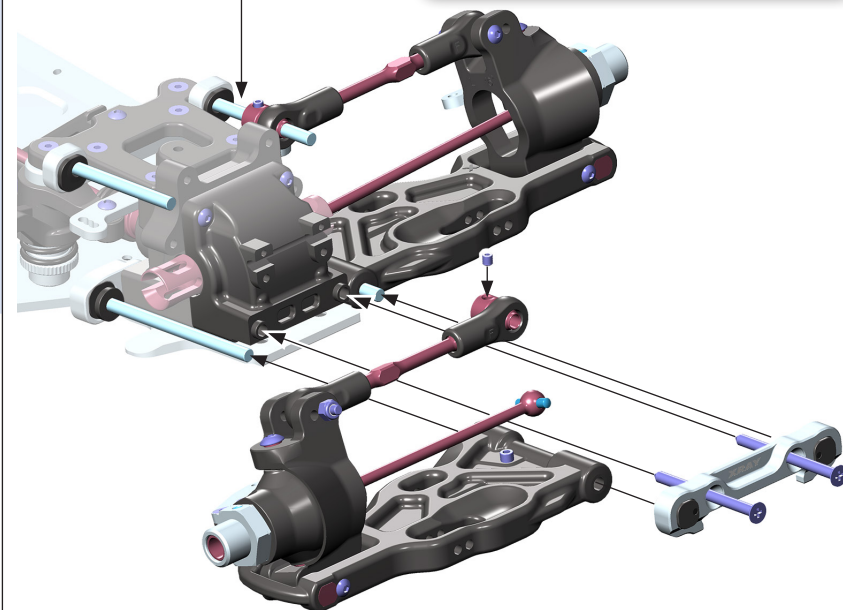
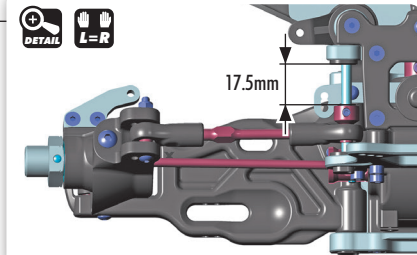

902312
SH M3x12



908312
SCH M3x12

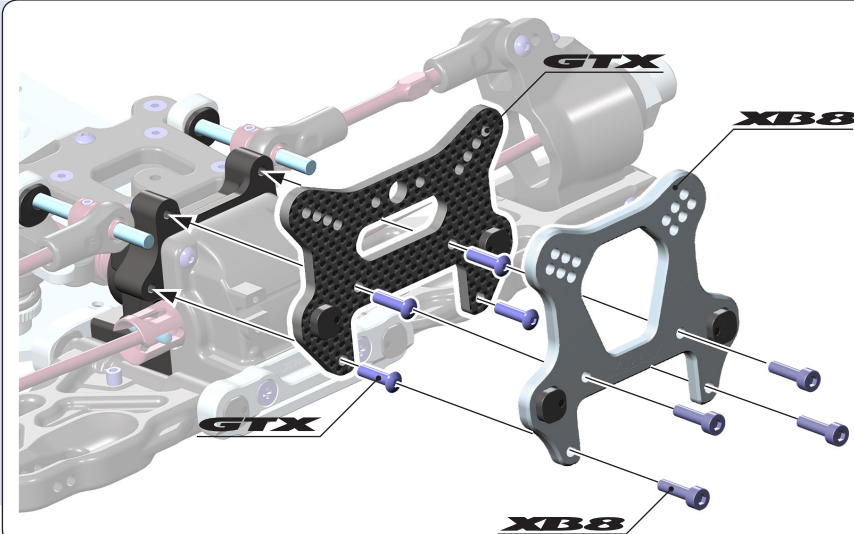

901303
SB M3x3

901305
SB M3x5

902318
SH M3x18

903308
SFH M3x8

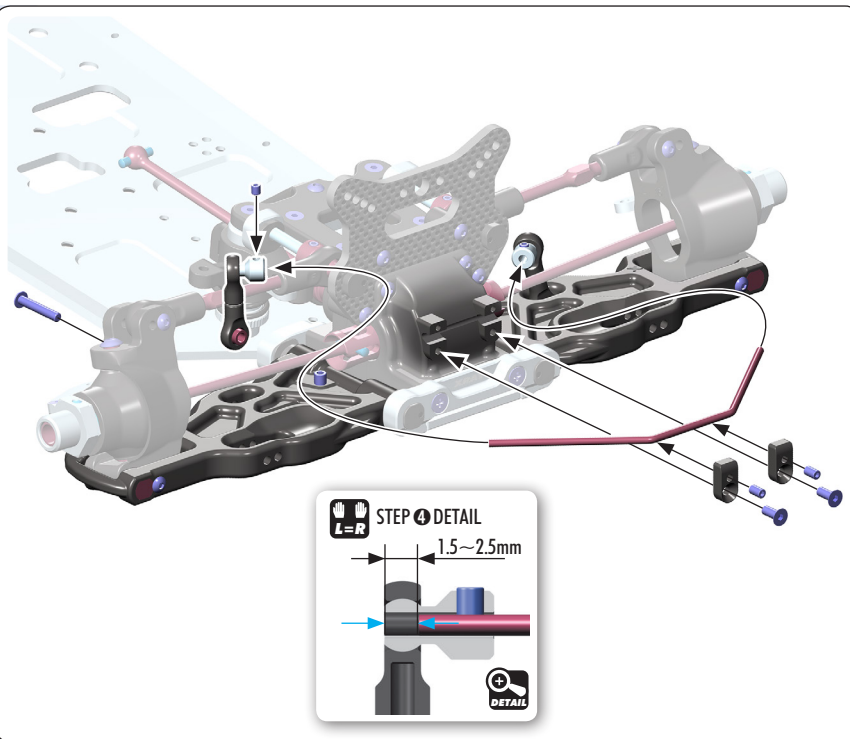

303128-K
SHIM 3x6x6

902318
SH M3x18

960030
N M3

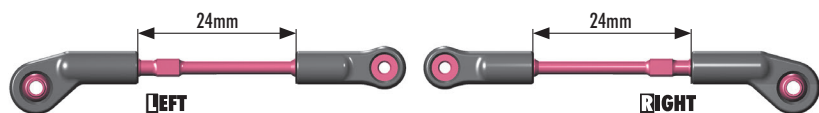
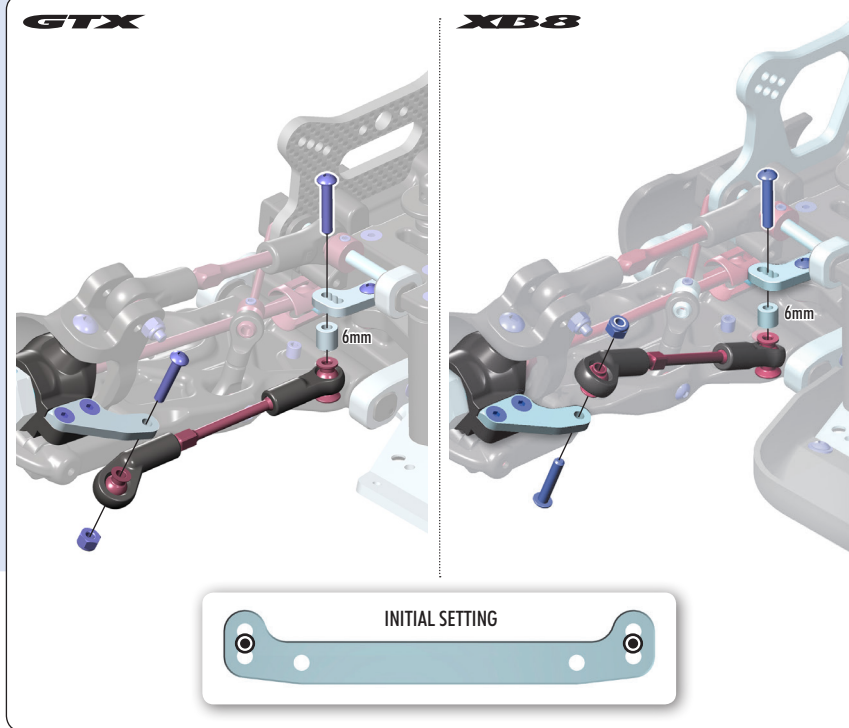

902318
SH M3x18

960030
N M3

