

XRAY T2R

INSTRUCTION MANUAL SUPPLEMENTARY SHEET

Use this T2R Supplementary Instruction Sheet along with the standard T2 instruction manual included in the kit. This Supplementary Sheet highlights and explains new updated steps and you should refer to them while building your T2R kit. Each step in this Supplementary Sheet indicates the section to which the updated step refers.

2006 New and Improved Parts

All of these parts are new or updated from the previous versions. Each of these parts feature their corresponding part number which can be used to re-order the parts. You can also refer to the complete exploded views.



#301168 T2R FRP UPPER DECK



#303088 T2R FRP SHOCK TOWER FRONT



#303038 T2R FRP REAR UPPER DECK



#302088 T2R FRP SHOCK TOWER REAR



#301118 T2R FRP CHASSIS



#305355 T2 COMPOSITE WHEEL HUB (2)



#960140 NUT M4 WITH FLANGE (10)



#930128 CARBIDE BALL-BEARING AXIAL 2.8 x 6.5 x 0.8



#305052 DIFF PULLEY 34T WITH COVERS



#305005 COMPOSITE BALL DIFF - SET



#305083 D-LOCK DIFF WASHER - D 17 x 23 x 1 (2)

1. BALL DIFFERENTIAL

PAGE 6

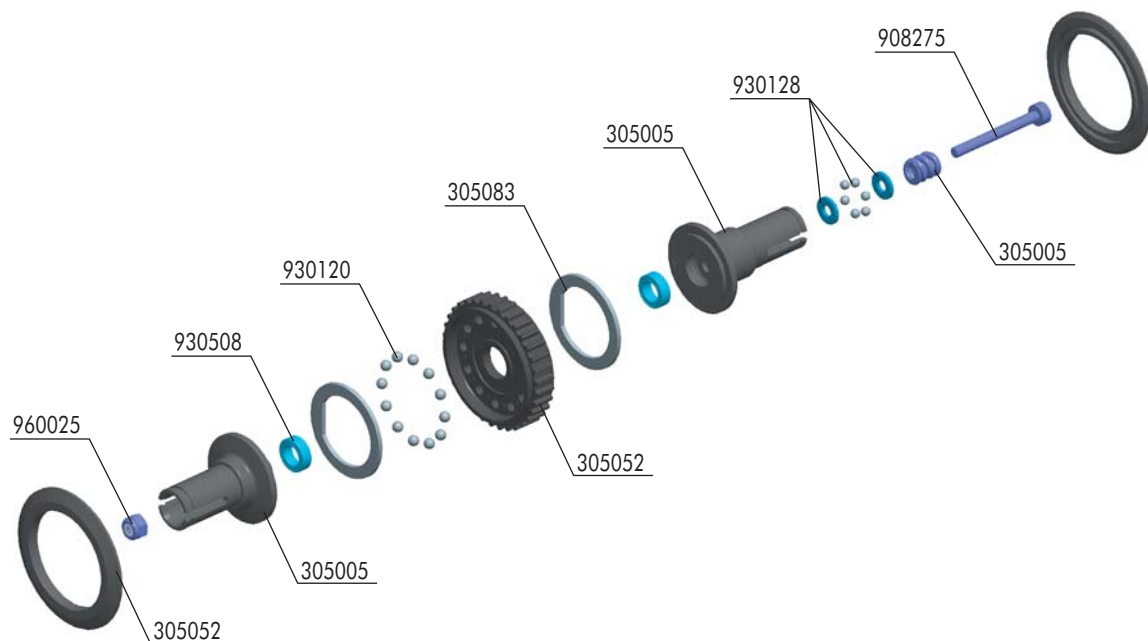

BAGS

01

2x

30 5005 COMPOSITE BALL DIFFERENTIAL - SET
30 5052 DIFF PULLEY 34T WITH COVERS
30 5083 D-LOCK DIFF WASHER - D 17 x 23 x 1 (2)

90 8275 HEX SCREW SOCKET HEAD CAP M2.5x25 (10)
93 0120 CARBIDE BALL 2.4MM (12)
93 0128 CARBIDE BALL-BEARING AXIAL 2.8x6.5x0.8
93 0508 BALL-BEARING MR85ZZ 5x8x2.5 (2)
96 0025 NUT M2.5 (10)



930508
BB 5x8x2.5



930120
B 2.4



960025
SH M3x6



908275
SCH M2.5x25



930128
BA 2.8x6.5

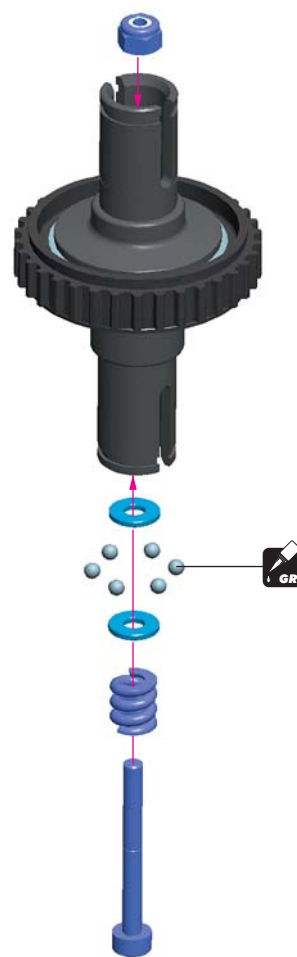
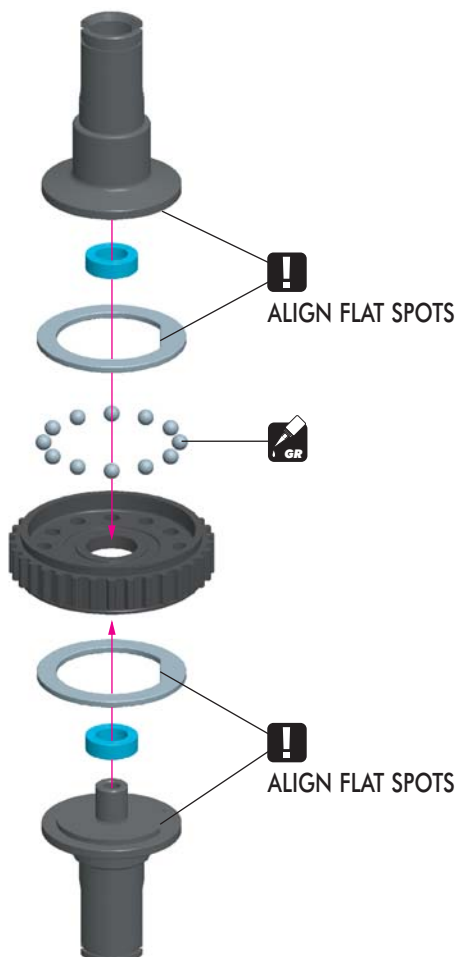

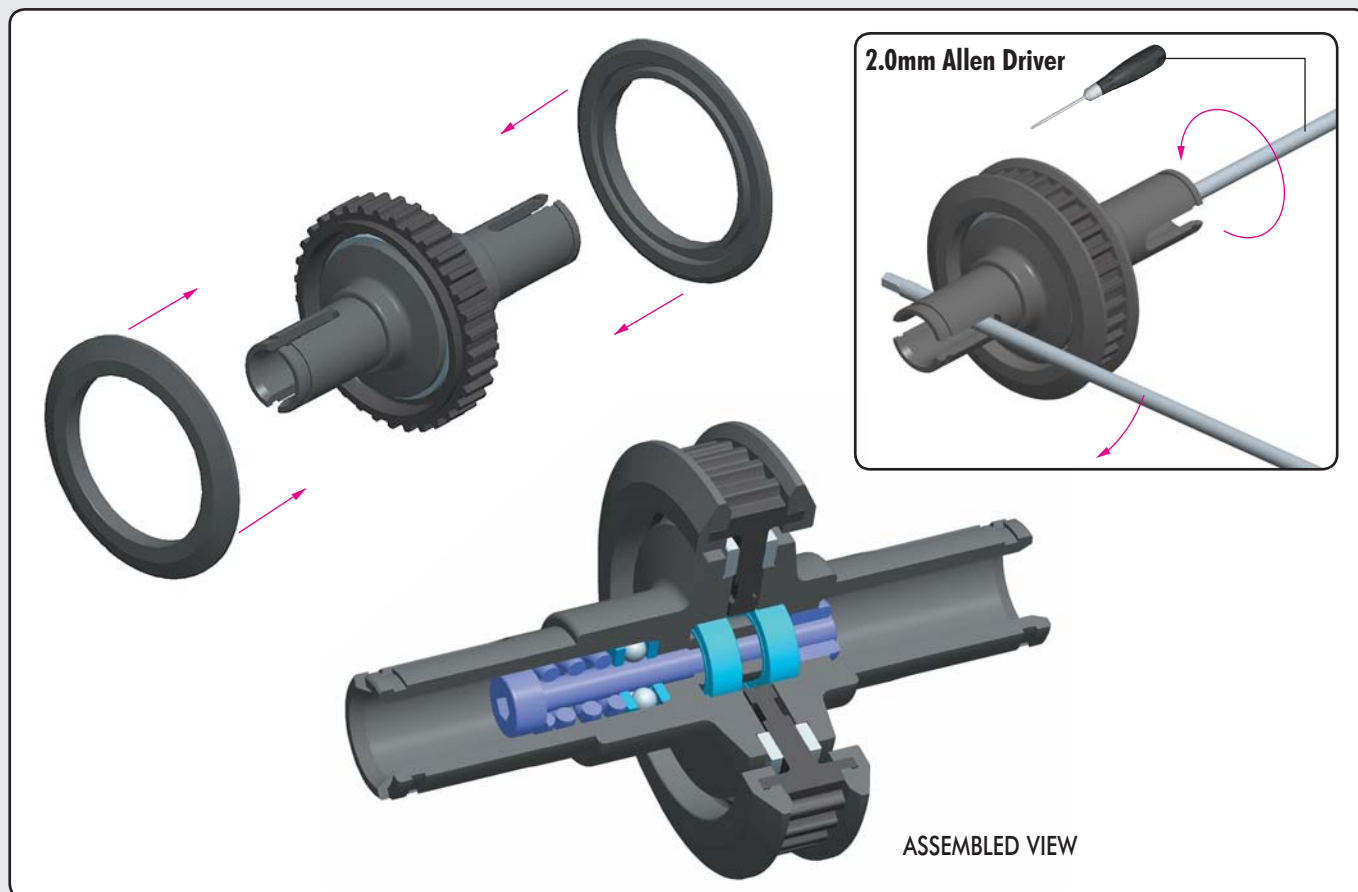

3. CENTRAL TRANSMISSION

PAGE 13

STEP 2



902306
SH M3x6



903308
SFH M3x8

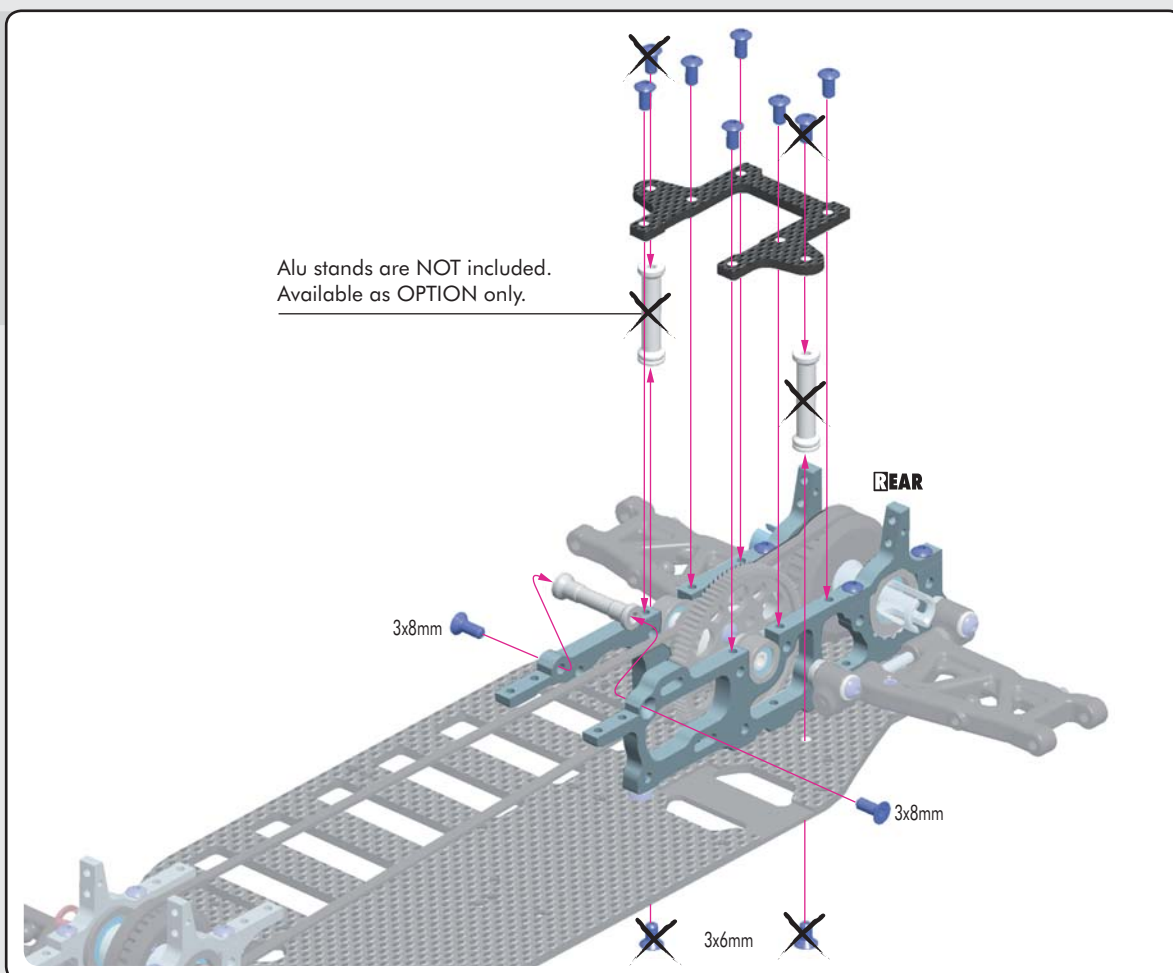

4. FRONT & REAR TRANSMISSION

PAGE 15

STEP 2~3



981210
P 2x12

2x

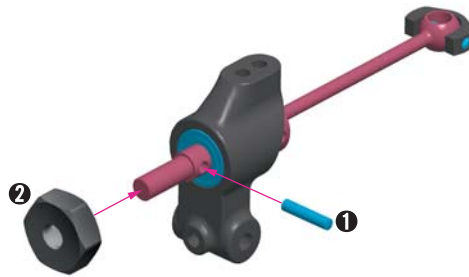

COMPLETE ASSEMBLY

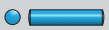

981210
P 2x12

2x



COMPLETE ASSEMBLY

L-R

5. STEERING

PAGE 19

STEP 2

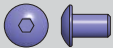

902305
SH M3x5



902306
SH M3x6



930407
BB 4x7x2.5

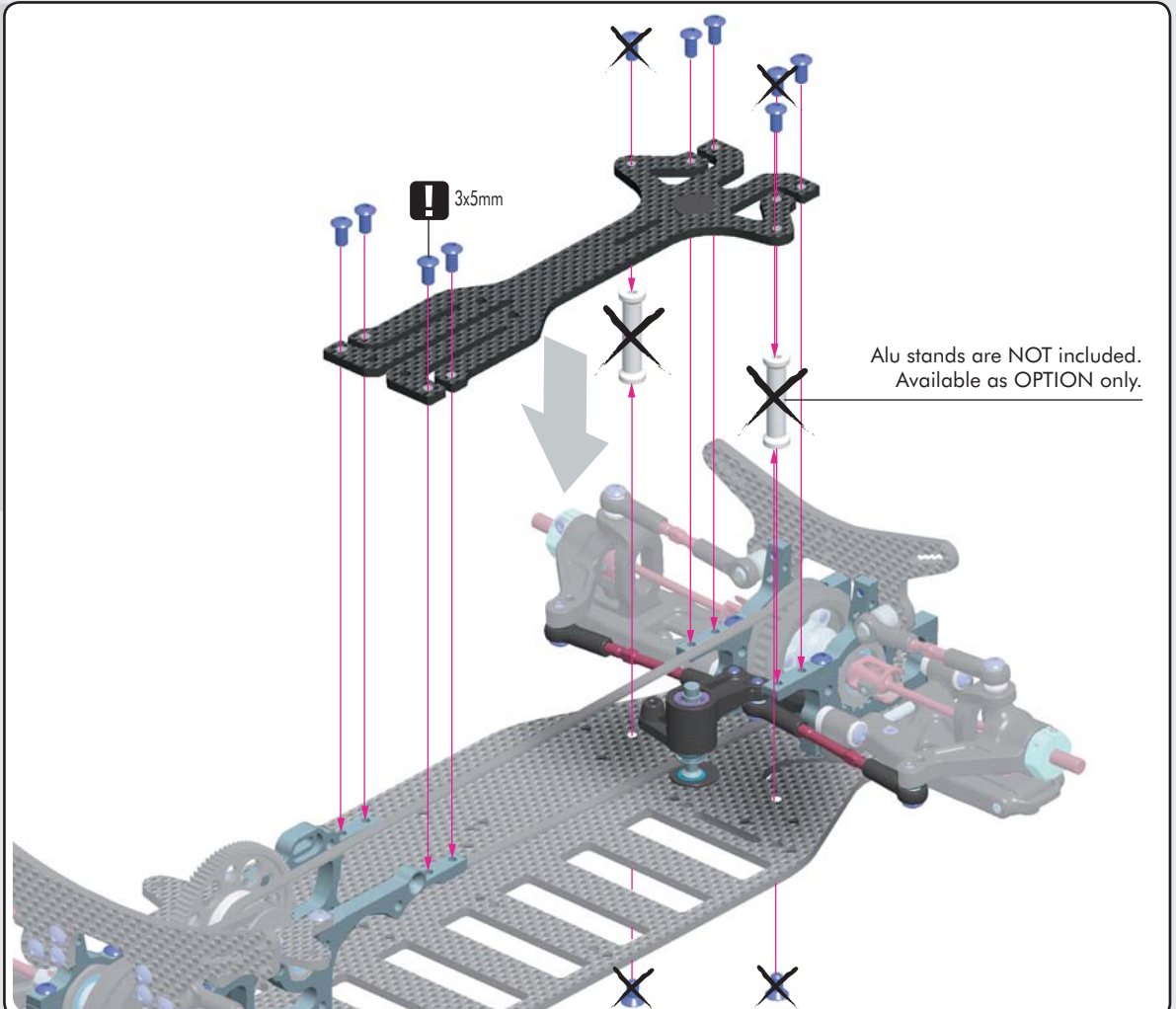

8. FINAL ASSEMBLY

PAGE 27

STEP 1~2

WHEELS & TIRES NOT INCLUDED

4x

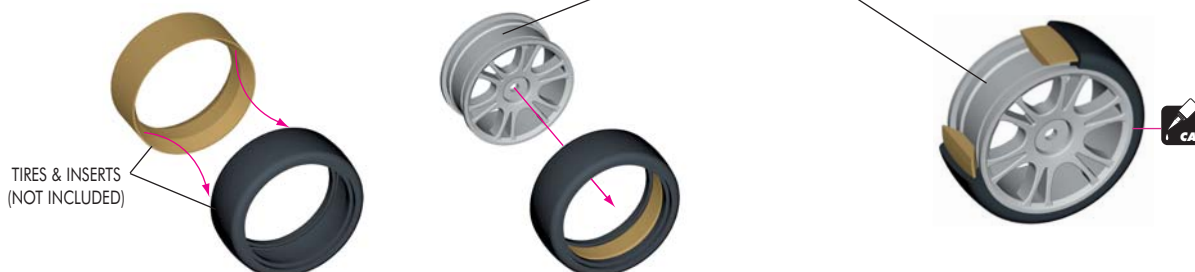

WARNING!

Follow the adhesive manufacturer's instructions for proper use and safety. Wear proper eye and hand protection.



960140
N M4

DETAIL

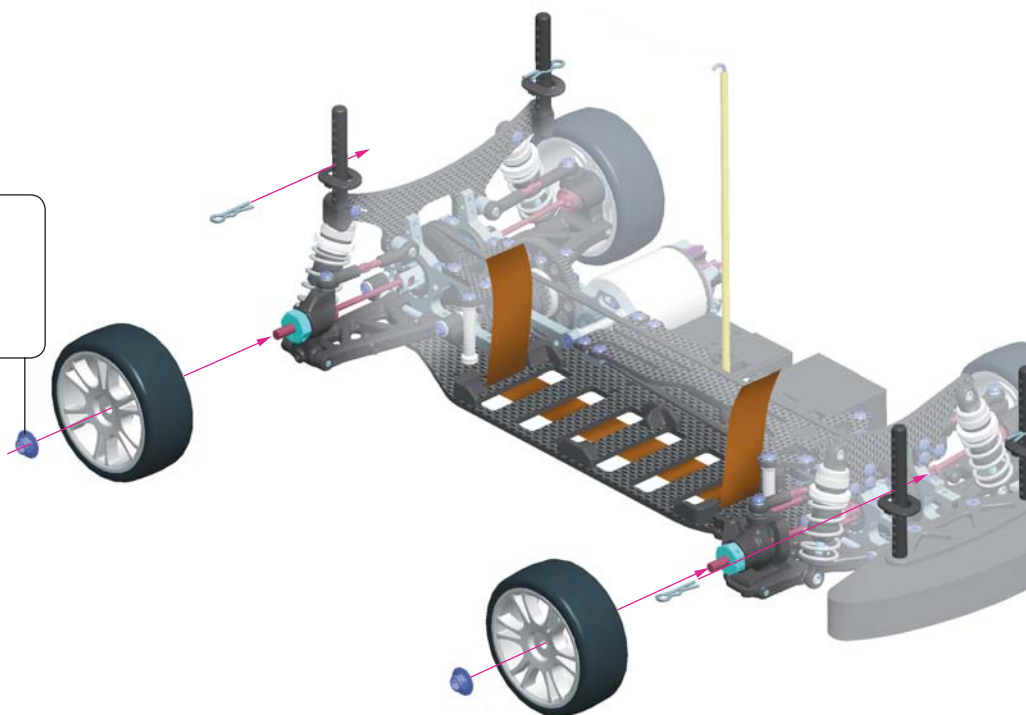

SET-UP SHEET

XRAY T2R

RACE			
TRACK			
NAME			
CITY / COUNTRY			
CONTACT			

DATE		TEMPERATURE / °F or °C	AIR	TRACK
-------------	--	------------------------	-----	-------

QUALIFYING POSITION	BEST LAPTIME / sec	FINAL POSITION	RACE LENGTH / minutes
---------------------	--------------------	----------------	-----------------------

TRACK CONDITION	<input type="checkbox"/> CARPET	<input type="checkbox"/> ASPHALT
<input type="checkbox"/> TECHNICAL	<input type="checkbox"/> MIXED	<input type="checkbox"/> FAST
TRACTION	<input type="checkbox"/> LOW	<input type="checkbox"/> MEDIUM
	<input type="checkbox"/> HIGH	

FRONT	REAR
TRANSMISSION	
DIFFERENTIAL	
<input type="checkbox"/> LOOSE <input type="checkbox"/> MEDIUM <input type="checkbox"/> TIGHT	<input type="checkbox"/> LOOSE <input type="checkbox"/> MEDIUM <input type="checkbox"/> TIGHT

ONE WAY DIFFERENTIAL	<input type="checkbox"/> YES	MIDDLE ONE WAY PULLEY
SOLID ONE WAY DIFF.	<input type="checkbox"/> YES	FIXED <input type="checkbox"/> ONE-WAY <input type="checkbox"/>
SOLID AXLE	<input type="checkbox"/> YES	

PINION / T		SPUR GEAR / T	
FINAL DRIVE RATIO		ROLLOUT	

FRONT	REAR
<input type="checkbox"/> ALU	<input type="checkbox"/> PLASTIC
SHOCKS	<input type="checkbox"/> ALU
<input type="checkbox"/> PLASTIC	
XRAY SPRINGS	
#308393 Super Soft	<input type="checkbox"/> YELLOW (D=1.4) 14 lb
#308384	<input type="checkbox"/> BLUE-GREEN (D=1.5) 15 lb
#308394 Soft	<input type="checkbox"/> WHITE (D=1.5) 17.5 lb
#308385	<input type="checkbox"/> LIGHT-BLUE (D=1.6) 20 lb
#308395 Soft Medium	<input type="checkbox"/> BLUE (D=1.6) 22.5 lb
#308386	<input type="checkbox"/> DARK-BLUE (D=1.7) 25 lb
#308396 Medium	<input type="checkbox"/> VIOLET (D=1.7) 28 lb
#308387	<input type="checkbox"/> LIGHT-PURPLE (D=1.8) 30 lb
#308397 Medium Hard	<input type="checkbox"/> PURPLE (D=1.8) 33 lb
#308388	<input type="checkbox"/> LIGHT-RED (D=1.9) 35 lb
#308398 Hard	<input type="checkbox"/> RED (D=1.9) 38 lb

OTHER SPRING	
OIL / W	
LENGTH / mm	
PRELOAD / mm	
REBOUND %	
<input type="checkbox"/> YES	<input type="checkbox"/> NO
<input type="checkbox"/> YES	<input type="checkbox"/> NO
FOAM INSERTS	<input type="checkbox"/> YES <input type="checkbox"/> NO
O-RING ON SHAFT	<input type="checkbox"/> YES <input type="checkbox"/> NO

<input type="radio"/> OPENED	<input type="radio"/> CLOSED
HOLES IN PISTON	

ANTI-ROLL BAR
THICKNESS / mm

TIRES
DIAMETER / mm
INSERTS
ADDITIVE

FRONT LEFT	FRONT RIGHT	TREATED AREA	REAR LEFT	REAR RIGHT
------------	-------------	--------------	-----------	------------

WHEELS
S <input type="checkbox"/> M <input type="checkbox"/> H <input type="checkbox"/>
HARDNESS

MOTOR	ARMATURE	TIMING
	+ SPRING -	
	+ BRUSH FACE -	
	+ BRUSH COMP -	

ESC	BATTERIES
BODY	WING

COMMENTS

● ☒ - APPLIED S-SOFT M-MEDIUM H-HARD

FRONT	CASTER 0° <input type="checkbox"/> 2° <input type="checkbox"/> 4° <input type="checkbox"/> 6° <input type="checkbox"/>	SQUAT	ROLL-CENTER	REAR
DIVE	ROLL-CENTER	SHIM / mm		
+0.75 <input type="checkbox"/>	+0.75 <input type="checkbox"/>		+0.75 <input type="checkbox"/>	+0.75 <input type="checkbox"/>
0.00 <input type="checkbox"/>	0.00 <input type="checkbox"/>		0.00 <input type="checkbox"/>	0.00 <input type="checkbox"/>
-0.75 <input type="checkbox"/>	-0.75 <input type="checkbox"/>		-0.75 <input type="checkbox"/>	-0.75 <input type="checkbox"/>
WHEELBASE / mm		WHEELBASE / mm		
RIDE HEIGHT / mm		RIDE HEIGHT / mm		

C-HUB	SHIM / mm	UPPER SHOCK POSITION	SHIM / mm	REAR HUB
STANDARD <input type="checkbox"/>				PLASTIC <input type="checkbox"/>
ALU <input type="checkbox"/>				ALU <input type="checkbox"/>
STEERING BLOCK				OFFSET
PLASTIC <input type="checkbox"/>				STANDARD <input type="checkbox"/>
ALU <input type="checkbox"/>				
OFFSET				
STANDARD <input type="checkbox"/>				

FRONT	TOE / degr.	FINAL TOE IN	OUTBOARD TOE	REAR
INBOARD TOE				INBOARD TOE
SHIM / mm				SHIM / mm
SHIM FRONT/REAR				SHIM FRONT/REAR
1.5 mm <input type="checkbox"/>				1.5 mm <input type="checkbox"/>
NO shim <input type="checkbox"/>				NO shim <input type="checkbox"/>
OTHER <input type="checkbox"/>				OTHER <input type="checkbox"/>

FRONT	CAMBER / degr.	REAR
CAMBER		CAMBER
CAMBER		CAMBER

TOP DECK MULTI-FLEX SETTING	
ALU BRACE YES <input type="checkbox"/> NO <input type="checkbox"/>	
FRONT	REAR
FRONT	REAR

CHASSIS MULTI-FLEX SETTING
BULKHEAD SHIM
FRONT ALU STAND
REAR ALU STAND