

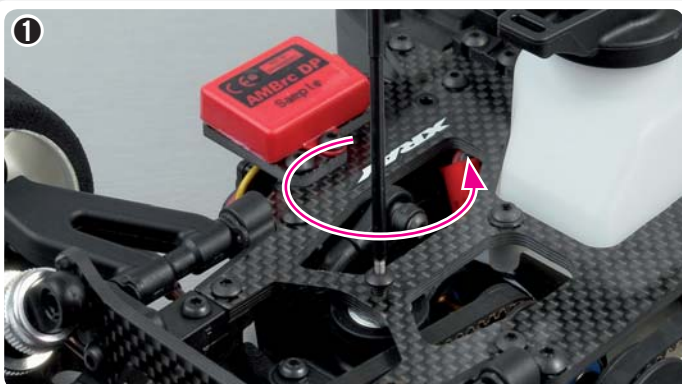

## MIDDLE BODY POST MOUNTING

In addition to driving skill and high-performance, a well-prepared car is vital to achieving great results not only at club races but also at international races. All top racers use a middle body post to help keep the body secured to the car, thus increasing stability, traction, downforce, and steering. The middle body post also helps to prevent body deformation during refueling.

Follow these simple steps to mount the middle body post.



On the upper deck, remove the screw which is connected to the servo saver shaft.

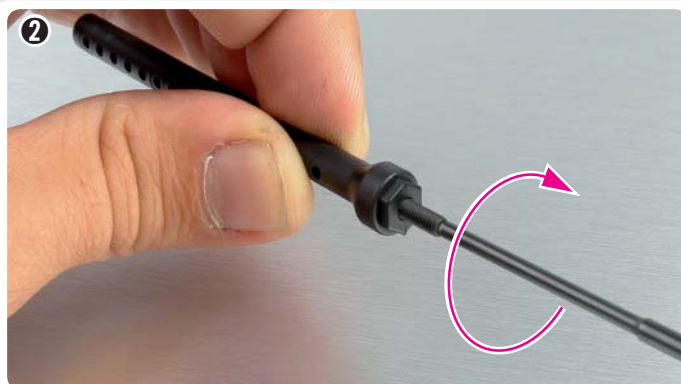

Use a front body post as a middle body post. Screw a SB M3x10 setscrew half way into the body post.

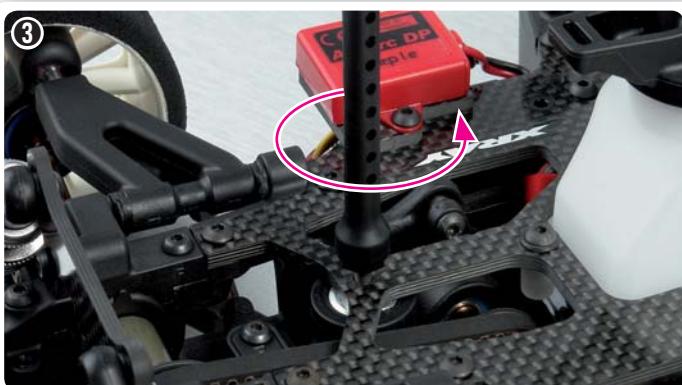

Screw the body post screw into the top of the servo saver. Tighten securely but be careful of stripping the plastic.

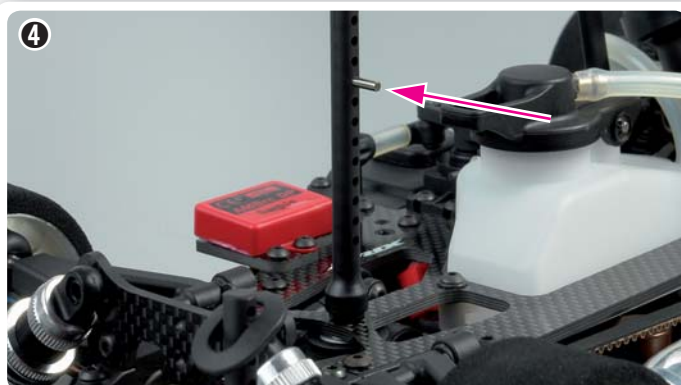

Find the best position for the mounting pin; the position depends on the body used. It is important to select a position that is BELOW the window.

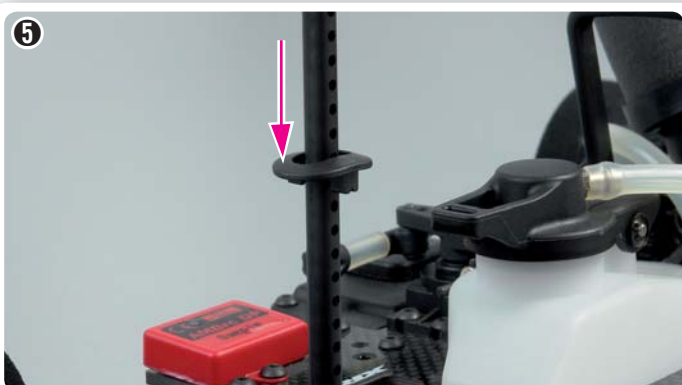

Press the body mount onto the pin until it snaps into place.



Find the place where the body post should go through the body and make the hole in the body. Check that the distance between the body mount and body window is correct. If the body mount is too low, the body will deform at that point; if the body mount is too high, it will push up against the body. You can easily adjust the body mount height by pin location.



After the body post is set correctly, cut off any excess post. Remember to leave a hole for inserting the body clip.



Insert the body clip. The middle body post is ready!