

#353357 ALU ADJUSTABLE REAR HUB CARRIER

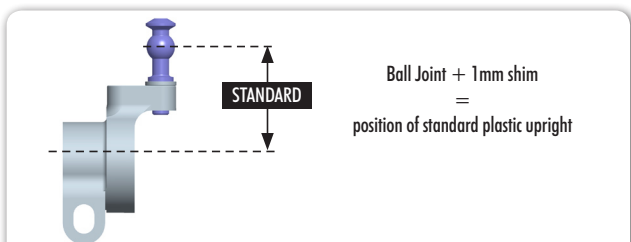
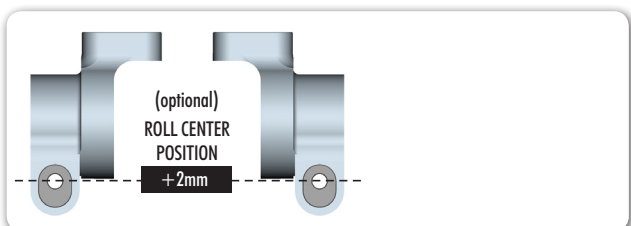
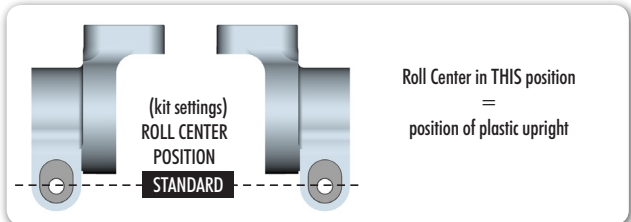
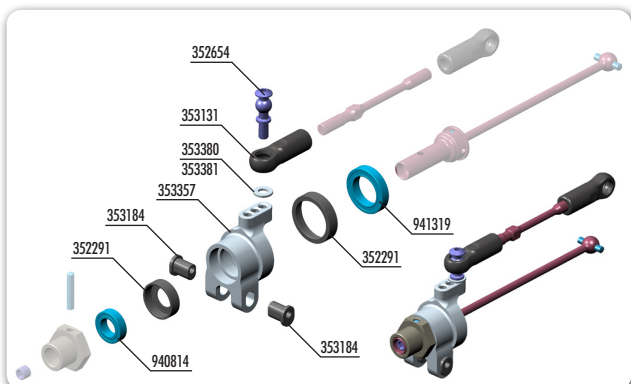

By adding or removing shims under the ball, upper roll center position is changing.

MORE shims = higher roll center = more rear traction, more car roll. Recommended for low-traction conditions and dusty tracks

LESS shims = lower roll center = less traction, but greater steering responsiveness and less roll. Recommended for high-grip tracks.

NOTE: Maximum thickness of shims is 5mm. Do not exceed 5mm of shims because there will be not enough thread for ball, and the ball may fall out.

