

By adding or removing shims under the ball, upper roll center position is changing.

MORE shims = higher roll center = more rear traction, more car roll. Recommended for low-traction conditions and dusty tracks

LESS shims = lower roll center = less traction, but greater steering responsiveness and less roll. Recommended for high-grip tracks.

NOTE: Maximum thickness of shims is 5mm. Do not exceed 5mm of shims because there will be not enough thread for ball, and the ball may fall out.

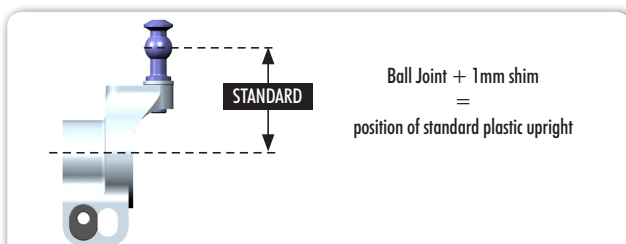
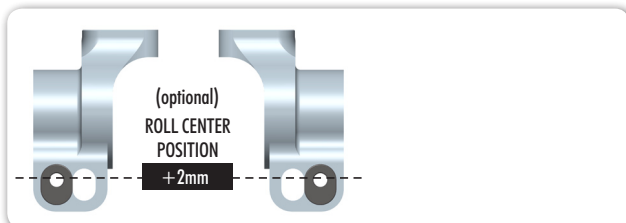
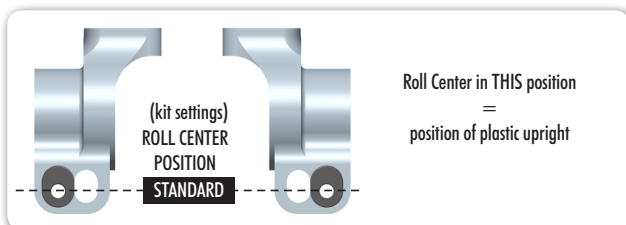
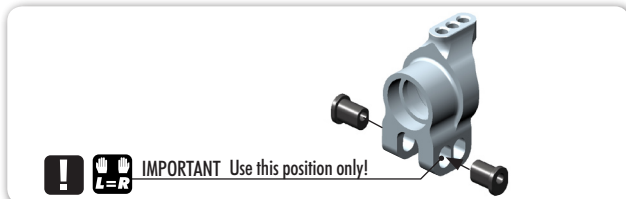
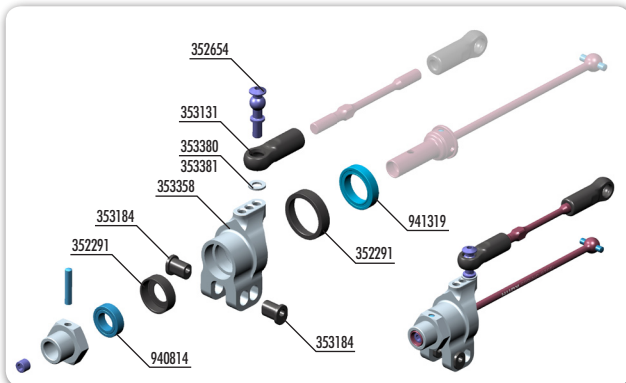
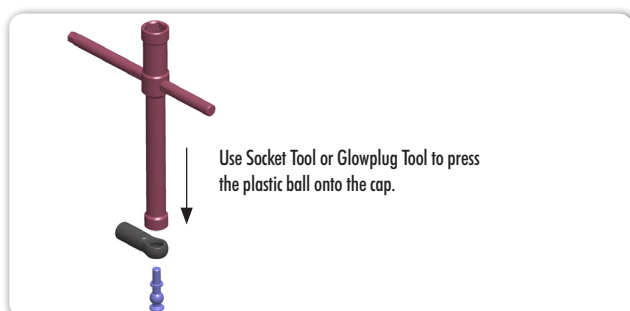

By adding or removing shims under the ball, upper roll center position is changing.

MORE shims = higher roll center = more rear traction, more car roll. Recommended for low-traction conditions and dusty tracks

LESS shims = lower roll center = less traction, but greater steering responsiveness and less roll. Recommended for high-grip tracks.

NOTE: Maximum thickness of shims is 5mm. Do not exceed 5mm of shims because there will be not enough thread for ball, and the ball may fall out.

