

XRAY NT1

INSTRUCTION MANUAL SUPPLEMENTARY SHEET

Use this NT1 PRO Supplementary Instruction Sheet along with the standard NT1 Instruction Manual and NT1 2012 Supplementary Instruction Sheet included in the kit. Note that there is a separate instruction manual for the building aluminum shock absorbers.

New and Improved Parts

All of these parts are new or updated from the previous versions. Each part features its corresponding part number which can be used to for re-ordering.

Please note that this kit does not include a turnbuckle tool. We recommend that you purchase the #181030 HUDY Turnbuckle Tool 3mm.

NT1 PRO SPEC



#338502
XCA (XRAY Centrifugal-Axial) Clutch Set - Reverse



#335511
2-Speed Shaft - Lightweight



#335711
Front Middle Shaft - HUDY Spring SteelT - Lightweight



#335073
Lightweight Diff. Outdrive Adapter Long
HUDY Spring Steel (2)



#335072
Lightweight Diff. Outdrive Adapter
HUDY Spring SteelT (2)



#334141
Alu Lightweight Brake Disk Adapter - Swiss 7075 T6



#335521
Alu Lightweight Carrier for 2-Speed Gear (2nd)
7075 T6 - V2



#335531
Alu Lightweight Drive Flange W/One-Way Bearing
Swiss 7075 T6

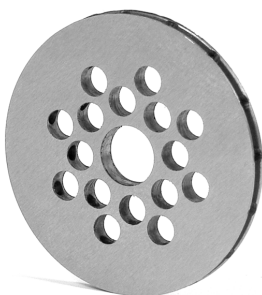

#334111
Lightweight Ventilated Brake Disc - Hardened



#334131
Glued Brake Pad Set - Ultra-Efficient (2)



#335081
Alu Differential Pin - Hard Coated (2)

The new XRAY XCA Clutch Set includes re-designed components which make the clutch lighter and more consistent, leading to more dynamic clutch engagement suitable for most racing conditions. The set includes a super-light flywheel, new clutch disk, and conical washer spring set. All components were designed and long-term tested by factory racing team. Pinion gears are NOT included.

Due to the new clutch design, flywheel is much lighter which provides smoother and faster acceleration. With the conical washer spring set, the clutch works more consistently than when using the standard spring which deforms over time and needs retightening. This new conical clutch washer spring set allows the clutch to retain its setting for a very long time without needing re-adjustment.

PARTS INCLUDED:

- #338513 Clutchbell - High-Dynamic - HUDY Steel
- #338533 Flywheel - Flat - Swiss 7075 T6 - Hard Coated
- #338556 Flywheel Nut - HUDY Spring Steel™
- #338556 Clutchbell Bushing - Hudy Spring Steel™
- #338561 Clutch Flyweight - High-Dynamic - Black (3)
- #338572 Alu Clutch Disk - Conical - Swiss 7075 T6
- #338577 Clutch Shoe - High Dynamic - Yellow
- #338583 XRAY NT1 Conical Clutch Washer Spring - Set
- #338584 Shim 5x7x0.2 (10)
- #338585 Shim 5x7x0.3 (10)
- #338586 Shim 5x7x0.5 (10)
- #338590 Clutch Spring Cup - Alu 7075 T6
- #338594 Clutch Preload Adj. Nut - HUDY Spring Steel™
- #359050 Clutchbell Ball-bearing MR105ZZ 5x10x4 (2)
- #908316 Hex Screw Socket Head Cap M3x16 (10)
- #930150 Carbide Ball-bearing Axial F5-10 5x10x4 with Groove
- #940508 High-Speed Ball-bearing 5x8x2.5 Rubber-sealed (2)
- #964073 Washer S 7x10x0.2 (10)
- #964074 Washer S 7x10x0.3 (10)
- #964075 Washer S 7x10x0.5 (10)

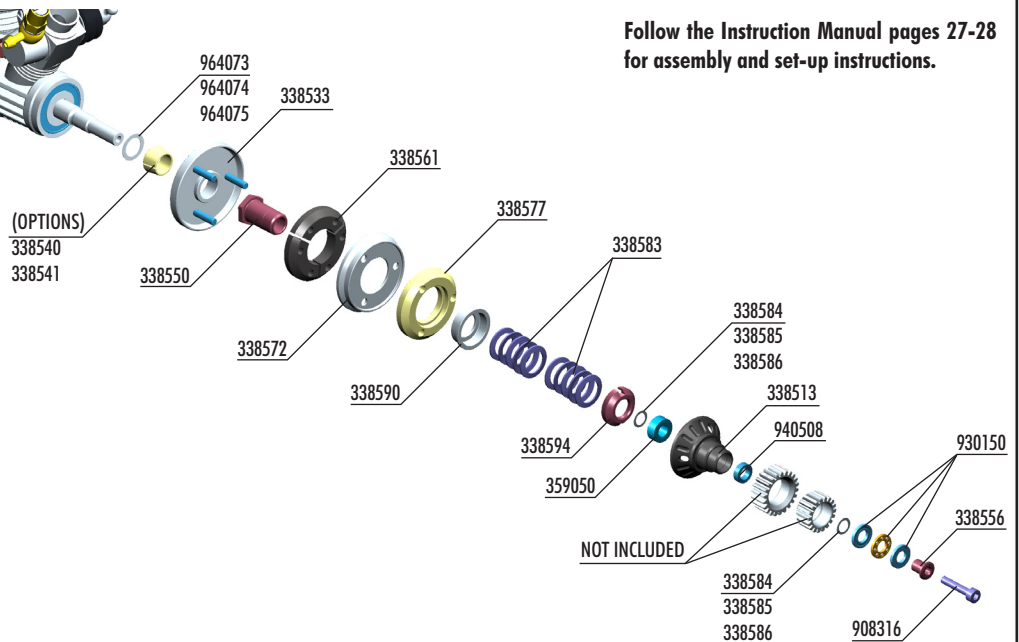

Follow the Instruction Manual pages 27-28 for assembly and set-up instructions.

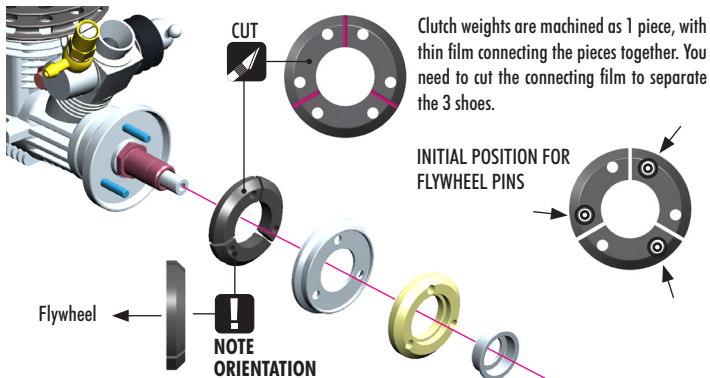

TECH TIP FOR EXTRA BOTTOM POWER

For extra bottom power, thread a M3x4 setscrew (#901304) into each clutch flyweight as shown. The setscrew will add more weight to the end of the flyweight which will cause the flyweight to open harder, giving more bottom power. This is recommended for high-traction tracks where bottom power is required.

IMPORTANT!

Install setscrew into free (non-pivot) end of flyweight.

3x

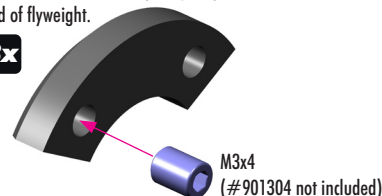

CUTAWAY VIEW

