

#30 0900 NYLON C-HUB SUSPENSION OPTION SET

FRONT SUSPENSION

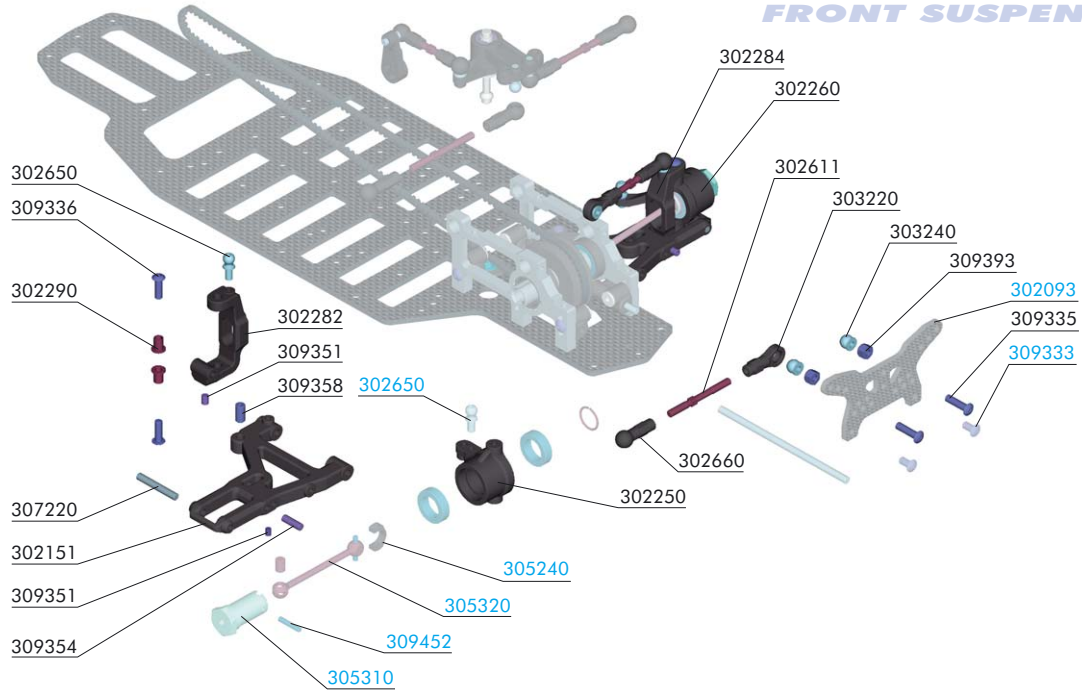

BAG #300900

30 2093	ULTRA-TUNE SHOCK TOWER FRONT - GRAPHITE	30 5240	DRIVE SHAFT REPLACEMENT PLASTIC CAP 3 MM (4)
30 2151	SUSPENSION ARM - FRONT LOWER - C-HUB - MEDIUM	30 5310	WHEEL AXLE - 22 MM - INTEGR. HEX HUB - HARD COATED (2)
30 2250	NYLON STEERING BLOCK RIGHT FOR C-HUB SUSP.	30 5320	DRIVE SHAFT - 51 MM - SPRING STEEL (2)
30 2260	NYLON STEERING BLOCK LEFT FOR C-HUB SUSP.	30 7220	FRONT PIVOT PIN FOR C-HUB (2)
30 2282	NYLON C-HUB FRONT BLOCK, RIGHT - MEDIUM - CASTER 3°	30 9333	HEX SCREW SH M3x6 (10)
30 2284	NYLON C-HUB FRONT BLOCK, LEFT - MEDIUM - CASTER 3°	30 9335	HEX SCREW SH M3x10 (10)
30 2290	C-HUB BUSHING (4)	30 9336	HEX SCREW SH M3x12 (10)
30 2611	ADJ. STEERING ROD L/R 35 MM - SPRING STEEL (2)	30 9351	HEX SCREW SB M3x4 (10)
30 2650	5 MM BALL END, WITH THREAD (6)	30 9354	HEX SCREW SB M3x8 (10)
30 2660	BALL JOINT 5 MM (6)	30 9358	HEX SCREW SB M4x8 (10)
30 3220	BALL JOINT 5.8 MM (4)	30 9393	NUT M3 (10)
30 3240	BALL UNIVERSAL 5.8 MM HEX (4+4)	30 9452	PIN 2x10 (10)
30 2150	SUSPENSION ARM - FRONT LOWER - C-HUB - SOFT (OPTION)	30 2277	ALU C-HUB FOR STEERING BLOCK LEFT - CASTER 3° (OPTION)
30 2255	ALU STEERING BLOCK RIGHT FOR C-HUB SUSP. (OPTION)	30 2278	ALU C-HUB FOR STEERING BLOCK RIGHT - CASTER 6° (OPTION)
30 2265	ALU STEERING BLOCK LEFT FOR C-HUB SUSP. (OPTION)	30 2279	ALU C-HUB FOR STEERING BLOCK LEFT - CASTER 6° (OPTION)
30 2275	ALU C-HUB FOR STEERING BLOCK - CASTER 0° (OPTION)	30 2286	NYLON C-HUB FRONT BLOCK, RIGHT - MEDIUM - CASTER 6° (OPTION)
30 2276	ALU C-HUB FOR STEERING BLOCK RIGHT - CASTER 3° (OPTION)	30 2288	NYLON C-HUB FRONT BLOCK, LEFT - MEDIUM - CASTER 6° (OPTION)

The new optional C-hub suspension is a great new tuning option to set up your T1 for different racing conditions. Before you mount the new C-hub suspension, dismount the entire front suspension on the car, but keep the front bulkheads mounted on the chassis.



1. Thread a #309358 (SB M4x8) downstop adjustment screw into the front lower arm. It must protrude 2.0 mm below the arm. This screw needs to be accessible from the top of the arm.
2. Thread a #309351 (SB M3x4) pivot pin set screw into the arm. Thread it just enough so it will stay in the hole; don't let it thread into the pivot pin area.
3. Thread a #309354 (SB M3x8) shock mounting screw into the hole located at the front outside of the arm. It must protrude 3.0 mm.

Repeat for the other arm, making sure to mirror the screw placement.

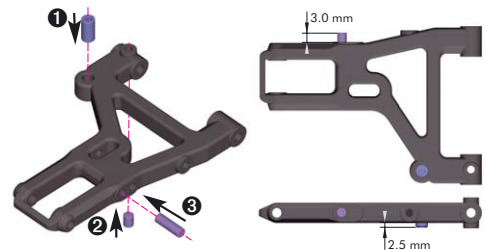

1. Use the coupling from dismantled front suspension, lightly grease it and insert it into the drive shaft joint.
2. Slide the drive shaft joint into the #305310 wheel axle, aligning the cross holes.
3. Insert a #309452 cross pin (P 2x10) through the aligned holes in the coupling and wheel axle. Make sure it is evenly spaced on both sides of the wheel axle.
4. Install a #305240 plastic cap onto the drive shaft pins. First insert one hole of the plastic cap over a pin, then stretch the other hole over the other pin.

Repeat for the other axle.

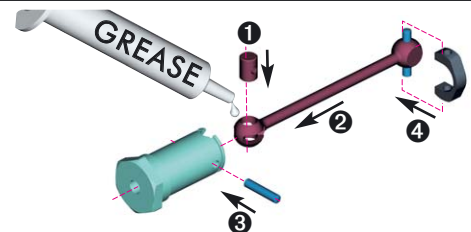

1. Remove the steering rod ball end from the dismantled front steering block.
2. Thread the ball end to the top of the steering arm in the hole further from the block.

Repeat for the other side.

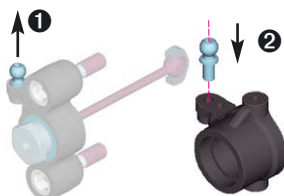

Assemble the front turnbuckles by threading ball joints onto the ends of the spring steel turnbuckles as shown.

Note: The turnbuckle has a CCW thread on one end and a CW thread on the other end. Adjust the turnbuckles to a length of 57.5mm, measured end-to-end.



#30 0900 NYLON C-HUB SUSPENSION OPTION SET



309054
BB 10x15



309425
C 10

1. Slide a #309054 (BB 10x15) ball-bearing onto the wheel axle.
2. Insert the wheel axle into the steering block until the bearing seats in the steering block. Note the direction of installation from the diagram.
3. Slide another #309054 (BB 10x15) ball-bearing onto the wheel axle. Press the bearing into the steering block, making sure it seats properly in the steering block.
4. Fasten the wheel axle to the steering block by installing a snap ring in the groove in the wheel axle (near the drive shaft joint). To make installation easier, place the hex portion of the wheel axle flat on a table. Put one end of the snap ring into the groove on the opposite side of the wheel axle cutout, and use a slotted screwdriver to work the rest of the clip into the groove.

Repeat for the other side.

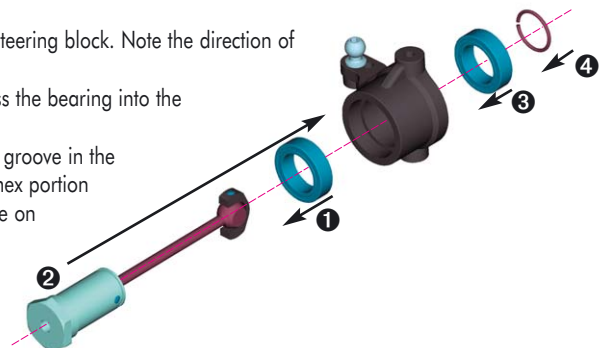

309336
SH M3x12



309351
SB M3x4

1. Thread a #302650 ball end into the top of the C-hub.
2. Insert two #302290 bushings into the C-hub upper and lower holes. Install the bushings from the inside of the C-hub as shown, with the flanges facing into the C-hub.
3. Insert the steering block assembly into the C-hub. Pass the driveshaft through the oblong hole in the side of the C-hub. Insert the left assembly into C-hub marked L, and the right assembly into C-hub marked R.
4. Pass two #309336 screws (SH M3x12) through the bushings, and thread into the top and bottom of the steering block.
5. Thread a #309351 screw (SB M3x4) into the bottom of the C-hub. Do not tighten fully.

Repeat for the other side.

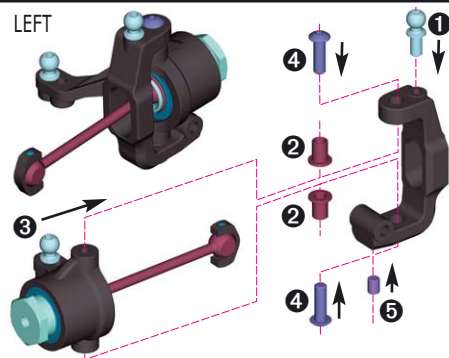

309333
SH M3x6



309335
SH M3x10



309393
N M3

1. Mount two #309393 M3 nuts to the rear of the #302093 front shock tower using two #309335 (SH M3x10) hex screws, using the middle holes as shown. Mount two #303240 balls to the rear of the shock tower on the already mounted hex screws, against the M3 nuts.
2. Mount the front shock tower to the bulkheads using two #309333 (SH M3x6) hex screws.
3. Insert the assembled C-hub steering block into the arm. Align the hole in the bottom of the C-hub and holes in the arm.
4. Slide a #307220 pivot pin through the aligned holes. The flat spot on the pivot pin must be towards the bottom. Tighten the #309351 screw (SB M3x4) until it is tight on the pivot pin. The steering block assembly should move freely.
5. Position the front suspension assembly in the front bulkhead. It should seat between the two plastic lower suspension holders. The pivot pin set screws should be accessible from the large access holes underneath the chassis. Place the driveshaft plastic cap into the diff outdrive slots.
6. Align the holes in the arms with the suspension holders and slide a #307212 lower front pivot pin through the aligned holes. The flat spot on the pivot pin must be towards the rear and facing the bottom.
7. Tighten the #309351 pivot pin set screw (SB M3x4) in the lower arm onto the flat spot on the pivot pin.

Repeat for the other side.

Check the arms for free movement.

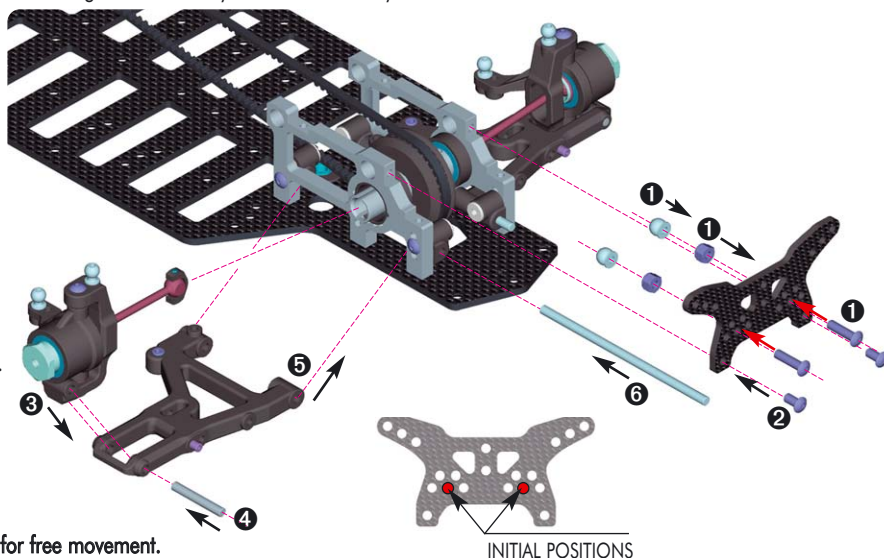

Snap the turnbuckle ball joints onto the balls on the steering blocks and the balls on the shock tower. The suspension arms must be able to fall freely when lifted up then dropped. If there is any binding that prevents the arm from falling freely, remove the ball joint from the ball and lightly squeeze the ball joint with a pair of pliers. Remount the ball joint and check the arm movement again. Repeat this process until there is no more binding.

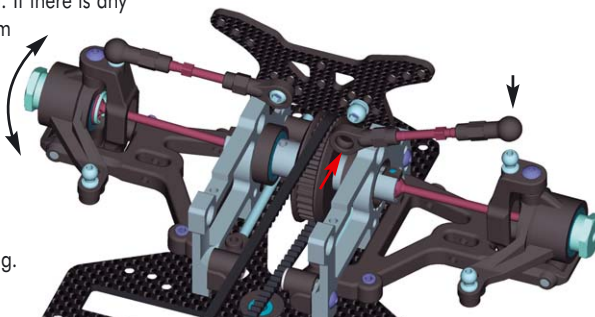

Adjust the steering rods to the proper lengths as shown.

